

Course Schedule

SPRING 2024



OFFICE OF ACADEMIC AFFAIRS

Dear Students,

Essex County College staff and faculty are looking forward to welcoming you back to campus for the Spring Semester. This Spring, the College will host a variety of courses offered at both the **Main Campus** and the **West Caldwell Campus** in the following formats:

- [Traditional face-to-face](#) courses offered within a classroom (sections 001, 003, OAC, etc.)
- [Virtual classes](#) offered on the Zoom platform (sections 02V, 04V, BCV or any section ending in V)
- [Hybrid courses](#) that meet partly face-to-face and partly on Zoom (sections 02H, 04H, BCH, HY1 or any section ending in H)
- Purely [online courses](#) that allow you to work independently to submit assignments by a due date (sections OL1, OW1 or any section starting with the letter O).

In this schedule booklet, virtual courses will be highlighted in **blue**, hybrid courses in **green**, and online courses in **gold**. Face-to-face courses are not highlighted.

Registration is open now for the Spring. You can register through Web Services using this link: <http://myportal.essex.edu> or visit our **Main Campus Welcome Center** at the second level, main entrance for registration or our **One Stop Center at the Caldwell Campus** main entrance. Also, seek out your faculty advisors who are the resident experts in your field of study.

We are confident that you will find courses that will fit into your schedule at Essex. One great College, two great campuses! Take the campus tour here: [Virtual Campus Tour](#)

Our goal is to offer a variety of courses that allow you to continue your educational pursuits.

Best wishes for your academic success.

Sincerely,



Dr. Alvin Williams, Executive Dean of Faculty & Academics

Clickable Table of Contents

OFFICE OF ACADEMIC AFFAIRS.....	ii
IMPORTANT BURSAR PAYMENT DUE DATES:	iv
TUITION DROP & WITHDRAWAL POLICY:	iv
TUITION CHARGEBACK FOR OUT OF COUNTY RESIDENTS:	iv
SAMPLE STUDENT FINANCIAL RESPONSIBILITY AGREEMENT	v
COURSE MATERIAL FEE OPT OUT DATES:	ix
Spring 2024 Calendar	ix
A New Direction in Developmental Courses	xi
Frequently Asked Question about MTH 091S/MTH 101 and MTH 093S/MTH 103	xii
AFFIRMATIVE ACTION POLICY STATEMENT	xiv
Students with Special Needs	xiv
ENROLLMENT IN SINGLE SIGN-ON	xv
“MyECC” Portal	xvi
4-Simple Steps to Advisement & Web Registration	xvii
Where to go for Advisement	xviii
REGISTRATION HOLDS	xix
Are you on track to complete your degree?	xix
DegreeWorks Frequently Asked Questions	xx
How to Register Online.....	xxi
REGISTRATION COMMON ERRORS.....	xxiii
Advisement & In-person Registration.....	xxiv
Enrollment Steps	xxv
DROPPING A CLASS.....	xxvi
WITHDRAWING FROM A CLASS	xxvi
CLASS ATTENDANCE	xxvi
STUDENT E-MAIL ACCOUNT	xxvi
UPDATE YOUR ADDRESS & PHONE NUMBER	xxvii
COURSE CANCELLATION	xxvii
AUDITING A COURSE	xxvii
MANDATED HEALTH INSURANCE	xxvii
IMMUNIZATION REQUIREMENT.....	xxvii
Cross Registration Information for Exchange Students	xxviii
FINANCIAL AID INFORMATION	xxix
TUITION & FEES	xxxi
RESIDENCY DEFINITION	xxxii
TELEPHONE DIRECTORY.....	xxxiii
Section Legend	xxxiv
Winter Intersession Schedule of Classes (Main Campus)	xxxvi
Spring I Schedule of Classes (Main Campus).....	xxxvii
Spring I Schedule of Classes (West Essex Campus)	xxxviii
Spring II Schedule of Classes (Main Campus).....	xxxix
Spring II Schedule of Classes (West Essex Campus)	xl
Spring I Schedule of Classes (Weekend College).....	xli
Spring I Schedule of Classes (FOCUS).....	xlii

IMPORTANT BURSAR PAYMENT DUE DATES:

Winter Intersession 2023:

- Register for *only* Winter Intersession Nov. 13 – December 15 – *full* payment is due by December 15, 2023
- Register for *only* Winter Intersession after December 15, payment is due at time of registration
- Register for Winter Intersession *and* Spring I classes and combine both terms in the Spring I 2024 payment plan.

Spring I 2024 & FOCUS/Ironbound (Three Payment Plan):

- Register November 13 – December 15, payment is due by December 15, 2023
- Register December 15 – January 2, payment is due by January 3, 2024
- Register after January 2, payment is due within 24 hours of registration
- Second payment is due February 6, 2024
- Third payment is due March 6, 2024

Spring II 2024 Second Session (Two Payment Plan):

- Payment is due within 24 hours of registration
- Second payment is due March 6, 2024

Payments can be made through the portal at: [Essex](#)

TUITION DROP & WITHDRAWAL POLICY:

All students who officially withdraw from the college or officially drop a course/s, may receive a tuition refund according the schedule below. Students who withdraw after the listed dates are responsible for the entire bill. Students who have enrolled in the payment plan must arrange to pay any outstanding balance if the recalculation of tuition and fees is larger than the amount already paid. Students must drop course/s by the drop deadline to avoid tuition and fee liability.

PTRM	Description	Start Date	End Date	100% Refund	50% Refund	25% Refund	No Refund
1	Spring I	1/10/24	4/27/24	1/17/24	1/18 - 1/23/24	1/24 -1/29/24	After 1/29/24
I	Ironbound/ FOCUS	1/31/24	4/24/24	2/6/24	2/7 – 2/12/24	2/13 - 2/16/24	After 2/16/24
L	Spring II Second Session	2/12/24	4/24/24	2/20/24	2/21 - 2/26/24	2/27 - 3/1/24	After 3/1/24
W	LPN101/LPN102	1/10/24	3/30/24	1/15/24	1/16 - 1/18/24	1/19 – 1/23/24	After 1/23/24
W1	LPN101/LPN102	4/1/24	6/22/24	4/4/24	4/5 -4/9/24	4/10 – 4/15/24	After 4/15/24
WIN	Winter Intersession	12/26/23	1/09/24	12/27/23	n/a	n/a	After 12/27/23

TUITION CHARGEBACK FOR OUT OF COUNTY RESIDENTS:

Out-of-county residents attending ECC, may be eligible for tuition chargeback assistance from their county in accordance with N.J.S.A. 18A:64A-23, pursuant to the Chargeback Laws of 1968. Out of county residents who are eligible for chargeback assistance must apply for a tuition chargeback at your home County College and home County Treasurer and submit approved chargeback forms to the ECC Bursar's office by: All Spring Semesters – **February 29, 2024**



	<p>Essex County College Student Financial Responsibility Agreement</p>
---	---

PAYMENT OF FEES/PROMISE TO PAY

I fully understand and accept that my authorization to enroll and continue to register for classes at Essex County College is fully conditioned on my acceptance of the terms and conditions set forth in this Student Financial Responsibility Agreement (SFRA). I further understand and agree my registration and acceptance of these terms constitutes a contractual agreement (i.e., a financial obligation in the form of an educational loan as defined by the U.S. Bankruptcy Code at 11 U.S.C. §523(a)(8)) in which Essex County College is providing me educational services, deferring some or all of my payment obligation for those services, and I promise to pay for all assessed tuition, fees, and other associated costs by the published or assigned due date.)

INSTRUCTIONS: Please read and retain this agreement and then sign the separate three-part NCR attestation form to confirm your acceptance of the terms and conditions of this agreement. You may retain the white copy of the NCR form for your records, the yellow copy will be sent to the Bursar's Office and the pink copy will be retained by the academic department.

I understand and agree if I drop or withdraw from some or all of the classes for which I register, I will be responsible for paying all or a portion of tuition and fees in accordance with the published tuition refund schedule at <https://www.essex.edu/bursar-office/>. I understand that I am responsible for payment of all College charges regardless of whether I am an applicant for and/or recipient of any student financial assistance for my enrollment at Essex County College. I understand that I must make payments on my student billing account to keep my account in good standing until all charges are satisfied whether I am an applicant for and/or recipient of student financial assistance for my enrollment at Essex County College.

I have read the terms and conditions of the published tuition refund schedule and understand those terms are incorporated herein by reference. I understand my failure to attend class does not absolve me of my financial responsibility as described herein. Further, I acknowledge that while the College will mail billing statements, billing information is always available on the College's online "myECC" portal, and that I am responsible for all College charges until such charges are completely satisfied by any payment means.

DELINQUENT ACCOUNT/COLLECTION

Financial Hold: I understand and agree if I fail to pay my student account bill or any monies due and owing Essex County College by the scheduled due date, Essex County College will place a financial hold on my student account, preventing me from registering for future classes, obtaining transcripts, or receiving my diploma.

Late Payment Charge: I understand and agree if I fail to pay my student account bill or any monies due and owing Essex County College by the scheduled due date, Essex County College will assess late payment and/or finance charges at the rate of \$100.00 on the past-due portion of my student account until my past-due account is paid in full.

Collection Agency Fees: I understand and accept if I fail to pay my student account bill or any monies due and owing Essex County College by the scheduled due date, and fail to make acceptable payment arrangements to bring my account current, Essex County College may refer

my billing account to a collection agency. I further understand if Essex County College refers my student account balance to a third party for collection, whether an attorney or collection agency, I will be responsible for any costs (including but not limited to collection fees) associated with attempting to collect the monies due and owing. I understand a collection fee will be assessed and will be due and owing in full at the time of the referral to the third party. The collection fees will be calculated at the maximum amount permitted by applicable law but not to exceed the amount outstanding. For purposes of this provision, the third party may be a debt collection company or an attorney. If a lawsuit is filed to recover an outstanding balance, I shall also be responsible for any costs associated with the lawsuit such as court costs or other applicable costs. Finally, I understand that my delinquent account may be reported to one or more of the national credit bureaus.

STUDENT AID DISBURSEMENT

Student aid is disbursed to student billing accounts by the Bursar, and the schedule for this process is available here: <https://www.essex.edu/bursar-office/> (see the link “refunding credit balances”).

I acknowledge that any withdrawal or dismissal prior to the 60% time period of a semester requires the College to review a student’s student aid account for the potential of adjustments to student aid in accordance with federal Student Aid and NJ HESAA requirements and that adjustment may result in a balance due to the College. I acknowledge that information about applicable student aid related “refund” policies are available on the College’s Financial Aid Office website at <https://www.essex.edu/fa>.

I acknowledge that regardless of whether I am an applicant for and/or recipient of student financial assistance, and until such time that any student aid for which I am eligible is disbursed to my student billing account, I am responsible for ensuring that my billing account remains current by making payments on the account while there is a balance due to the College.

CONTACT & ELECTRONIC COMMUNICATION

Email Communication: I understand that Essex County College uses email as an official method of communication with students and that, therefore, I am responsible for reading emails I receive from Essex County College on my College email account on a timely basis. I acknowledge that College personnel will only respond to email inquiry from the student’s College email account, and will only address email inquiry to students via the College email account. I agree and consent to the receipt of electronic communications from the College, defined as email to the student’s College email account and information contained in the student’s ECC’s account.

Telephone Communication: I authorize Essex County College and its agents and contractors to contact me at my current and any future landline number(s), cellphone number(s), email address(es), or wireless device(s) regarding my delinquent student account(s)/loan(s), any other debt I owe to Essex County College, or to receive general College information. I authorize Essex County College and its agents and contractors to use automated telephone dialing equipment, artificial or prerecorded voice or text messages, and personal calls and emails in their efforts to contact me. Furthermore, I understand that I may withdraw my consent to call or text my cellphone using automated telephone dialing equipment by submitting a clear revocation request to Enrollment Services or to the applicable contractor or agent contacting me on behalf of Essex County College

Updating Contact Information: I understand and agree that I am responsible for keeping Essex County College records up to date with my current mailing addresses, email addresses, and phone numbers by following the procedure at <https://webservice1.essex.edu/>. Upon leaving Essex County College for any reason, I acknowledge that it is my responsibility to provide Essex County College

with updated contact information for purposes of continued communication regarding any amounts that remain due and owing to Essex County College.

PRIVACY RIGHTS & RESPONSIBILITIES

I understand Essex County College is bound by the Family Educational Rights and Privacy Act (FERPA), which prohibits Essex County College from releasing any information from my education record without my written permission. I acknowledge the availability of the College's policy on student records, which is available at this website: <https://www.essex.edu/student-records/>.

I understand if I want Essex County College to share information from my education record with someone else, I must provide written permission by filing a written FERPA authorization addressed to the College's Registrar, who is located in the Office of Enrollment Services. I further understand I may revoke my permission at any time as instructed in the same procedure.

INTERNAL REVENUE SERVICE (IRS) FORM 1098-T

I agree to provide my Social Security number (SSN) or taxpayer identification number (TIN) to {Institution Name} upon request as required by IRS regulations for Form 1098-T reporting purposes.

I consent to receive my annual IRS Form 1098-T -Tuition Statement electronically from Essex County College. I understand if I do not consent to receive my Form 1098-T electronically, a paper copy will be provided. I understand I can withdraw this consent or request a paper copy by following the instructions at <https://www.essex.edu/wp-content/uploads/2021/01/1098T-STUDENT-Notification-Revised-1-22-2020.pdf>.

ENTIRE AGREEMENT

This agreement supersedes all prior understandings, representations, negotiations, and correspondence between the student and Essex County College, constitutes the entire agreement between the parties with respect to the matters described, and shall not be modified or affected by any course of dealing or course of performance. This agreement may be modified by Essex County College if the modification is signed by me. Any modification is specifically limited to those policies and/or terms addressed in the modification.

SEVERABILITY CLAUSE

If any provision, term, or clause of this Agreement is declared illegal, unenforceable, or ineffective in a legal forum with competent jurisdiction to do so, this Agreement shall be deemed severable, and all other provisions, terms, and clauses of the Agreement will remain valid and binding on the Parties.



**Essex County College
Student Financial
Responsibility Agreement**

I have read this entire agreement and understand the terms and conditions as outlined.

Student's Signature

Date

School Official Signature

Date

Essex County College Anti-Discrimination Statement

No person shall be subjected to discrimination or harassment on the basis of race, creed, color, nationality, national origin, ancestry, sex, gender identity or expression, affectional or sexual orientation, disability, liability for service in the Armed Forces of the United States. Any Discrimination concern should be brought to the attention of the Chief Compliance Officer/Title IX Coordinator.

Revised: July 2022



COURSE MATERIAL FEE OPT OUT DATES:

- **Winter Intersession 2023:**
 - December 27, 2023
- **Spring 2024 Semesters:**
 - Spring I - January 17, 2024
 - Ironbound/FOCUS – February 6, 2024
 - Spring II Second Session – February 20, 2024
 - PTRM W: LPN 101/ 102 – January 15, 2024
 - PTRM W1: LPN 101/ 102 – April 24, 2024

Spring 2024 Calendar

This calendar is subject to change based on the needs of the College.

First Day of Winter Intersession 2023 Classes (Meeting Dates Dec. 26, 27, 28, 29 and Jan. 2, 3, 4, 5, 8 and 9)		December 23
New Year's Day Holiday	College Closed	January 1 - 2
Last Day to Withdraw from Winter Intersession		December 29
Last Day of Classes for Winter Intersession		January 9
Grades Due to the Registrar (Winter Intersession)		January 10
Registration - Spring I		Nov. 13, 2023 - January 9
Late Registration & Add/Drop - Spring I		January 10 -12
First Day of Spring I Classes (15-Week Term)		January 10
First Day of Weekend Classes		January 12
Martin Luther King Jr. Birthday	College Closed	January 15
Last Day to Declare Course Audit - Spring I		January 17
Registration - Spring II (10 - Week Term)		January 22 - February 11
First Day of Spring II Classes (10-Week Term)		February 12
Late Registration & Add/Drop -Spring II		February 12 - 16
Presidents' Day	College Closed	February 19
Last Day to Declare Course Audit - Spring II		February 20
June 2024 Graduation Degree audit adjustments due to the Registrar		February 28
Last Day for Removal of 'Incomplete' grade for Summer 2023		February 26
Mid-Term Grades Due to the Registrar (Spring 2024)		March 11
Registration for Summer and Fall 2024 Begins		March 11

Last Day to Withdraw from Spring Semester Classes		March 22
WU Grade Reporting Period - Spring Semester		March 25 - April 5
Spring Holiday (Good Friday)	College Closed	March 29
	No Classes	March 30
Last Day of Weekend Classes		April 27
Last Day of Spring II Semester Classes		April 24
Last Day of Spring Semester Classes		April 27
Grades Due to the Registrar (Spring 2024)		May 3



A New Direction in Developmental Courses

There is a new direction in developmental education at Essex County College. If you have tested into any zero level courses, please note the following:

If you placed into ENG 085, ENG 096 or ENG 098 or are repeating any of these:

- Register for the combined **ENG 099+ENG 101** applicable to all majors.

If you placed into MTH 086 or are repeating

- Register for MTH 086 + MTH 086T

If you placed into MTH 092, or are repeating:

- Social Science and Humanities majors
 - Register for either the combined **MTH 091S + MTH 101** or **MTH 093S + MTH 103**
- Business majors
 - Register for either the combined **MTH 091S + MTH 101** or MTH 092/MTH 092T (see your advisor)
- Science, Technology, Engineering and Mathematics majors
 - Register for MTH 092/MTH 092T

If you are registered for any developmental course or a developmental course combined with a college course:

- You are encouraged to take the **FYE 097 First Year Experience** course. FYE 097 course prepares you for the first year of college life and in it, you will learn the necessary skills for college advancement and receive continuous support.

The new approach links together developmental and college level courses. This accelerated approach will allow you to **complete your developmental sequences and get credit for a college course in as little as one semester**. The 09x courses gives you just the extra skills needed to be successful in the college course that counts towards your degree requirements.

The following pages provide additional details about the developmental course sequences and placement.

Frequently Asked Question about MTH 091S/MTH 101 and MTH 093S/MTH 103

- 1. Do all students interested in taking MTH 101 have to take MTH 091S concurrently with MTH 101, and do all students interested in taking MTH 103 have to take MTH 093S concurrently with MTH 103?**

No, not all students have to take MTH 091S concurrently with MTH 101, and not all students have to take MTH 093S concurrently with MTH 103. The students that DO have to take the 09-level concurrent course are those that passed MTH 086 with a grade of C or better, or students that placed at MTH 092. Students that DO NOT have to take the 09-level concurrent course are those that passed MTH 092 with a grade of C or better, or students that placed at the level of MTH 100, MTH 101 or MTH 103.

- 2. What are the course grading options for MTH 091S and MTH 093S?**

MTH 091S and MTH 093S will be graded the same way that the other developmental math courses (MTH 086 and MTH 092) are graded. That is, students may earn passing grades of A, B+, B, C+ or C, and students that do not pass will receive a grade of M (making progress). MTH 091S and MTH 093S are graded independently of the respective concurrent courses of MTH 101 and MTH 103.

- 3. If students pass MTH 091S or MTH 093S, and NOT the respective MTH 101 or MTH 103 course, do students have to repeat both the 09-level and the respective 100-level course?**

No, if students pass MTH 091S or MTH 093S, and NOT the respective MTH 101 or MTH 103 course, then students only have to repeat the 100-level course. The 09-level course DOES NOT have to be repeated.

- 4. If students pass MTH 101 or MTH 103, and NOT the respective MTH 091S or MTH 093S course, do students have to repeat the 09-level course?**

No, if students pass MTH 101 or MTH 103, and NOT the respective MTH 091S or MTH 093S course, then students DO NOT have to repeat the respective 09-level course.

- 5. What math sequence should General Science majors take?**

General Science majors that do not place at the 100-level should take the developmental math sequence that will prepare them for MTH 100. That is, students that place at the MTH 086 level, should take MTH 086, MTH 092 and MTH 100. Students that place at the 092 level, should take MTH 092 and MTH 100. Students that place at the 100-level, can take MTH 100 or MTH 101. The courses MTH 091S and MTH 093S DO NOT prepare students for MTH 100.

Developmental Math Sequences through Gateway Level Math Fall 2020

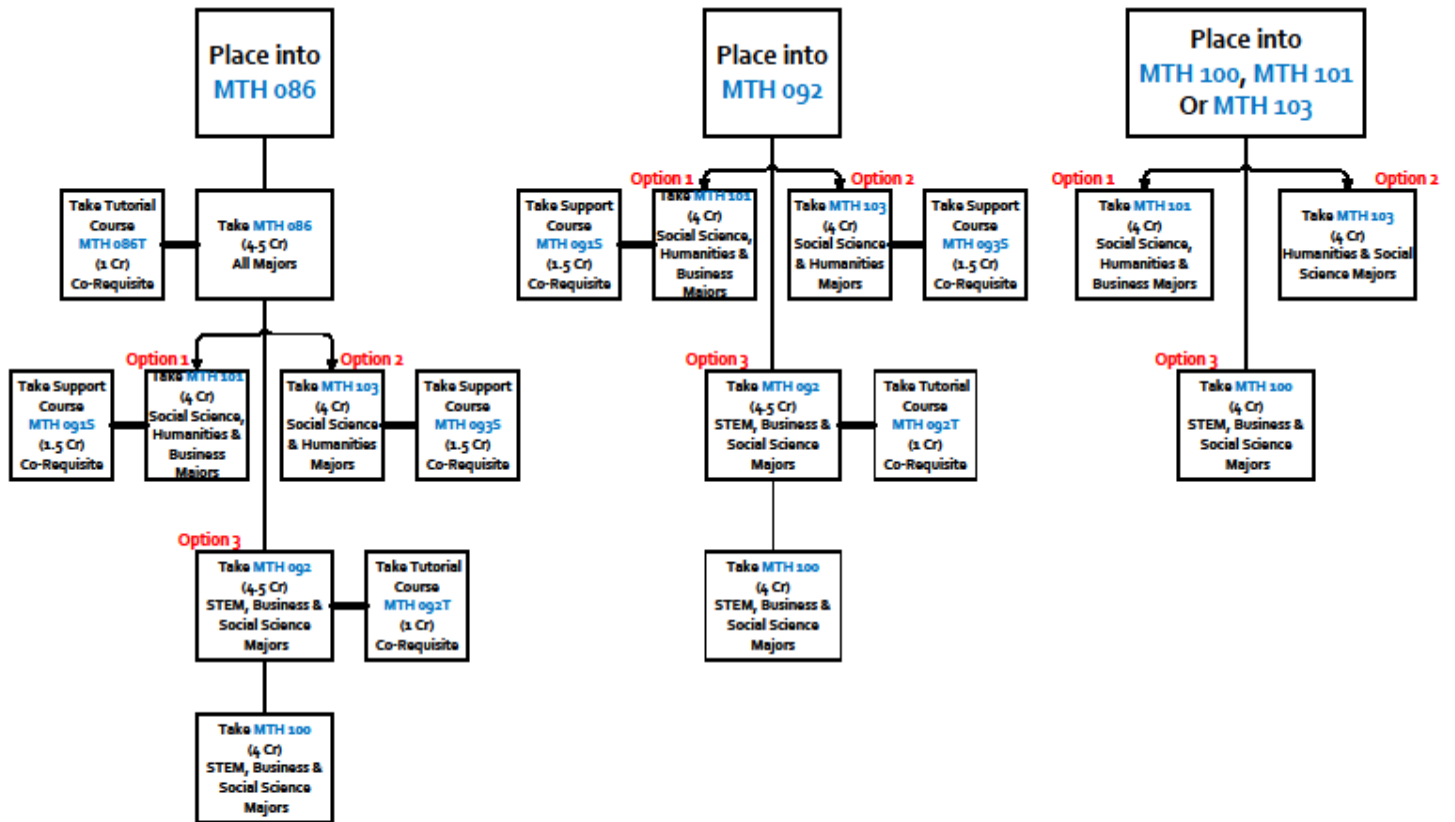

English Placement Cutoff Scores:

The following table explains what scores an incoming student must earn in both their writing and reading portions in order to determine whether they are placed into ENG-099/101 or standalone ENG-101:

Writing (Min.)	Writing (Max.)	Reading (Min.)	Reading (Max.)	Placement
0	0	200	300	Off Topic or ESL
1	5	200	300	ENG-099/101
6	6	200	236	ENG-099/101
6	6	237	300	ENG-101
7	8	200	300	ENG-101



AFFIRMATIVE ACTION POLICY STATEMENT

Non-Discrimination Policy *STATEMENT OF ASSURANCE*

Non-Discrimination Policy

It is the policy of Essex County College not to discriminate on the basis of race, creed, color, national origin, age, marital status, familial status, affectional or sexual orientation, disability, gender identity or expression, genetic information, liability for military service, or any other category protected by applicable law. This policy applies to all terms, conditions, and privileges of student recruitment/ enrollment, staff employment and vocational opportunities.

Further, the College conforms to all federal and state statutes, executive orders, regulations, guidelines and amendments including but not limited to: New Jersey Law Against Discrimination; Title VI & VII of the Civil Rights Act of 1964; Title IX of the Education Amendments of 1972; Section 504 of the Rehabilitation Act of 1973; Age Discrimination Act of 1975; and the Americans With Disabilities Act of 1990.

Section 504 Coordinator
Phyllis Walker
Assistant Director of Financial Aid
303 University Avenue, Newark NJ, 07102

Title IX Coordinator
Karen Bridgett
Associate Director, Human Resources
303 University Avenue, Newark NJ, 07102

Essex County College Anti-Discrimination Statement:

No person shall be subjected to discrimination or harassment on the basis of race, creed, color, nationality, national origin, ancestry, sex, gender identity or expression, affectional or sexual orientation, disability, liability for service in the Armed Forces of the United States. Any Discrimination concern should be brought to the attention of the Chief Compliance Officer/Title IX Coordinator.

Students with Special Needs

Essex County College welcomes students with disabilities into all of the college's educational programs. It is the policy and practice of Essex County College to promote inclusive learning environments. If you have a documented disability, you may be eligible for reasonable accommodations in compliance with college policy, the Americans with Disabilities Act, Section 504 of the Rehabilitation Act, and/or the New Jersey Law Against Discrimination. Please note, students are not permitted to negotiate accommodations directly with Professors, Academic Chairpersons, and Deans. To request accommodations or assistance, please self-identify with the Office of Students with Disabilities Services. The office is located at the Student Development and Counseling Department at the Main Campus in Room 4122I, and on Tuesdays at West Essex Campus' Advisement Center. Contact us by telephone at 973-877-3071 or by email at disability@essex.edu.

Inquiries or complaints may be addressed to:

Employment/Disability: Karen Bridgett, Human Resource Operations and Employee Services, Human Resources Department, Room 5112,
Telephone: (973) 877-3085.
Email: bridgett@essex.edu

Students: Dr. Keith Kirkland,
Dean of Student Affairs
Telephone: (973) 877-3070
Email: oostudentaffairs@essex.edu



ENROLLMENT IN SINGLE SIGN-ON

The poster features the Essex County College logo at the top left, with the tagline 'STUDENTS FIRST'. The main title 'Single Sign-On SSO with MFA Multifactor Authentication' is prominently displayed in the center. To the right, a smiling woman is shown using a laptop, with a large green shield icon containing a padlock overlaid on the screen. Below the title, text states that the college is going live on December 4th with SSO and MFA. A section at the bottom left explains that SSO/MFA will allow users to securely log in once to access Webservices, Moodle, and Email. On the right side, there are two call-to-action buttons: 'START ENROLLING November 4th 2023' and 'SCAN QR CODE' with a corresponding QR code.

ESSEX
COUNTY COLLEGE
STUDENTS FIRST

Single Sign-On
SSO
with **MFA**
Multifactor
Authentication

Essex County College
is going live on **December 4th**
with Single Sign-On (SSO) with
Multifactor Authentication (MFA).

SSO/MFA will allow you to securely log in
once to access Webservices, Moodle, and
Email using just one pair of credentials.

START
ENROLLING

November
4th
2023

SCAN
QR CODE

Single Sign-On with Multifactor Authentication

SSO/MFA enrollment is now required to access your Moodle courses, Email and Webservices. You may enroll by scanning the QR code above or using this link:
<http://Myportal.essex.edu>

Webservices, Email and Moodle Rooms are among the applications bundled into the new single sign on process that will allow you log in once to access all of these applications. Information about the ECC Portal is on the following pages.



“MyECC” Portal

Single point of access to information, & **On-line services.**

- 1) Go to www.essex.edu
- 2) Click on **Student** OR Use Single-Sign-On Login Here: <http://Myportal.essex.edu>
- 3) Click on **Login MyECC**
- 4) Enter **User Name & Password**

Inside “MyECC”

- ✓ Current **Class Schedule**, Instructor Office Hours & E-mail.
- ✓ **Web Mail – Student E-mail**
- ✓ **Web Services – Register for classes**, see your account balance, grades, and more.
- ✓ **Financial Aid** – Award Status, **Book Voucher**, Check if your courses are approved for payment.
- ✓ **Notifications** - No-Show notifications.
- ✓ **General Announcements** – Important Due Dates.
- ✓ **Emergency Announcements.**
- ✓ **Sign up for ECC Text-Message Emergency Alert.**

CHECK YOUR E-MAIL FREQUENTLY

- **MyECC Portal & Email** is the primary way the college will communicate with students.
- Login to **MyECC**, **check your e-mail** for important announcements from your professors, and college departments.



4-Simple Steps to Advisement & Web Registration

STEP 1: Be Advised

Degree Seeking/Matriculating students

If you have questions about the requirements for your degree, report to the academic department of your major.

Non-degree seeking / Non-Matriculating students: Report to the academic division of the course.

Non-matriculating students must provide a college transcript or written permission from their home school to verify course pre-requisites are met. Course prerequisite information is available on the College's web site.

STEP 2: Plan your class schedule

Class Schedule is available at <https://webservices.essex.edu/>. Review schedule carefully. Once you determine

the courses you need to take for your major, make your class schedule. The Class Schedule is available online on the College's Web Site. When selecting courses, **please pay special attention to the following:**

Courses required for your major - Run your degree evaluation in Web Services, or check with an academic advisor. Financial Aid will pay only for courses in your major program.

Class start & end dates

Campus designations: **M** = Main campus, **W** = West Essex Campus, **I** = Ironbound
 F = F.O.C.U.S. Extension Center,

Section designations: Online, Hybrid, Bilingual, Weekend, & Late Start Classes

STEP 3: Register for your classes online

Login to <https://webservices.essex.edu/> and register online.

Go to www.essex.edu , click on **Students**.

Click on **Web Services**.

Click on **Student & Financial Aid**, and click on **Registration**.

STEP 4: Pay your bill

Protect your registration from cancellation. Pay your bill by the due date. Payment due dates are available on the college website.

Payment in full or enrollment in the **Payment Plan** can be made online. **ALL payments**, cash/check, financial aid awards, tuition waivers, agency or employer vouchers, and Scholarships **must be submitted to the Bursar's Office by the payment due date**.

IMPORTANT: If you have not been awarded financial aid, login to Web Services and apply for the **Financial Aid Temporary Registration Protection Plan (FATRP)** as soon as you register for your classes. This process will protect your registration from being canceled while your file is being reviewed for aid eligibility. If you are not eligible for the FATRP, you must **be prepared to pay your registration bill in full or sign up for the Payment Plan** until your eligibility is determined.



Where to go for Advisement

Essex County College

Welcome Center

Your One-Stop Center!!!

We provide:

- Applicant completion assistance
- Placement Testing assistance
- Financial Aid Assistance- FAFSA Completion
- New Student Advisement
- General College Information

Please Call Us:

(973) 877 4477

Or email us: welcomecenter@essex.edu

ECC ACADEMIC DIVISIONS AND DEPARTMENTS

Bilingual Studies	LEVEL 1, RED AREA
Biology, Chemistry & Physics Division	LEVEL 2, BLUE AREA
Business Division	LEVEL 3, GREEN AREA
Engineering Tech., Computer Sciences & Math Division	LEVEL 2, BLUE AREA
Humanities / Liberal Arts Division	LEVEL 1, RED AREA
Nursing/Allied Health Division	CENTER FOR HEALTH SCIENCES
Social Science Division	LEVEL 3, YELLOW AREA

- **Returning Students** and **Transfer Students** report to the **Academic Division** of your major.
- **New Students** report to the **Advisement Center** located on Level I, Red Area by appointment only.
- **Academic probation students:** Report to the Office of Student Development and Counseling Services, 4th Floor Room 4122.
- **Educational Opportunity Fund Students:** Report to the EOF Office, Room 3217, Main Campus.
- **Veterans Educational Benefit Students:** Report to Room 4124, Main Campus.
- For **West Essex Campus**, call (973) 877-6590.
- If you plan to attend one of the **Extension Centers**, please call prior to registering: FOCUS AND IRONBOUND: (973) 877-3158. ALL OTHERS: (973) 877-3400.



REGISTRATION HOLDS

Students with any of the following holds on their record will not be allowed to register. Please report to the appropriate office to clear the hold.

<u>Type of Hold</u>	<u>Appropriate Office/Contact Person</u>	<u>Room</u>
Financial Aid	Financial Aid	4120
Bursar	Bursar's Office	4121
Probation	Student Development & Counseling	4122
Academic	Student Development & Counseling	4122
Dean	Dean of Student Affairs	5105
Registrar	Enrollment Services	4124
Readmission	Enrollment Services	4124
International Student	Enrollment Services	4124

All student holds will be indicated on the computer screen when registration is attempted. Once the hold is cleared, the student may return to register on the web or in-person. No student or former student may obtain a transcript of academic records or be allowed to register for classes until all financial obligations to the College have been met. Prior balances must be paid by money order, cashier or certified check, or credit card (Visa/MasterCard, Discover and American Express accepted). No personal checks will be accepted in payment of prior balances. Any student who has presented a check later returned to the College unpaid is automatically placed on a cash basis.



Are you on track to complete your degree? Track your Progress with DegreeWorks

DegreeWorks is a web-based program that enables you to easily track your academic progress. You will be able to see how specific College requirements have been met and what courses you can take to fulfill the requirements which are remaining. With the click of the tab (the 'What If feature), you will also be able to see how your academic requirements might change if you were to change your major. DegreeWorks is **NOT a replacement for regular academic advising by a faculty advisor**. Your academic advisor is the best source for information about degree and certificate requirements and interpreting your evaluation. **Important Note: Financial Aid will pay ONLY for courses required for your degree or certificate program.** Follow the steps below to run your online degree evaluation.

Watch the introductory video here: [ECC DegreeWorks Introduction Video](#)



DegreeWorks Frequently Asked Questions

How do I benefit from using DegreeWorks?

- You can determine what requirements are needed to fulfill/complete your degree.
- View individual course grades, cumulative grade-point average (GPA), and major average.
- Determine which courses you have taken or transferred, and which ones count as electives.
- View transfer credits, waivers, and exemptions applied toward degree.
- See how your coursework can be applied toward another major, minor, certificate or major concentration using the 'What If' option.
- Confirm your academic standing.
- Estimate how many semesters it will take you to graduate.
- Learn the requisites for courses by clicking on the course number.

What if I think my worksheet is incorrect?

If you think that a requirement is incorrect, you should meet with an Academic Advisor or consult the official College catalog.

NOTE: Students who have graduated may not see an audit once the graduation notation has been posted to their transcript. Students considering readmission will not be able to see a degree audit until they officially readmit to the College.

What is SEP?

SEP stands for Student Educational Planner and it's the newest feature of DegreeWorks. SEP allows student advisors to plan courses for every semester of enrollment to ensure your program can be completed within the time allotted. If you are interested in having a SEP plan created, you should talk to your academic advisor or Student Coach.

Why does DegreeWorks show, "Concentration is required?"

Some majors have varying tracks (concentrations); DegreeWorks will show 'Concentration is required' until the entirety of the concentration has been completed (i.e.: you have completed your major). The term concentration refers to a sub-plan of the same departments may refer to sub-plans as concentrations or tracks. Confirm that your declared concentration and corresponding requirements are also appearing on DegreeWorks.

What should I do if I have a question about my requirements?

Questions regarding requirements should be directed to an Academic Advisor.

Sign into DegreeWorks here: <http://Myportal.essex.edu>



How to Register Online

1. Go to <https://webservices.essex.edu/> OR Use Single-Sign-On Login Here: <http://Myportal.essex.edu>
2. Click on **Enter Secure Area**, and enter your **User ID** and **PIN**.
3. Click on **Student & Financial Aid**.
4. Click on **Registration**.
5. Click on **Select Term**.
6. Click on **Register Add/Drop your classes**.
7. **Enter** the Course **CRN**.
8. Click on **Submit**.
9. **Verify your input**, check for any errors and re-submit corrections.
10. When you are finished, **print your schedule** and **bill** for your records.

► **Forgot PIN/Password**: Use the simple steps below to reset your PIN.

1. Go to <https://webservices.essex.edu/>.
2. Click the **Enter Secure Area** link.
3. Enter your User ID in the **User ID** field.
4. Click on the **Forgot PIN** button. You will be prompted the security question you created.
5. Enter your answer to the security question in the **Answer** field.
6. Click the **Submit Answer** button. If you answered correctly, then you will be able to reset your PIN. However, if you have not set up a Security Question on Web Services, then you must report to the Enrollment Services Department to have your Web Services PIN reset.

(If you need further assistance, please visit the Enrollment Services Office)

How to Wait List for a Closed Course

Waitlist is available to students attempting to register for sections that are full to capacity.

A Waitlist demo is on YouTube. Search for “Essex College Waitlisting.” Set the resolution to 480 or 720p for the best picture.

Getting on the Waitlist:

1. Go to **Web Services** where you register for courses.
2. **Type the CRN** of a course you want and click **Submit Changes**.
3. **If the course is closed**, it will appear under a red dot that says “Registration Add Errors” and under Status it will say “closed.” Open the Action menu of the course, **click “wait list,”** and then click **Submit Changes**.
4. You are now on the Wait List! You are not billed for Waitlisted class.

NOTE: Waitlisted courses DO appear on student schedules, but **being on a waitlist does NOT guarantee that the student will be allowed to register for the course.** Students who are de-registered (purged) for non-payment are removed from all waitlists.

Notification of open seat:

If a seat becomes available, you will receive notification in your Essex County College email account unless you changed your preferred email in Banner. **Check your ECC email frequently.** You will have a **small window of time, sometimes as little as 12 hours, to claim your seat, and the clock starts when the email is sent**, not when you read it. No one else can take your seat until your time expires.

******* VERY IMPORTANT *******

Remember to check your e-mail frequently. If your window of time expires, you will be removed from the waitlist and the next person in line will be given the opportunity to take the open seat. If you add yourself back to the waitlist, you will be added at the end of the line.

Registering when a seat is available:

1. The system will NOT register you automatically; you have to register yourself after you receive the e-mail notification.
2. Go to the **Web Services** where you register for courses.
3. Open the Action menu for the waitlisted course; **change the status of the class from ‘Waitlist’ to ‘Web Registered’** then click **Submit Changes**.
4. You are now registered for the course!

If you miss your registration window your only recourse is to re-add your name to the waitlist. Please be aware, some activities are irreversible. If you drop a class that has a waitlist, the seat will be offered to the student at the top of that waitlist. There is no undo!

When searching for open classes, please keep in mind that open seats are NOT available if they have been offered to students on top of the Waitlist. If the number in the **“WLAct”** column is greater than in the **‘Rem’** column, then open seats are NOT available.

(Wait Listing may not be available for certain courses)



REGISTRATION COMMON ERRORS

Registration errors will appear below your current schedule and are marked with a red **"STOP"** sign. To determine the specific registration error, scroll right to the "Status" field (last column). A possible "Action" appears in the first field.

Error Message	Reason	What to do
Preq_test_score error	Course has a pre-requisite.	Register for the pre-requisite course or see academic advisor
Creq_req	Course has a co-requisite: usually a lab or tutorial section is missing.	Register for the lab or tutorial section and lecture section of the course simultaneously
Time Conflict with CRN	Course time overlaps with another course.	Select another section of the course that fits in your class schedule
Advisor Approval	Course requires Advisor Approval.	Student should meet with academic advisor
Major Restriction	Course is restricted to certain Majors.	Student should meet with academic advisor to update Major
Duplicate CRN	Course was entered more than once.	Course will be deleted automatically
Maximum HRS Exceeded	Registration attempted is beyond the Maximum credit hours allowed.	Approval required from division chairperson to register for additional course credits.
Academic Standing Prohibits Registration	Academic Probation restriction.	Meet with an Academic Counselor
Level Restriction	Student is in Non-Credit program.	Student should go to Enrollment Services
Code of Conduct/Judicial	Student Life/CDS	Student should go to Dasher - Room 107B



Advisement & In-person Registration

Current Students

1. Be Advised

Degree Seeking/Matriculating students:

If you have a question about the course requirements for your degree, report to the academic department of your major at the Main Campus or the Multi-purpose Room at the West Essex Campus for advisement. You can also visit the new Advisement Center located on Level I, Red Area.

Non-Matriculating students: Report to the academic division of the course with a copy of your acceptance letter. Non-matriculating students must provide a college transcript or written permission from their home school to verify course pre-requisites are met. Course prerequisite information is available on the College's web site.

2. Schedule your Classes

Refer to the printed Class Schedule or look up the Class Schedule online via Web services. When selecting courses, **please pay special attention** to the following:

Courses required for your major - Run your degree evaluation in Web Services, or check with an academic advisor. Financial Aid will pay only for courses in your major program.

Class start & end dates: Summer I, Summer II classes

Campus designations: **M** = Main campus, **W** = West Essex Campus, **I** = Ironbound
F = F.O.C.U.S. Extension Center

Section designations: Campus, Hybrid, Bilingual, Weekend, & Late Start Classes

3. Register for Classes

After advisement, take your **Advisement & Registration Form** or Add/Drop Form to a designated registration station for processing. Students are urged to see their academic advisor before dropping courses. Students may add and drop courses any time during the registration period. A \$20 fee will be charged for add/drop transactions. The fee will not be charged if the schedule changes are caused by course cancellations.

4. Pay tuition bill

Payment in full or enrollment in the **Payment Plan** can be made online.

ALL payments, cash/check, financial aid awards, tuition waivers, agency or employer vouchers, and Scholarships **must be submitted to the Bursar's Office by the payment due date.**

IMPORTANT: If you have not been awarded financial aid, login to Web Services and apply for the **Financial Aid Temporary Registration Protection Plan (FATRP)** as soon as you register for your classes. This process will protect your registration from being canceled while your file is being reviewed for aid eligibility. If you are not eligible for the FATRP, you must **be prepared to pay your registration bill in full or sign up for the Payment Plan** until your eligibility is determined.



Enrollment Steps

New Students

1) Apply for Admission

Submit Admission Application with \$30 fee by the deadline date. Applications may be submitted **online**, **by mail**, and **in-person**. Application Deadline is posted on the College Web Site. After your application is processed, your acceptance package including testing and advisement/registration information will be sent to you in the mail.

Apply for Financial Aid

All financial aid applicants (including NJSTARS) are encouraged to **complete the Free Application for Federal Student Aid (FAFSA)** at www.fafsa.gov. Non-matriculating students are not eligible to receive financial aid.

2) Take the Pre-enrollment ACCUPLACER Test

All new students seeking a degree or certificate are required to **complete a pre-enrollment ACCUPLACER Test** given by the Testing Center – Room 4152. This test is used to determine placement in college-level or developmental courses. Testing information and instructions will be sent with your Acceptance Letter Package. Information about placement test exemptions and waiver is available on the College Web Site. After completing the placement test, you will receive information regarding advisement and registration.

Non-degree, Non-matriculating, are not required to take the College Placement Test but must provide transcript to verify completion of course pre-requisites.

3) Register for classes

Attend your scheduled Advisement & Registration Session. You will meet with an advisor to develop a schedule and register for classes. You will receive your class schedule and a bill for tuition and fees immediately following registration.

Transfer Students, and **Readmitting** Students report to the academic department of their major and should bring their transcript evaluation, and/or placement test waiver form to advisement & registration.

Non-degree, Non-Matriculating, students report to the academic division where the course is offered. Non-degree, Non-matriculating students must provide a college transcript or written permission from the home school to verify course pre-requisites. Course prerequisite information is available online.

4) Pay tuition bill

ALL payments, financial aid awards, tuition waivers, agency/employer vouchers, and Scholarships **must be submitted by the payment due date**. Payment due dates will be indicated on your class schedule and bill. **Make a Full payment or enroll in the College's Payment Plan by the payment due date.** Payment can be made online through the Web Services Payment Portal at <http://Myportal.essex.edu>

5) Attend New Student Orientation

Orientation information will be sent to your home address. **Attend your scheduled orientation and information session.**



DROPPING A CLASS

- Students may drop classes throughout the registration and add/drop period.
- It is the student's responsibility to drop classes by the deadline date. Deadlines are published in the Important Dates Calendar. Go to <http://www.essex.edu> click on **Students**.
- Students may drop classes online through Web Services or during in-person registration and add/drop period.
- Dropped classes will not appear on student's permanent transcript.
- Tuition will be adjusted according to the Tuition Refund Policy.

WITHDRAWING FROM A CLASS

- Withdrawal starts after the Add/Drop period.
- All withdrawal requests **must be submitted online** through Web Services.
- It is the student's responsibility to withdraw from classes by the deadline date. Deadlines are published in the Important Dates Calendar. Go to <http://www.essex.edu> click on Students and login to Web Services
- Students who withdraw between the end of add/drop and the last day to withdraw will receive a grade of 'W'.
- Tuition will be adjusted according to the Tuition Refund Policy.

Caution! Dropping classes or withdrawing from classes may affect financial aid eligibility, NJSTARS eligibility, veteran's benefits, athletic eligibility, F-1 Visa status, and timely completion of degree requirements. **Students are strongly urged to speak with their instructor or a counselor before dropping classes or withdrawing from classes.**

CLASS ATTENDANCE

Faculty take attendance at each scheduled class session and students are expected to attend all classes on time. Individual faculty may establish specific attendance policies. Students with excessive absences will be referred to a counselor. Continued absence from regularly scheduled classes may result in failure. **A student who is absent from class will be recorded as a 'No-Show' or "Not Attending"**. A 'No-Show' or "Not Attending" status will appear on the student's record and students will be notified by e-mail including the deadline for correcting their status. Students must see their instructor by the deadline date in order to correct their No-Show status.

STUDENT E-MAIL ACCOUNT

The college has provided Google mail (e-mail) services to all students. To access your e-mail messages, please **login to "MyECC" Portal**. Please note that ECC departments and your faculty will be communicating with you primarily via e-mail. **DO NOT MISS IMPORTANT AND DATE SENSITIVE E-MAIL MESSAGES** from your professors or college departments. **Students are responsible for checking their e-mail.** **Make it a habit to login and check your e-mail messages on a regular basis.**



UPDATE YOUR ADDRESS & PHONE NUMBER

Students are advised to check and update their address and phone number on a regular basis. Address information can be viewed online or in-person at the Enrollment Services Office. If your mail is returned, we may place a hold on your record blocking your access to registration, grades, or transcripts.

COURSE CANCELLATION

Some courses may be cancelled due to low enrollment. Students will be notified of canceled courses through their student e-mail account. Also, a list of cancelled courses will be posted in the academic divisions. At the West Essex campus, the listing will be posted outside the Main Office door. **If any of your courses are cancelled, it is your responsibility to add an alternate course or section before the add/drop period ends.** If you have any questions about alternate courses, please see your academic advisor.

AUDITING A COURSE

Audited courses do not carry academic credit. In order to audit a course, students must register, pay full tuition and fees, and **complete and submit an Auditing Course Form** to the Enrollment Services Office by the deadline date.

MANDATED HEALTH INSURANCE

The State of New Jersey **no longer** requires health insurance coverage for full time students enrolled in community colleges. This means that Essex County College will **no longer** offer health insurance coverage to students, and will **no longer** include a health insurance fee in students' bill beginning Fall 2013 (September 2013).

The purchase of health insurance coverage is now an individual student choice and responsibility. This includes all allied health students who need health insurance for their clinical rotations. The State of New Jersey has created a website with information on available health insurance providers. Please visit the website below.

http://www.state.nj.us/dobi/division_insurance/ihcseh/shop_ihc.htm

IMMUNIZATION REQUIREMENT

All Applicants for admission to the College, who are seeking a degree or certificate from Essex County College or intending to enroll as full-time (12 or more credits per semester), must provide documentation of immunization prior to initial enrollment. Measles, Mumps and Rubella (MMR) and Hepatitis B (Three doses) or blood tests confirming immunity N.J.A.C.8:57-6.1 - 6.6.

Immunization Form is available in Enrollment Services or online:

http://www.essex.edu/wp-content/uploads/2018/07/essex-immunization-form_rev0816.pdf



Cross Registration Information for Exchange Students

ESSEX COUNTY COLLEGE STUDENTS

- Exchange (Cross Registration) is allowed only when the course requested is part of your degree program at ECC and the course is not being offered at ECC either in the semester in which exchange is requested or in the next semester. Students should always consult with ECC academic department before registering for a course at NJIT or Rutgers-Newark to ensure course equivalency.
- Non-matriculating students may not register for NJIT courses via the Exchange Registration program.
- Exchange (Cross Registration) is not accepted for Summer sessions.

ECC students must follow the steps below.

1. Complete an Exchange (Cross Registration) Form.
2. Have the form signed by the academic division chairperson of your major.
3. Take Exchange (Cross Registration) Form to the Registrar's Office at NJIT or Rutgers-Newark during their registration period.
4. After registering for courses, submit proof of registration and a copy of Exchange (Cross Registration) Form to the ECC Enrollment Services Office on the 4th level.
5. ECC Enrollment Services will add the equivalent course credits to your registration. Check Web Services for updates to your registration.
6. Student makes a payment at the ECC Bursars Office.
7. If you add/drop or withdraw from a course(s) at NJIT or Rutgers-Newark, you should also add/drop or withdraw course at ECC at the same time.
8. The Registrar's Office at NJIT or Rutgers-Newark will forward grades to ECC Enrollment Services at the end of the semester. All courses and grades received at NJIT or Rutgers-Newark are posted on the ECC transcript.

NJIT, RUTGERS-NEWARK STUDENTS

For purposes of Exchange (Cross Registration), Essex County College will apply all of the criteria mentioned below and require verification of same. Cross registration will be processed for eligible students.

- The course student wishes to take at ECC is part of student's degree program, and;
- The course is not offered at the home school during the current semester or in subsequent Fall/Spring semesters, and;
- The student needs the course to graduate at the end of the current semester, and;
- The student has submitted an Exchange (Cross Registration) Form & Verification of Course & Program Requirement Form signed by the home school academic advisor.

NJIT, Rutgers-Newark Students must follow the steps below

1. Complete an Exchange (Cross Registration) Form and Verification of Course & Program Requirement Form.
2. Have the forms signed by the home school academic advisor.
3. Submit both forms to the Enrollment Services Office at Essex County College during the registration period. If registering at ECC for the first time, students must also complete an admission application.
4. After registration is processed, student will receive a schedule.
5. Student makes a payment at the home school.
6. **The Course Technology Fee and Book Fee if applicable, must be paid at the ECC Bursars Office.**
7. Confirmation of registration will be sent to the Registrar's Office at the home school.
8. If you add/drop or withdraw from a course(s) at NJIT or Rutgers-Newark, you should also add/drop or withdraw course at ECC at the same time.
9. Essex County College will forward grades to the home school Registrar's Office at the end of the semester.

NOTE: NJIT or Rutgers-Newark students who do not meet the criteria for cross registration, may enroll for courses on a non-matriculating student on a space available basis and pay tuition and fees at Essex County College. Students may need to submit copy of transcript to ECC academic division chairperson for registration approval.



FINANCIAL AID INFORMATION

Student financial assistance is available to eligible students in the following forms:

- Gift aid: Grants and scholarships that you do not need to pay back. Each grant and scholarship may have specific requirements to maintain eligibility/renew.
- Work-study: A program in which an eligible applicant can earn up to the amount listed after securing a work-study job through your college. The money earned is not typically available to pay your college bill; you will be paid directly via a paycheck for the hours worked.
- Loans: Borrowed money that must be paid back, with interest. You can choose to reduce or decline the amount offered.

A student may have a combination of grants, scholarships, and work-study in their financial aid package. Applicant eligibility and program guidelines are determined by federal and state regulations. For complete details, see the Financial Aid Office website at <https://www.essex.edu/fa>.

IMPORTANT: If you have not been awarded financial aid, login to Web Services and apply for the Financial Aid Temporary Registration Protection Plan (FATRP) as soon as you register for your classes. This process will protect your registration from being canceled while your file is being reviewed for aid eligibility. If you are not eligible for the FATRP, you must be prepared to pay your registration bill in full or sign up for the Payment Plan until your eligibility is determined and **as stated in our Student Financial Responsibility Agreement signed at the time of class registration.**

How to Apply for Financial Aid

- Create a Federal Student Aid ID (FSA ID) at <https://fsaid.ed.gov/>. You and your parent (if you are a dependent student) must create a FSA ID and password in order to confirm your identity, access specific US Department of Education websites, and to electronically sign your *Free Application for Federal Student Aid* (FAFSA®). The process of creating an FSA ID can take from one to three days.
- Complete and submit the *Free Application for Federal Student Aid* (FAFSA®). The FAFSA® is the application form for Federal student aid. It is also used by the State of New Jersey as the application for state-based student financial assistance. File the FAFSA® online at <http://fafsa.gov>, or by using the myStudentAid app (iOS App Store or Google Play for Android; see this URL for links to download the respective app: <https://studentaid.gov/apply-for-aid/fafsa/filling-out?sf109918458=1>). Be sure to include Essex County College's Federal School Code-007107 in the school section of the FAFSA®.
- Applicants should try and use the IRS Data Retrieval Tool during the FAFSA® filing process to import your/and your parent's (if dependent) tax information directly into the FAFSA®. If you do not do so, you may be required to submit a copy of the IRS Tax Return Transcript to the Financial Aid Office. See these instructions from the IRS on how to obtain the transcript: <https://www.irs.gov/individuals/get-transcript>.
- If you/ your parent do not create a FSA ID username and password, you and your parent (if dependent) will need to print the signature page for the FAFSA® and mail it to the address listed on the signature page as your application will not be processed by FAFSA® by the US Department of Education's processor until a signed signature page is submitted and received.

(Note: The FAFSA® is available for filing on December 1st and you must fill out the FAFSA® form every year you're in school in order to stay eligible for federal student aid.)

How to Apply for New Jersey State Aid – The Higher Education Student Assistance Authority (HESAA)

For State of New Jersey student aid consideration, please make sure to complete the state-based questions in the link on the Confirmation Page that says "Start your State Aid Application". They can also be completed on the NJ FAMS website of the New Jersey Higher Education Student Assistance Authority (HESAA) here: <https://njfams.hesaa.org>. See this web-page to create a NJ FAMS Student Login:

<https://njfams.hesaa.org/NJFAMS/StudentRegisterForLogin.aspx>. NJ “Dreamers” should file the *NJ Alternative Financial Aid Application*: <https://www.hesaa.org/Pages/NJAlternativeApplication.aspx>.

Private Education Loans

Private Educational Loans are private credit based educational loans. The borrower has the option to go to any lender/bank of their choice to apply and be approved by that lender/bank for a private educational loan. ECC does not participate in the Federal Direct Stafford Loan or Federal Direct PLUS Loan programs. (loans). ECC does not maintain a preferred lender list for private education loans and will certify any loan presented that requires certification not to exceed the student’s cost of attendance.

FAFSA® Workshops

For assistance in completing your FAFSA® online, please attend a scheduled FAFSA® Workshop, the workshop schedule will be posted on the ECC Office of Financial Aid webpage at www.essex.edu/fa/.

Check Your Eligibility Status

Go to the MYECC.essex.edu portal to check your financial aid status 3-5 working days after you file your FAFSA®. If you are requested to submit additional documents or information, you must submit that information to the Office of Financial Aid at Essex County College, immediately. If the Higher Education Student Assistance Authority (HESAA) is requesting information from you, you must send that information directly to HESAA on the NJ FAMS website of the New Jersey Higher Education Student Assistance Authority (HESAA) at: <https://njfams.hesaa.org>.

Determining Your Eligibility for Aid

Your eligibility for aid at ECC will be determined by the Office of Financial Aid. To ensure your eligibility for financial aid is determined at the time you register for classes, file your FAFSA® at least 6-8 weeks before your plan to register for your classes. Your Financial Aid Offer Letter/Denial Letter will be at your MYECC.essex.edu portal.

Priority Processing Deadline

Essex County College’s Federal School Code is 007107. Essex County College’s deadline for priority processing is May 1, 2022, both for Summer II (July 2022) consideration and for the 2022-23 academic year (starting with Fall 2022). After this deadline, you must submit the FAFSA® immediately or at least six (6) weeks before you plan to register for classes. The FAFSA® must be filed for each academic year. To file the FAFSA®, you will need to have income information for yourself and your spouse, and/or parents (if you are a dependent student) for the 2020 year.

What happens if I am registered, but are not eligible for student aid?

You must be prepared to remit payment for your charges per the College’s billing and payment policies to maintain your enrollment if your eligibility for financial aid has not been determined.

Eligibility for Assistance in Buying Your Books

If the student aid for which you are eligible exceeds your College charges, you can, if you wish, utilize a potential credit balance to purchase books and supplies in the College Store. A Book Voucher, which will inform the student of their credit limit against their projected credit balance for use in the College Store, will be created and made available to you on your myeyecc.essex.edu portal. A student must download and print their book voucher and present it at the College Store. A book voucher will only be created if a student has or is projected to have funds remaining from all student aid for which they are eligible after your tuition and fees are paid. The College Store will be advised of any potential credit that you can use within the Store. However, if your credit balance changes and you make transactions at the Store that exceeds your credit, you will need to satisfy that difference. Please be advised, however, that a student is not required to obtain books and supplies in the College Store, and there may be more cost-effective options for a student to obtain books and supplies elsewhere.

How the Office of Financial Aid Communicates with Students

The Office of Financial Aid will communicate with students only via their ECC Email address and students should check their College email daily. Please contact your assigned Officer with any questions or concerns about financial aid process. The Officer listing, with caseload and direct email addresses, are noted on the Financial Aid Office website: www.essex.edu/fa.

Financial Aid Return of Title IV Funds

U.S. Department of Education regulation for federal student aid programs require schools to adjust federal student aid for students who totally withdraw or are dismissed prior to the 60% time period of a semester. Students who withdraw before the 60% time period of a semester will have their financial aid account reviewed, with any federal student aid adjusted in accordance with the Return of Title IV Funds policy. The complete Return of Title IV funds policy is available on the financial aid website at www.essex.edu/fa.



TUITION & FEES

Type	In County	Out of County
Application Fee	\$ 30.00	\$ 30.00
Course Audit Fee Per Credit Hour	129.03	258.06
CEU Certificate Fee	10.00	10.00
CLEP (Service Fee Per Session)	28.50	28.50
CLEP (Exam fee per subject)	85.00	85.00
Course Change Add/Drop Fee Per Transaction	20.00	20.00
College Payment Plan Default Fee	100.00	100.00
College Payment Plan (Enrollment Fee)	50.00	50.00
Graduation & Degree Audit Fee (Additional Degree& Certificate)	30.00	30.00
Graduation & Degree Audit Fee (Initial Degree)	60.00	60.00
Dishonored Check Fee	40.00	40.00
General Fee Per Credit Hour*	\$34.49	\$68.98
ID Card Replacement Fee	10.00	10.00
Late Payment Fee	30.00	30.00
Late Registration Fee	25.00	25.00
Off-Campus Registration Fee Per Course (West Essex Campus)	10.00	10.00
Off-Campus Registration Fee Per Course (FOCUS & Ironbound)	15.00	15.00
Parking Fee	75.00	75.00
Readmission Fee	25.00	25.00
Technology Fee	15.00	15.00
Course Materials Fee	75.00	75.00
Registration Reinstatement Fee	100.00	100.00
Schedule & bill replacement fee	1.00	1.00
Student Activity Fee Per Credit Hour	7.65	7.65
Testing-Out Fee Per Credit Hour - Letter Grade	129.03	258.06
Transcript Fee - Official / Unofficial Copy	10.00	10.00
Tuition Per Credit Hour	\$134.24	\$268.48

Fees are non-refundable except for course cancellations and for withdrawals during the first week of classes. Essex County College reserves the right, with no prior notice, to restructure tuition fee rates.



RESIDENCY DEFINITION

In-County Tuition:

To qualify for in-county tuition rate, students must meet the requirements below and provide proof of permanent residency upon request.

1. Student must have continuously resided in the State of New Jersey for at least one year before the first day of the semester.
2. Student must have established residency in Essex County before the first day of the semester.

Students who do not meet the above residency requirements will be charged the out-of-county tuition rate.

Certain students may apply for in-county tuition.

- Students who moved in-county prior to the first day of the semester.
Please note that changing your address does not adjust your tuition rate automatically. You must file a Tuition Rate Adjustment Request with supporting documents to Enrollment Services.
- Essex County residents who did not reside in the State of New Jersey for one year at the time of application but have since met the one year requirement.
- Students with incomplete admission application that resulted in an out-of-county tuition charges.

PLEASE NOTE: Tuition Rate Adjustment Request Form **must be submitted** to the Enrollment Services Office, **no later than the second week of classes**. Tuition Rate Adjustment Request Form and a list of documents that can be submitted as proof of permanent residency are available in Enrollment Services upon request.

Tuition Chargeback for Out-of-County Residents

Out-of-county residents attending ECC, may be eligible for **tuition chargeback assistance** from their county in accordance with N.J.S.A. 18A:64A-23, pursuant to the Chargeback Laws of 1968.

Out of county residents who are eligible for chargeback assistance must:

1. Apply for a tuition chargeback at your home County College and home County Treasurer.
2. Submit approved chargeback forms to the ECC Bursar's office by:
 - Summer I Semester – May 24, 2022
 - Summer II Semester- July 26, 2022
 - All Fall Semesters – October 25, 2022



TELEPHONE DIRECTORY

Admissions	Room 4124	(973) 877-3100
Bilingual Studies	Room 1107	(973) 877-3450
Biology, Chemistry & Physics Division	Room 2141	(973) 877-3430
Bookstore	Room 1191	(973) 877-3137
Bursar's Office		
Main Campus	Room 4121	(973) 877-3099
West Essex Campus	WEC	(973) 877-6630
Business Division	Room 3204	(973) 877-3222
College Information Center	Room 2145	(973) 877-3078
College Readiness Program	Room 3310	(973) 977-3196
Community and Continuing Education	Room 3241	(973) 877-3106
Comptroller	Room 6116	(973) 877-3040
Cooperative Education Program	Room 4122	(973) 877-3350
Educational Opportunity Fund (EOF)	Room 3217	(973) 877-3228
Engineering Tech. & Computer Sciences	Room 2188	(973) 877-3303
Enrollment Services	Room 4124	(973) 877-3100
Financial Aid	Room 3224	(973) 877-3200
FOCUS/Ironbound/North Ward Centers	Room 3200	(973) 877-3158
Humanities/Liberal Arts Division	Room 1142	(973) 877-3285
Information Booth	2nd Level	(973) 877-3356
International Student Office	Room 4122B	(973) 877-3154
Mathematics	Room 2188	(973) 877-3302
Media Production Technology (MPT)	Room 3130	(973) 877-3275
Nursing/Allied Health Division	Room 200	(973) 877-1865
Office of Student Affairs	Room 5105	(973) 877-3055
Recruitment	Room 3470	(973) 877-3052
Retention & Academic Advisement	Room 1129	(973) 877-1941
Registrar	Room 4124	(973) 877-3100
Social Sciences Division	Room 3261	(973) 877-3250
Student Development & Counseling	Room 4122	(973) 877-3350
Testing Office	Room 4152	(973) 877-4436
Veterans' Services	Room 4122B	(973) 877-3154
West Essex Campus	WEC	(973) 877-6590
Welcome Center	2 nd Level	(973) 877-4477

FOR OTHER OFFICES PLEASE CALL THE MAIN NUMBER: (973) 877-3000



Section Legend

ESSEX COUNTY COLLEGE COURSE SCHEDULE SECTION LEGEND	
Section Identifier Description	Description
001, 002, 003, etc.	Main Campus Day Sections
OAC, OBC, OCC, etc.	Main Campus Evening Sections
B01, B02, BAC, BBC	Bilingual Sections (Courses for Bilingual or ESL students)
CL1, CL2, etc.	Clinical Sections
CW1, CW2, CW3, etc.	West Essex Campus Day Sections
CWC, 2WC	West Essex Campus Evening Sections
E01	Education Opportunity Fund (EOF)
F01, F02, FOA, FAC	Spanish Lecture Sections (all courses taught in Spanish except ESL and English)
FF1, FF2	Fall Focus 2021 Synchronous Sections (12-week term for Fall 2020)
HRS, HR1	Honors Sections – special approval required for registration
HS1, HS2, HS3, HSA, HSB, etc.	High School Initiative Sections – for HS students only
HY1, HY2, HYA, HW1, HW2	Hybrid Course Sections (W = West Essex)
IM1, IM2	Private Instruction Sections
IH1, NU1	Integrity House/1199 Sections – Continuing Ed registrants only
IS1, IS2	Independent Study Sections
KN1, KNA	Weekend College Sections for Main Campus
KW1, KWC	Weekend College Sections for West Essex Campus
LB1, LB2, etc.	Lab Sections
LS1, LS2, LSA, etc.	Main Campus Fall II Sections
LW1, LWC	West Essex Campus Fall II Sections
OL1, OL2, etc.	Online Sections for Fall I
OM1, OM2	Online Sections for Fall II
OW1, OW2	Online/Asynchronous Sections for Fall Focus 2021
RS1, RSA	Winter Intersession Sections
SW1, SWS	West Essex High School Sections – for HS students only
02V, 04V, 06V	Virtual Day sections offered synchronously via Zoom
BCV, DCV, FCV	Virtual Evening sections offered synchronously via Zoom
S2V, S4V, S6V	Virtual Day or Evening late start sections offered synchronously via Zoom
02H, 04H, 06H	Hybrid Day sections offered both synchronously via Zoom and face-to-face
BCH, DCH, FCH	Hybrid Evening sections offered both synchronously via Zoom and face-to-face

Last updated 4/26/21

Days Legend

M = Monday

T = Tuesday

W = Wednesday

R = Thursday

F = Friday

S = Saturday

U = Sunday

Example:

MW (Monday & Wednesday)

MWF (Monday, Wednesday, & Friday)

MTWR (Monday, Tuesday, Wednesday, & Thursday)

TR (Tuesday & Thursday)

TRF (Tuesday, Thursday, & Friday)

FS (Friday & Saturday)

Building Code Legend

M Megastructure (Main Campus)

CDC Clara Dasher Center Building
(Student Center)

CFT Center for Technology Building

CHS Center for Health Sciences Building

GYM Physical Education Building

W West Essex Campus
730 Bloomfield Avenue
West Caldwell, NJ 07006
(Temporarily closed due to new
construction...see virtual course
offerings)





2023 WINTER INTERSESSION SCHEDULE MAIN CAMPUS

WINTER INTERSESSION 2023 (202403) - MAIN CAMPUS
DECEMBER 26, 2023 - JANUARY 9, 2024

	VILC	MTWRF	1315
	CLASS	MTWRF	0900



2024 SPRING I SCHEDULE

MAIN CAMPUS

ESSEX COUNTY COLLEGE
303 UNIVERSITY AVENUE
NEWARK, NJ 07102
(973) 877-3100

SPRING SESSION I 2024 (202403) - MAIN CAMPUS
JANUARY 10, 2024 - APRIL 27, 2024

SUBJ	CRSE	SEC	CRN	CRSE_TITLE	INSM	DAYS	BEGIN	END	ROOM	CREDIT_HRS	LIMIT	STAFF
ACC	101	001	30001	Prin of Accounting I Financial	CLASS	MWF	0830	0945	4162	4	30	TBA
ACC	101	004	71142	Prin of Accounting I Financial	CLASS	TRF	1000	1120	4154	4	30	TBA
ACC	101	01V	38529	Prin of Accounting I Financial	VILC	TRF	1130	1245	(blank)	4	30	TBA
ACC	101	0BC	36755	Prin of Accounting I Financial	CLASS	MW	1715	1905	4162	4	30	TBA
ACC	101	OL1	38648	Prin of Accounting I Financial	ONLNE		(blank)	(blank)	(blank)	4	30	TBA
ACC	102	001	71386	Prin Accounting II Managerial	CLASS	TR	1715	1900	4154	4	30	TBA
ACC	102	003	35181	Prin Accounting II Managerial	CLASS	MWF	1000	1110	4162	4	30	TBA
ACC	102	02V	37737	Prin Accounting II Managerial	VILC	MWF	1130	1245	(blank)	4	30	TBA
ACC	102	KN1	71706	Prin Accounting II Managerial	CLASS	S	0830	1200	4162	4	30	TBA
ACC	102	OL1	70950	Prin Accounting II Managerial	ONLNE		(blank)	(blank)	(blank)	4	30	TBA
ACC	201	001	32666	Intermediate Accounting I	CLASS	TR	1715	1900	4162	4	30	TBA
ACC	231	0AV	71703	Federal Taxation	VILC	MW	1925	2110	(blank)	4	30	TBA
ACC	231	OL1	71387	Federal Taxation	ONLNE		(blank)	(blank)	(blank)	4	24	TBA
ACC	232	OL1	71385	Computerized Accounting	ONLNE		(blank)	(blank)	(blank)	4	24	TBA
ANT	101	01V	32074	Cultural Anthropology	VILC	MW	0830	0950	(blank)	3	30	TBA
ANT	101	02V	32073	Cultural Anthropology	VILC	TR	1000	1120	(blank)	3	30	TBA
ANT	101	0AV	32075	Cultural Anthropology	VILC	R	1840	2120	(blank)	3	30	TBA
ARC	102	001	35098	Architectral Design II	CLASS	MW	0830	1120	T204	4	18	TBA
ARC	102	001		Architectural Design II	CLASS	MW	0830	1120	T204	4	18	TBA
ARC	112	001	33531	History of Architecture II	CLASS	TR	1130	1250	T122	3	18	TBA
ARC	132	001	70512	Construction Methods II	CLASS	MW	1130	1250	T122	3	18	TBA
ARC	202	001	33874	Architectural Design IV	CLASS	TR	0830	1120	T205	4	18	TBA
ART	100	002	30029	Art Appreciation	CLASS	TR	1300	1420	2109	3	30	TBA

ART	100	01V	30028	Art Appreciation	VILC	MW	1000	1120	(blank)	3	30	TBA
ART	100	OL1	39045	Art Appreciation	ONLNE		(blank)	(blank)	(blank)	3	30	TBA
ART	101	01V	30036	Art History I	VILC	MW	1300	1420	(blank)	3	30	TBA
ART	101	IS1	71806	Art History I	CLASS		(blank)	(blank)	(blank)	3	1	TBA
ART	102	001	71620	Art History II	CLASS	MW	1550	1710	2109	3	30	TBA
ART	107	001	30040	Drawing I	CLASS	MW	0830	0950	1220	3	20	TBA
ART	111	001	71355	Fundamentals of Painting I	CLASS	MW	1000	1120	1220	3	20	TBA
ART	111	OAC	71356	Fundamentals of Painting I	CLASS	MW	1715	1835	1220	3	20	TBA
ART	140	001	39082	Introduction to Photography	CLASS	F	1130	1420	3130	3	20	TBA
ART	140	001		Introduction to Photography I	CLASS	F	1130	1420	3130	3	20	TBA
ART	205	001	34041	Two Dimensional Design	CLASS	TR	0830	0950	1220	3	20	TBA
ART	206	001	71357	Three Dimensional Design	CLASS	TR	1000	1120	1220	3	20	TBA
BIO	101	002	38385	College Biology I	CLASS	W	1300	1545	3434	4	24	TBA
BIO	101	002				M	1300	1545	3415	4	24	TBA
BIO	101	003	70902	College Biology I	CLASS	R	1130	1420	3413	4	24	TBA
BIO	101	003				T	1130	1420	3440	4	24	TBA
BIO	101	004	39813	College Biology I	CLASS	W	1000	1250	3438	4	24	TBA
BIO	101	004				M	1000	1250	3415	4	24	TBA
BIO	101	OAC	37806	College Biology I	CLASS	W	1840	2120	3413	4	24	TBA
BIO	101	OAC				M	1840	2120	3436	4	24	TBA
BIO	101	OBC	37808	College Biology I	CLASS	R	1840	2120	3413	4	24	TBA
BIO	101	OBC				T	1840	2120	3436	4	24	TBA
BIO	101	OCC	39678	College Biology I	CLASS	W	1840	2120	3434	4	24	TBA
BIO	101	OCC				M	1840	2120	3429	4	24	TBA
BIO	101	HY1	39355	College Biology I	HYBRD	R	0830	1120	(blank)	4	24	TBA
BIO	101	HY1				T	0830	1120	3433	4	24	TBA
BIO	101	HYA	71657	College Biology I	HYBRD	W	1840	2120	(blank)	4	24	TBA
BIO	101	HYA				M	1840	2120	3415	4	24	TBA
BIO	102	002	30060	College Biology II	CLASS	R	0830	1120	3436	4	24	TBA
BIO	102	002				T	0830	1120	3415	4	24	TBA
BIO	102	003	30062	College Biology II	CLASS	W	1000	1250	3413	4	24	TBA
BIO	102	003				M	1000	1250	3436	4	24	TBA

BIO	102	004	30066	College Biology II	CLASS	W	1130	1420	3454	4	24	TBA
BIO	102	004				M	1130	1420	3411	4	24	TBA
BIO	102	006	34073	College Biology II	CLASS	R	1130	1420	3440	4	24	TBA
BIO	102	006				T	1130	1420	3413	4	24	TBA
BIO	102	OAC	30067	College Biology II	CLASS	R	1840	2120	3436	4	24	TBA
BIO	102	OAC				T	1840	2120	3415	4	24	TBA
BIO	102	HY1	39935	College Biology II	HYBRD	R	0830	1120	(blank)	4	24	TBA
BIO	102	HY1				T	0830	1120	3411	4	24	TBA
BIO	102	HYA	39356	College Biology II	HYBRD	R	1840	2120	(blank)	4	24	TBA
BIO	102	HYA				T	1840	2120	3433	4	24	TBA
BIO	103	001	39204	General Biology I	CLASS	W	0830	1120	3432	4	24	TBA
BIO	103	001				M	0830	1120	3411	4	24	TBA
BIO	103	002	36709	General Biology I	CLASS	R	0830	1120	3430	4	24	TBA
BIO	103	002				T	0830	1120	3425	4	24	TBA
BIO	103	003	30071	General Biology I	CLASS	R	1130	1420	3428	4	24	TBA
BIO	103	003				T	1130	1420	3425	4	24	TBA
BIO	103	004	32677	General Biology I	CLASS	W	1130	1420	3425	4	24	TBA
BIO	103	004				M	1130	1420	3430	4	24	TBA
BIO	103	OAC	30072	General Biology I	CLASS	W	1840	2120	3425	4	24	TBA
BIO	103	OAC				M	1840	2120	3430	4	24	TBA
BIO	104	001	30074	General Biology II	CLASS	W	0830	1120	3411	4	24	TBA
BIO	104	001				M	0830	1120	3430	4	24	TBA
BIO	104	002	36710	General Biology II	CLASS	R	1130	1420	3430	4	24	TBA
BIO	104	002				T	1130	1420	3411	4	24	TBA
BIO	104	OAC	36323	General Biology II	CLASS	W	1840	2120	3430	4	24	TBA
BIO	104	OAC				M	1840	2120	3411	4	24	TBA
BIO	116	001	39835	Intro to Anatomy & Physiology	CLASS	R	1130	1420	3415	4	24	TBA
BIO	116	001				T	1130	1420	3454	4	24	TBA
BIO	121	001	30077	Anatomy & Physiology I	CLASS	W	0830	1120	3425	4	24	TBA
BIO	121	001				F	0830	1120	3430	4	24	TBA
BIO	121	002	30078	Anatomy & Physiology I	CLASS	R	0830	1120	3429	4	24	TBA
BIO	121	002				T	0830	1120	3434	4	24	TBA
BIO	121	003	34593	Anatomy & Physiology I	CLASS	R	0830	1120	3434	4	24	TBA
BIO	121	003				T	0830	1120	3429	4	24	TBA
BIO	121	004	30079	Anatomy & Physiology I	CLASS	W	1000	1250	3434	4	24	TBA

BIO	121	004				M	1000	1250	3429		4	24	TBA
BIO	121	006	30080	Anatomy & Physiology I	CLASS	R	1130	1420	3429		4	24	TBA
BIO	121	006				T	1130	1420	3434		4	24	TBA
BIO	121	007	34594	Anatomy & Physiology I	CLASS	R	1130	1420	3434		4	24	TBA
BIO	121	007				T	1130	1420	3429		4	24	TBA
BIO	121	008	34069	Anatomy & Physiology I	CLASS	W	1300	1545	3429		4	24	TBA
BIO	121	008				M	1300	1545	3434		4	24	TBA
BIO	121	009	37811	Anatomy & Physiology I	CLASS	W	1550	1835	3434		4	24	TBA
BIO	121	009				M	1550	1835	3429		4	24	TBA
BIO	121	OAC	30088	Anatomy & Physiology I	CLASS	W	1840	2120	3429		4	24	TBA
BIO	121	OAC				M	1840	2120	3434		4	24	TBA
BIO	121	OBC	30089	Anatomy & Physiology I	CLASS	R	1840	2120	3429		4	24	TBA
BIO	121	OBC				T	1840	2120	3434		4	24	TBA
BIO	122	001	30093	Anatomy and Physiology II	CLASS	R	0830	1120	3427		4	24	TBA
BIO	122	001				T	0830	1120	3432		4	24	TBA
BIO	122	002	34511	Anatomy and Physiology II	CLASS	R	0830	1120	3432		4	24	TBA
BIO	122	002				T	0830	1120	3427		4	24	TBA
BIO	122	003	30097	Anatomy and Physiology II	CLASS	W	1000	1250	3427		4	24	TBA
BIO	122	003				M	1000	1250	3432		4	24	TBA
BIO	122	004	30094	Anatomy and Physiology II	CLASS	R	1130	1420	3427		4	24	TBA
BIO	122	004				T	1130	1420	3432		4	24	TBA
BIO	122	005	34596	Anatomy and Physiology II	CLASS	R	1130	1420	3432		4	24	TBA
BIO	122	005				T	1130	1420	3427		4	24	TBA
BIO	122	006	37812	Anatomy and Physiology II	CLASS	W	1300	1545	3427		4	24	TBA
BIO	122	006				M	1300	1545	3432		4	24	TBA
BIO	122	007	34342	Anatomy and Physiology II	CLASS	W	1550	1835	3427		4	24	TBA
BIO	122	007				M	1550	1835	3432		4	24	TBA
BIO	122	009	71248	Anatomy and Physiology II	CLASS	W	1000	1250	3436		4	24	TBA
BIO	122	009				M	1000	1250	3427		4	24	TBA
BIO	122	OAC	30101	Anatomy and Physiology II	CLASS	W	1840	2120	3432		4	24	TBA
BIO	122	OAC				M	1840	2120	3427		4	24	TBA
BIO	122	OBC	39445	Anatomy and Physiology II	CLASS	R	1840	2120	3427		4	24	TBA
BIO	122	OBC				T	1840	2120	3432		4	24	TBA
BIO	125	OAC	30103	Anatomy and Phys of The Eye	CLASS	M	1840	2120	3405		3	24	TBA
BIO	210	HY1	70963	Scientific Research Methods	HYBRD	W	1130	1250	(blank)		2	24	TBA

BIO	210	HY1				M	1130	1250	(blank)	2	24	TBA
BIO	211	001	38029	Microbiology	CLASS	R	0830	1120	3428	4	24	TBA
BIO	211	001				T	0830	1120	3443	4	24	TBA
BIO	211	002	30105	Microbiology	CLASS	W	1000	1250	3443	4	24	TBA
BIO	211	002				M	1000	1250	3454	4	24	TBA
BIO	211	003	30106	Microbiology	CLASS	R	1130	1420	3443	4	24	TBA
BIO	211	003				T	1130	1420	3430	4	24	TBA
BIO	211	005	71249	Microbiology	CLASS	R	1130	1420	3426	4	24	TBA
BIO	211	005				T	1130	1420	3443	4	24	TBA
BIO	211	OAC	30109	Microbiology	CLASS	R	1840	2120	3454	4	24	TBA
BIO	211	OAC				T	1840	2120	3443	4	24	TBA
BIO	211	OBC	37835	Microbiology	CLASS	W	1840	2120	3454	4	24	TBA
BIO	211	OBC				M	1840	2120	3443	4	24	TBA
BIO	230	IS1	71288	Biotechnology Internship	CLASS		(blank)	(blank)	(blank)	4	10	TBA
BIO	230	IS1		Ecology and Evolution	CLASS		(blank)	(blank)	(blank)	4	10	TBA
BIO	241	001	37672	Pathophysiology	CLASS	MW	0830	0950	3440	3	30	TBA
BIO	241	002	71658	Pathophysiology	CLASS	W	1000	1120	3428	3	24	TBA
BIO	241	002				M	1000	1120	3440	3	24	TBA
BIO	251	002	71659	Pharmacology for Health Prof	CLASS	R	1000	1120	3454	3	24	TBA
BIO	251	002				T	1000	1120	3456	3	24	TBA
BIO	251	OAC	39053	Pharmacology for Health Prof	CLASS	W	1715	1835	3454	3	30	TBA
BIO	251	OAC				M	1715	1835	3454	3	30	TBA
BIO	251	OBC	70966	Pharmacology for Health Prof	CLASS	R	1715	1835	3428	3	30	TBA
BIO	251	OBC				T	1715	1835	3434	3	30	TBA
BUS	101	002	36454	Business Organization & Mgmt	CLASS	MW	1000	1120	4154	3	30	TBA
BUS	101	004	30117	Business Organization & Mgmt	CLASS	MW	1130	1250	3161	3	30	TBA
BUS	101	006	35061	Business Organization & Mgmt	CLASS	MW	1300	1420	3160	3	30	TBA
BUS	101	01V	30114	Business Organization & Mgmt	VILC	MW	0830	0950	(blank)	3	30	TBA
BUS	101	03V	36328	Business Organization & Mgmt	VILC	TR	1000	1120	(blank)	3	30	TBA
BUS	101	05V	34672	Business Organization & Mgmt	VILC	TR	1130	1250	(blank)	3	30	TBA
BUS	101	OAV	33438	Business Organization & Mgmt	VILC	MW	1715	1835	(blank)	3	30	TBA
BUS	101	KN1	71797	Business Organization & Mgmt	CLASS	S	0830	1130	3161	3	27	TBA

BUS	101	OL1	38511	Business Organization & Mgmt	ONLNE		(blank)	(blank)	(blank)	3	24	TBA
BUS	201	001	36757	Principles of Management	CLASS	MW	0830	0950	3161	3	30	TBA
BUS	201	002	30126	Principles of Management	CLASS	TR	0830	0950	3160	3	30	TBA
BUS	201	003	71488	Principles of Management	CLASS	MW	1000	1120	3160	3	30	TBA
BUS	201	03V	30125	Principles of Management	VILC	TR	1130	1250	(blank)	3	30	TBA
BUS	201	KN1	71796	Principles of Management	CLASS	S	0830	1130	3160	3	27	TBA
BUS	201	OL1	39041	Principles of Management	ONLNE		(blank)	(blank)	(blank)	3	30	TBA
BUS	201	OL2	71244	Principles of Management	ONLNE		(blank)	(blank)	(blank)	3	30	TBA
BUS	203	OAC	39655	Intro. to Entrepreneurship	CLASS	MW	1715	1835	3161	3	30	TBA
BUS	204	001	30129	Intro to Org Behavior in Bus	CLASS	TR	1000	1120	3160	3	30	TBA
BUS	204	OL1	39121	Intro to Org Behavior in Bus	ONLNE		(blank)	(blank)	(blank)	3	30	TBA
BUS	207	OL1	70863	Leadership & Supervision	ONLNE		(blank)	(blank)	(blank)	3	30	TBA
BUS	211	001	33082	Principles of Marketing	CLASS	MW	1130	1250	3160	3	30	TBA
BUS	211	002	39642	Principles of Marketing	CLASS	TR	1300	1420	3160	3	30	TBA
BUS	211	OAC	30131	Principles of Marketing	CLASS	R	1840	2120	3160	3	30	TBA
BUS	211	OL1	71300	Principles of Marketing	ONLNE		(blank)	(blank)	(blank)	3	30	TBA
BUS	213	01V	71795	Principles of Selling	VILC	MW	1000	1120	(blank)	3	24	TBA
BUS	231	001	70955	Global Business I	CLASS	TR	1000	1120	3161	3	30	TBA
BUS	231	OAC	70433	Global Business I	CLASS	TR	1715	1835	3160	3	30	TBA
BUS	231	OL1	70956	Global Business I	ONLNE		(blank)	(blank)	(blank)	3	30	TBA
BUS	251	001	34729	Business Law I	CLASS	MW	1000	1120	3161	3	30	TBA
CET	111	OAC	37619	Construction Methd & Materials	CLASS	MW	1715	1835	T103	3	20	TBA
CET	221	OAC	70807	Hydraulics and Drainage	CLASS	MW	1030	1245	T103	3	20	TBA
CET	231	OAC	70616	Structures	CLASS	MW	1925	2115	T103	3	20	TBA
CET	251	OAC	70617	CET Seminar	CLASS	TR	1930	2050	T103	2	20	TBA
CHM	101	001	30213	College Chemistry I	CLASS	W	0830	1120	3437	4	24	TBA
CHM	101	001				M	0830	1120	3426	4	24	TBA

CHM	101	002	30214	College Chemistry I	CLASS	R	0830	1120	3437		4	24	TBA
CHM	101	002				T	0830	1120	3440		4	24	TBA
CHM	101	003	34071	College Chemistry I	CLASS	W	1000	1250	3440		4	24	TBA
CHM	101	003				M	1000	1250	3437		4	24	TBA
CHM	101	004	34600	College Chemistry I	CLASS	W	1300	1545	3440		4	24	TBA
CHM	101	004				M	1300	1545	3437		4	24	TBA
CHM	101	005	30216	College Chemistry I	CLASS	R	1550	1835	3437		4	24	TBA
CHM	101	005				T	1550	1835	3440		4	24	TBA
CHM	101	006	70903	College Chemistry I	CLASS	R	1130	1420	3438		4	24	TBA
CHM	101	006				T	1130	1420	3439		4	24	TBA
CHM	101	007	71491	College Chemistry I	CLASS	W	1000	1250	3433		4	24	TBA
CHM	101	007				M	1000	1250	3434		4	24	TBA
CHM	101	OAC	38033	College Chemistry I	CLASS	W	1840	2120	3437		4	24	TBA
CHM	101	OAC				M	1840	2120	3438		4	24	TBA
CHM	103	001	38388	General Chemistry I	CLASS	W	0830	1120	3439		4	24	TBA
CHM	103	001				M	0830	1120	3428		4	24	TBA
CHM	103	002	34969	General Chemistry I	CLASS	R	0830	1120	3438		4	24	TBA
CHM	103	002				T	0830	1120	3431		4	24	TBA
CHM	103	003	30223	General Chemistry I	CLASS	W	1000	1250	3431		4	24	TBA
CHM	103	003				M	1000	1250	3438		4	24	TBA
CHM	103	005	30224	General Chemistry I	CLASS	R	1130	1420	3431		4	24	TBA
CHM	103	005				T	1130	1420	3438		4	24	TBA
CHM	103	006	34603	General Chemistry I	CLASS	W	1300	1545	3438		4	24	TBA
CHM	103	006				M	1300	1545	3431		4	24	TBA
CHM	103	007	34076	General Chemistry I	CLASS	R	1550	1835	3439		4	24	TBA
CHM	103	007				T	1550	1835	3436		4	24	TBA
CHM	103	OAC	35075	General Chemistry I	CLASS	R	1840	2120	3438		4	24	TBA
CHM	103	OAC				T	1840	2120	3431		4	24	TBA
CHM	103	OBC	38037	General Chemistry I	CLASS	W	1840	2120	3438		4	24	TBA
CHM	103	OBC				M	1840	2120	3431		4	24	TBA
CHM	104	001	38038	General Chemistry II	CLASS	R	0830	1120	3431		4	24	TBA
CHM	104	001				T	0830	1120	3438		4	24	TBA
CHM	104	002	30226	General Chemistry II	CLASS	W	1300	1545	3431		4	24	TBA
CHM	104	002				M	1300	1545	3438		4	24	TBA
CHM	104	003	39152	General Chemistry II	CLASS	R	1550	1835	3431		4	24	TBA
CHM	104	003				T	1550	1835	3438		4	24	TBA

CHM	204	001	30230	Organic Chemistry II	CLASS	R	1130	1420	3439	4	24	TBA
CHM	204	001				T	1130	1420	3436	4	24	TBA
CIN	101	001	71348	Intro to the Art of Film II	CLASS	MW	0830	0950	4104	3	30	TBA
CIN	101	001		Intro. to the Art of Film	CLASS	MW	0830	0950	4104	3	30	TBA
CIN	101	002	71349	Intro to the Art of Film II	CLASS	TR	1000	1120	4104	3	30	TBA
CIN	101	002		Intro. to the Art of Film	CLASS	TR	1000	1120	4104	3	30	TBA
CIN	101	ACV	71350	Intro to the Art of Film II	VILC	T	1840	2120	(blank)	3	30	TBA
CIN	101	ACV		Intro. to the Art of Film	VILC	T	1840	2120	(blank)	3	30	TBA
CIN	101	OL1	70988	Intro to the Art of Film II	ONLNE		(blank)	(blank)	(blank)	3	30	TBA
CIN	101	OL1		Intro. to the Art of Film	ONLNE		(blank)	(blank)	(blank)	3	30	TBA
CIN	103	001	71352	History of African Amer. Film	CLASS	TR	1130	1250	4104	3	30	TBA
CIN	103	ACV	71353	History of African Amer. Film	VILC	R	1840	2120	(blank)	3	30	TBA
CIS	107	001	71681	Computer Literacy	CLASS	TR	1300	1420	T211	3	24	TBA
CIS	131	001	71188	Micro Computers in Business	CLASS	MW	1000	1120	T211	3	24	TBA
CIS	131	002	30257	Micro Computers in Business	CLASS	TR	1000	1120	T105	3	24	TBA
CIS	131	004	71682	Micro Computers in Business	CLASS	TR	1300	1420	T105	3	24	TBA
CIS	131	005	35062	Micro Computers in Business	CLASS	MW	1130	1250	T105	3	24	TBA
CIS	131	007	71191	Micro Computers in Business	CLASS	MW	1300	1420	2114	3	24	TBA
CIS	131	03H	71190	Micro Computers in Business	HYBRD	R	1130	1250	(blank)	3	24	TBA
CIS	131	03H				T	1130	1250	T206	3	24	TBA
CIS	131	OAC	39923	Micro Computers in Business	CLASS	R	1840	2120	2114	3	24	TBA
CIS	131	OL1	70200	Micro Computers in Business	ONLNE		(blank)	(blank)	(blank)	3	30	TBA
CIS	131	OL2	71192	Micro Computers in Business	ONLNE		(blank)	(blank)	(blank)	3	30	TBA
CIS	212	OL1	70623	Systems Analysis and Design	ONLNE		(blank)	(blank)	(blank)	3	30	TBA
CIS	215	OL1	36816	Data Communications	ONLNE		(blank)	(blank)	(blank)	3	30	TBA
CJI	101	01V	34616	Intro to Criminal Justice	VILC	TR	1130	1250	(blank)	3	30	TBA
CJI	101	02V	39925	Intro to Criminal Justice	VILC	MW	1000	1120	(blank)	3	30	TBA
CJI	101	03V	70091	Intro to Criminal Justice	VILC	MW	1300	1420	(blank)	3	30	TBA
CJI	101	OAC	70808	Intro to Criminal Justice	CLASS	W	1840	2120	3161	3	30	TBA

CJI	102	001	35943	Police Role in the Community	CLASS	MW	1300	1420	4133		3	30	TBA
CJI	103	IS1	35939	Probation and Parole	CLASS		(blank)	(blank)	(blank)		3	1	TBA
CJI	121	01V	30289	Introduction to Corrections	VILC	MW	0830	0950	(blank)		3	30	TBA
CJI	136	01V	35938	Criminology	VILC	MW	1130	1250	(blank)		3	30	TBA
CJI	202	01V	32874	Crime and Delinquency	VILC	TR	1000	1120	(blank)		3	30	TBA
CJI	202	OAV	39057	Crime and Delinquency	VILC	MW	1715	1835	(blank)		3	30	TBA
CJI	205	001	35110	Introduction to Criminal Law	CLASS	MW	1000	1120	3162		3	30	TBA
CJI	205	OAV	70809	Introduction to Criminal Law	VILC	R	1840	2120	(blank)		3	30	TBA
CJI	210	OAV	35941	Forensic Science	VILC	W	1840	2120	(blank)		3	30	TBA
CJI	211	S1C	36843	Counseling-Addicted Offender	CLASS	R	1840	2120	3161		3	10	TBA
CMS	110	001	37389	Fundamentals of TV Production	CLASS	W	1300	1625	3130		3	20	TBA
CMS	110	IS1	71656	Fundamentals of TV Production	CLASS		(blank)	(blank)	(blank)		3	5	TBA
CMS	113	001	33888	Writing for Film & Television	CLASS	MW	1000	1120	3130		3	20	TBA
CMS	121	001	36807	Fundamentals of Filmmaking	CLASS	M	1300	1625	3130		3	20	TBA
CMS	136	001	71622	Audio Production	CLASS	R	1130	1420	3130		3	20	TBA
CMS	136	001		Radio Broadcasting&Production	CLASS	R	1130	1420	3130		3	20	TBA
CMS	136	001		Radio Broadcasting/Production	CLASS	R	1130	1420	3130		3	20	TBA
CSC	100	01V	32443	Fundamental of Computer Scienc	VILC	TR	0830	0950	(blank)		3	30	TBA
CSC	100	HY1	36817	Fundamental of Computer Scienc	HYBRD	R	1300	1420	(blank)		3	24	TBA
CSC	100	HY1				T	1300	1420	T206		3	24	TBA
CSC	104	001	70157	Microcomputer Fundamentals	CLASS	MW	1000	1120	T105		3	24	TBA
CSC	104	001		Network Fundamentals	CLASS	MW	1000	1120	T105		3	24	TBA
CSC	104	OAC	71405	Microcomputer Fundamentals	CLASS	MW	1715	1835	T105		3	24	TBA
CSC	104	OAC		Network Fundamentals	CLASS	MW	1715	1835	T105		3	24	TBA
CSC	104	OL1	71683	Microcomputer Fundamentals	ONLNE		(blank)	(blank)	(blank)		3	24	TBA
CSC	104	OL1		Network Fundamentals	ONLNE		(blank)	(blank)	(blank)		3	24	TBA
CSC	106	001	70624	Roadmap to Computing Engineers	CLASS	F	0830	1205	T105		3	24	TBA
CSC	112	001	30019	Computer Prog. for Engr. Tech.	CLASS	T	1600	1840	T111		3	24	TBA
CSC	113	OAC	39358	Intro Linux/UNIX Operating Sys	CLASS	MW	1715	1900	T111		4	24	TBA
CSC	114	001	71684	Computer Networks I	CLASS	MW	0800	0950	T105		4	24	TBA

CSC	114	OAC	39359	Computer Networks I	CLASS	MW	1925	2110	T105	4	24	TBA
CSC	116	OAC	39360	Intro to Comp/Network Security	CLASS	TR	1925	2110	T105	4	24	TBA
CSC	116	OL1	71685	Intro to Comp/Network Security	ONLNE		(blank)	(blank)	(blank)	4	24	TBA
CSC	121	001	70625	Computer Science I	CLASS	MW	0805	0950	T111	3	24	TBA
CSC	121	002	70626	Computer Science I	CLASS	MW	1300	1445	T105	3	24	TBA
CSC	121	OAC	71514	Computer Science I	CLASS	MW	1925	2110	T206	3	24	TBA
CSC	122	001	70627	Computer Science II	CLASS	MWF	1000	1120	T206	3	24	TBA
CSC	122	OAC	71515	Computer Science II	CLASS	TR	1925	2110	T206	3	24	TBA
CSC	137	001	70629	Intro. to Programming in Java	CLASS	MWF	1300	1420	T206	3	24	TBA
CSC	137	OAC	70630	Intro. to Programming in Java	CLASS	TR	1715	1905	T211	3	24	TBA
CSC	151	IS1	71406	Intro Develop Web Applications	CLASS		(blank)	(blank)	(blank)	3	5	TBA
CSC	214	OAC	39467	Computer Networks II	CLASS	MW	1715	1900	T211	4	24	TBA
CSC	221	001	70631	Computer Sys and Architecture	CLASS	MWF	0830	0950	T211	3	24	TBA
CSC	223	01V	70632	Ethics and Computer Technology	VILC	MW	0830	0950	(blank)	3	30	TBA
CSC	223	03V	71407	Ethics and Computer Technology	VILC	MW	1000	1120	(blank)	3	30	TBA
CSC	225	001	70633	Data Structures	CLASS	MWF	1130	1250	T211	3	24	TBA
CSC	226	001	70905	NetworkDefense&CounterMeasures	CLASS	MW	1925	2110	T211	4	24	TBA
CSC	228	001	37623	Operating Systems	CLASS	MWF	1300	1420	T211	4	24	TBA
CSC	230	OAC	71408	Computer & Internet Forensics	CLASS	TR	1925	2110	T211	4	24	TBA
CSC	231	001	35493	Database Design	CLASS	MW	1525	1710	T111	4	24	TBA
CSC	232	IS1	71409	Advanced Database Management	CLASS		(blank)	(blank)	(blank)	4	5	TBA
CSC	237	IS1	70634	Enterprise Java Programming	CLASS		(blank)	(blank)	(blank)	4	5	TBA
CSC	250	IS1	70900	Infor. Tech. Capstone Project	CLASS		(blank)	(blank)	(blank)	3	5	TBA
CSC	251	IS1	71442	Web Application Development	CLASS		(blank)	(blank)	(blank)	4	5	TBA
CSC	253	OAC	70899	Intro. System & Cloud Admin.	CLASS	TR	1715	1900	T105	4	24	TBA
CSC	255	IS1	71410	Mobile Application Development	CLASS		(blank)	(blank)	(blank)	4	5	TBA

CSS	101	IS1	71263	College Success Seminar	CLASS		(blank)	(blank)	(blank)	3	3	TBA
DRA	102	001	71607	Fundamentals of Acting II	CLASS	MW	1000	1120	4104	3	20	TBA
DRA	105	001	71608	Directing and Staging	CLASS	MW	1130	1250	4104	3	20	TBA
DRA	106	OL1	71609	Playwriting	ONLNE		(blank)	(blank)	(blank)	3	20	TBA
ECE	101	01V	70827	Early Care and Education I	VILC	TR	1840	2030	(blank)	4	15	TBA
ECE	102	001	70636	Early Care and Education II	CLASS	MW	1840	2030	4135	4	30	TBA
ECE	103	001	70637	Early Care & Edu. Field Exper.	CLASS		(blank)	(blank)	(blank)	3	15	TBA
ECO	101	002	30337	Principles of Economics I	CLASS	TR	0830	0950	4157	3	30	TBA
ECO	101	004	34433	Principles of Economics I	CLASS	MW	1130	1250	4157	3	30	TBA
ECO	101	006	37638	Principles of Economics I	CLASS	MW	1425	1545	4157	3	30	TBA
ECO	101	01V	37637	Principles of Economics I	VILC	MW	0830	0950	(blank)	3	30	TBA
ECO	101	03V	30338	Principles of Economics I	VILC	TR	1000	1120	(blank)	3	30	TBA
ECO	101	05V	30339	Principles of Economics I	VILC	TR	1300	1420	(blank)	3	30	TBA
ECO	101	OAC	38524	Principles of Economics I	CLASS	MW	1715	1835	3160	3	30	TBA
ECO	101	0BV	32795	Principles of Economics I	VILC	M	1840	2120	(blank)	3	30	TBA
ECO	101	OL1	38515	Principles of Economics I	ONLNE		(blank)	(blank)	(blank)	3	30	TBA
ECO	102	002	30342	Principles of Economics II	CLASS	TR	1130	1250	4157	3	30	TBA
ECO	102	01V	33904	Principles of Economics II	VILC	MW	1000	1120	(blank)	3	30	TBA
ECO	102	0BV	30344	Principles of Economics II	VILC	W	1840	2120	(blank)	3	30	TBA
ECO	102	OL1	39421	Principles of Economics II	ONLNE		(blank)	(blank)	(blank)	3	24	TBA
EDU	101	001	30345	Introduction to Education	CLASS	MW	1130	1250	3162	3	30	TBA
EDU	101	002	71668	Introduction to Education	CLASS	MW	0830	0950	3162	3	30	TBA
EDU	101	01V	71669	Introduction to Education	VILC	TR	1130	1250	(blank)	3	30	TBA
EDU	101	02V	71670	Introduction to Education	VILC	TR	1300	1420	(blank)	3	30	TBA
EDU	101	OBC	33905	Introduction to Education	CLASS	R	1840	2120	4132	3	30	TBA
EDU	101	OL1	39422	Introduction to Education	ONLNE		(blank)	(blank)	(blank)	3	24	TBA
EDU	201	001	71671	Education in Urban Environment	CLASS	TR	1715	1835	4133	3	30	TBA

EDU	201	01V	32944	Education in Urban Environment	VILC	MW	1000	1120	(blank)	3	30	TBA
EDU	203	01V	71672	Children with Special Needs	VILC	MW	1130	1250	(blank)	3	30	TBA
EDU	203	OAC	34541	Children with Special Needs	CLASS	W	1840	2120	3162	3	30	TBA
EDU	205	001	71396	Early Childhood Education	CLASS	TR	1000	1120	3162	3	27	TBA
EDU	205	002	71674	Early Childhood Education	CLASS	F	1840	2120	4130	3	30	TBA
EDU	205	01V	71673	Early Childhood Education	VILC	TR	1000	1120	(blank)	3	30	TBA
EDU	233	01V	71395	Education Seminar I	VILC	TR	1830	1950	(blank)	3	27	TBA
EDU	233	02V	71675	Education Seminar I	VILC	TR	1840	2000	(blank)	3	30	TBA
ELC	115	001	70638	DC/AC Circuit Analysis	CLASS	MW	1300	1510	T106	3	18	TBA
ELC	115	001		Electric Circuits I	CLASS	MW	1300	1510	T106	3	18	TBA
ELC	115	001		Electric Circuits: DC and AC	CLASS	MW	1300	1510	T106	3	18	TBA
ELC	116	OAC	71686	Electric Circuits II	CLASS	MW	1715	1955	T106	4	18	TBA
ELC	120	001	71412	Electronics I	CLASS	MW	1000	1210	T106	3	18	TBA
ELC	120	001		Fundamentals of Analog ELC	CLASS	MW	1000	1210	T106	3	18	TBA
ELC	228	001	70640	Intro to Microprocessors	CLASS	TR	1000	1210	T106	3	18	TBA
ELC	230	OAC	71687	Circuits & Systems for Engr.	CLASS	TR	1715	1835	T106	3	18	TBA
ELC	250	001	71688	Electric Design	CLASS	TR	1300	1350	T106	2	18	TBA
ENG	101	002	30554	College Composition I	CLASS	MW	0830	0950	2111	3	30	TBA
ENG	101	D01	71021	College Composition I	CLASS	MW	0830	0950	2105	3	30	TBA
ENG	099	D01	71017	Composition Skills Support	CLASS	F	0830	0950	2106	1.5	30	TBA
				Register for all of the above sections								
ENG	101	D02	71022	College Composition I	CLASS	TR	1000	1120	2110	3	30	TBA
ENG	099	D02	71023	Composition Skills Support	CLASS	M	1000	1120	2106	1.5	30	TBA
				Register for all of the above sections								
ENG	101	D03	71041	College Composition I	CLASS	MW	1715	1835	2107	3	30	TBA
ENG	099	D03	71040	Composition Skills Support	CLASS	F	1715	1835	2107	1.5	30	TBA
				Register for all of the above sections								
ENG	101	D04	71026	College Composition I	CLASS	MW	1425	1545	2106	3	30	TBA
ENG	099	D04	71027	Composition Skills Support	CLASS	F	1425	1545	2106	1.5	30	TBA
				Register for all of the above sections								
ENG	101	D06	71030	College Composition I	CLASS	TR	1300	1420	2106	3	30	TBA
ENG	099	D06	71031	Composition Skills Support	CLASS	M	1300	1420	2108	1.5	30	TBA
				Register for all of the above sections								

ENG	101	D08	71032	College Composition I	CLASS	TR	1550	1710	2107	3	30	TBA
ENG	099	D08	71033	Composition Skills Support	CLASS	M	1550	1710	2108	1.5	30	TBA
				Register for all of the above sections								
ENG	101	D11	70578	College Composition I	CLASS	TR	0830	0950	2106	3	30	TBA
ENG	099	D11	71020	Composition Skills Support	CLASS	M	0830	0950	2112	1.5	30	TBA
				Register for all of the above sections								
ENG	101	D16	71053	College Composition I	CLASS	TR	1715	1835	2106	3	30	TBA
ENG	099	D16	71052	Composition Skills Support	CLASS	M	1715	1835	2106	1.5	30	TBA
				Register for all of the above sections								
ENG	101	D17	71054	College Composition I	CLASS	TR	1130	1250	2101B	3	30	TBA
ENG	099	D17	71055	Composition Skills Support	CLASS	F	1130	1250	2107	1.5	30	TBA
				Register for all of the above sections								
ENG	101	DV1	71024	College Composition I	VILC	MW	1130	1250	(blank)	3	30	TBA
ENG	099	DV1	71025	Composition Skills Support	VILC	F	1130	1250	(blank)	1.5	30	TBA
				Register for all of the above sections								
ENG	101	DV2	71034	College Composition I	VILC	TR	1715	1835	(blank)	3	30	TBA
ENG	099	DV2	71035	Composition Skills Support	VILC	F	1715	1835	(blank)	1.5	30	TBA
				Register for all of the above sections								
ENG	101	DV7	71068	College Composition I	VILC	MW	0700	0820	(blank)	3	30	TBA
ENG	099	DV7	71069	Composition Skills Support	VILC	F	0700	0820	(blank)	1.5	30	TBA
				Register for all of the above sections								
ENG	101	006	30560	College Composition I	CLASS	TR	1000	1120	2106	3	30	TBA
ENG	101	008	35599	College Composition I	CLASS	MW	1130	1250	2105	3	30	TBA
ENG	101	015	70768	College Composition I	CLASS	MW	1550	1710	2101A	3	30	TBA
ENG	101	07V	35255	College Composition I	VILC	TR	1300	1420	(blank)	3	30	TBA
ENG	101	0BV	30571	College Composition I	VILC	W	1840	2120	(blank)	3	30	TBA
ENG	101	KN1	71629	College Composition I	CLASS	S	0830	1120	(blank)	3	30	TBA
ENG	101	OL1	38516	College Composition I	ONLNE		(blank)	(blank)	(blank)	3	30	TBA
ENG	101	OL2	71628	College Composition I	ONLNE		(blank)	(blank)	(blank)	3	30	TBA
ENG	102	002	39197	College Composition II	CLASS	TR	0830	0950	2101A	3	30	TBA
ENG	102	003	34297	College Composition II	CLASS	F	0830	1120	2115	3	30	TBA
ENG	102	004	30588	College Composition II	CLASS	MW	1000	1120	2105	3	30	TBA
ENG	102	005	30587	College Composition II	CLASS	MW	1130	1250	2101B	3	30	TBA

ENG	102	009	30585	College Composition II	CLASS	TR	1000	1120	2101A	3	30	TBA
ENG	102	012	39354	College Composition II	CLASS	TR	1300	1420	2101A	3	30	TBA
ENG	102	014	33593	College Composition II	CLASS	TR	1550	1710	2105	3	30	TBA
ENG	102	016	30592	College Composition II	CLASS	MW	1425	1545	2109	3	30	TBA
ENG	102	01V	30583	College Composition II	VILC	TR	0700	0820	(blank)	3	30	TBA
ENG	102	02V	30589	College Composition II	VILC	TR	1130	1250	(blank)	3	30	TBA
ENG	102	07V	30591	College Composition II	VILC	MW	0830	0950	(blank)	3	30	TBA
ENG	102	OAC	30598	College Composition II	CLASS	MW	1715	1835	2101B	3	30	TBA
ENG	102	OBV	30599	College Composition II	VILC	R	1840	2120	(blank)	3	30	TBA
ENG	102	ODV	32811	College Composition II	VILC	T	1840	2120	(blank)	3	30	TBA
ENG	102	11V	30590	College Composition II	VILC	MW	1300	1420	(blank)	3	30	TBA
ENG	102	KN1	30600	College Composition II	CLASS	S	1130	1420	2102	3	30	TBA
ENG	102	OL1	38517	College Composition II	ONLNE		(blank)	(blank)	(blank)	3	30	TBA
ENG	102	OL2	39940	College Composition II	ONLNE		(blank)	(blank)	(blank)	3	30	TBA
ENG	102	OL3	71255	College Composition II	ONLNE		(blank)	(blank)	(blank)	3	30	TBA
ENG	102	OL4	71487	College Composition II	ONLNE		(blank)	(blank)	(blank)	3	30	TBA
ENG	105	OL1	70666	Technical Writing	ONLNE		(blank)	(blank)	(blank)	3	30	TBA
ENG	109	001	36387	Effective Speech	CLASS	TR	1550	1710	2101B	3	30	TBA
ENG	109	002	71340	Effective Speech	CLASS	MW	1000	1120	2101B	3	30	TBA
ENG	109	01V	71621	Effective Speech	VILC	MW	1425	1545	(blank)	3	30	TBA
ENG	109	02V	30616	Effective Speech	VILC	TR	1000	1120	(blank)	3	30	TBA
ENG	109	OL1	71341	Effective Speech	ONLNE		(blank)	(blank)	(blank)	3	30	TBA
ENG	205	001	30622	Western Literary Tradition	CLASS	MW	1550	1710	2101B	3	30	TBA
ENG	205	001		World Literature I	CLASS	MW	1550	1710	2101B	3	30	TBA
ENG	215	007	39432	Modern Literary Masterpieces	CLASS	MW	1130	1250	2101A	3	30	TBA
ENG	215	007		World Literature II	CLASS	MW	1130	1250	2101A	3	30	TBA
ENG	215	OL1	39406	Modern Literary Masterpieces	ONLNE		(blank)	(blank)	(blank)	3	30	TBA
ENG	215	OL1		World Literature II	ONLNE		(blank)	(blank)	(blank)	3	30	TBA

ENG	225	001	71623	Literature & Film	CLASS	TR	1130	1250	2102		3	30	TBA
ENG	225	002	71624	Literature & Film	CLASS	F	1000	1250	2101B		3	30	TBA
ENG	237	001	71328	Survey of Afro-American Lit	CLASS	MW	0830	0950	2107		3	30	TBA
ENG	238	001	32911	Major Black American Writers	CLASS	TR	1300	1420	2110		3	30	TBA
ENG	254	OL1	71625	Survey of Poetry	ONLNE		(blank)	(blank)	(blank)		3	30	TBA
ENG	256	OL1	71626	Survey of the Novel	ONLNE		(blank)	(blank)	(blank)		3	30	TBA
ENG	263	001	71326	Image of Women in Literature	CLASS	MW	1000	1120	2108		3	30	TBA
ENG	263	001		Survey of Women's Literature	CLASS	MW	1000	1120	2108		3	30	TBA
ENG	264	OBV	71324	Contemporary Women's Lit.	VILC	W	1840	2120	(blank)		3	30	TBA
ENG	264	OBV		Contemporary Women's Writing	VILC	W	1840	2120	(blank)		3	30	TBA
ENG	270	OL1	71627	Children's Literature	ONLNE		(blank)	(blank)	(blank)		3	30	TBA
ENR	100	001	71765	Fund. of Engineering Design	CLASS	T	1000	1250	(blank)		2	20	TBA
ENR	100	001		Intro to Eng Tech and Sciences	CLASS	T	1000	1250	(blank)		2	20	TBA
ENR	100	002	70667	Fund. of Engineering Design	CLASS	F	1000	1250	T111		2	20	TBA
ENR	100	002		Intro to Eng Tech and Sciences	CLASS	F	1000	1250	T111		2	20	TBA
ENR	103	001	71689	Engineering Graphics	CLASS	T	1550	1840	T206		2	20	TBA
ENR	103	001		Engr. Graphics & Intro. to CAD	CLASS	T	1550	1840	T206		2	20	TBA
ENR	103	002	32504	Engineering Graphics	CLASS	R	1000	1250	T211		2	20	TBA
ENR	103	002		Engr. Graphics & Intro. to CAD	CLASS	R	1000	1250	T211		2	20	TBA
ENR	105	001	36821	Appld Computer Asst Drafting	CLASS	F	1300	1550	T111		2	20	TBA
ENR	105	001		Applied Computer Aided Design	CLASS	F	1300	1550	T111		2	20	TBA
ENR	105	OAC	70668	Appld Computer Asst Drafting	CLASS	R	1715	1955	T111		2	20	TBA
ENR	105	OAC		Applied Computer Aided Design	CLASS	R	1715	1955	T111		2	20	TBA
ENR	110	OAC	38944	Mechanics	CLASS	MW	1300	1420	T103		3	18	TBA
ENR	110	OAC		Mechanics I	CLASS	MW	1300	1420	T103		3	18	TBA
ENR	110	OAC		Statics for Technology	CLASS	MW	1300	1420	T103		3	18	TBA
ENR	211	001	37762	Engineer Mechanics I - Statics	CLASS	TR	1300	1420	T103		3	24	TBA
ENR	212	001	34734	Engineer Mechanics II-Dynamics	CLASS	MW	1300	1420	T114		3	24	TBA
ENR	220	OAC	70669	Mechanics of Materials	CLASS	TR	1700	1915	T114		3	18	TBA
ENR	221	001	71478	Strength of Materials	CLASS	TR	0730	0945	T114		3	18	TBA
ESL	031	001	70362	ESL Intensive Exp Amer Culture	CLASS	F	0830	1120	(blank)		3	30	TBA
ESL	031	002	71000	ESL Intensive Exp Amer Culture	CLASS	F	1130	1420	2116		3	24	TBA

ESL	031	OAC	70368	ESL Intensive Exp Amer Culture	CLASS	TR	1715	1835	2113	3	30	TBA
ESL	032	001	70363	Intensive Exp List. Comp/Speak	CLASS	MTWR	1000	1120	2113	6	30	TBA
ESL	032	002	71001	Intensive Exp List. Comp/Speak	CLASS	MTWR	0830	0950	2109	6	24	TBA
ESL	032	OAC	70369	Intensive Exp List. Comp/Speak	CLASS	TR	1840	2120	2113	6	30	TBA
ESL	033	001	70364	Intensive Exp. Rdg. & Writing	CLASS	MTWR	0830	0950	2108	6	30	TBA
ESL	033	002	71002	Intensive Exp. Rdg. & Writing	CLASS	MTWR	1000	1120	2116	6	24	TBA
ESL	033	OAC	70370	Intensive Exp. Rdg. & Writing	CLASS	MW	1840	2120	2116	6	30	TBA
ESL	041	001	70373	ESL Basic Academic Grammar	CLASS	MTR	0830	0950	2115	4.5	24	TBA
ESL	041	002	71003	ESL Basic Academic Grammar	CLASS	MTR	1000	1120	4135	4.5	24	TBA
ESL	041	003	71378	ESL Basic Academic Grammar	CLASS	MTR	1130	1250	2107	4.5	24	TBA
ESL	041	OAC	70377	ESL Basic Academic Grammar	CLASS	MW	1925	2130	2109	4.5	24	TBA
ESL	043	001	70374	ESL Reading, Writing & Comm. I	CLASS	MTWR	1000	1120	2111	6	24	TBA
ESL	043	002	71004	ESL Reading, Writing & Comm. I	CLASS	MTWR	1130	1250	2118	6	24	TBA
ESL	043	003	71379	ESL Reading, Writing & Comm. I	CLASS	MTWR	1300	1420	2107	6	24	TBA
ESL	043	OAC	70378	ESL Reading, Writing & Comm. I	CLASS	TR	1840	2120	2115	6	24	TBA
ESL	051	001	70379	Form and Function of English	CLASS	MW	1130	1250	2115	3	24	TBA
ESL	051	OAC	70380	Form and Function of English	CLASS	MW	1715	1835	2101A	3	24	TBA
ESL	053	001	70381	ESL Reading, Writing & Comm II	CLASS	MTWR	0830	0950	2118	6	24	TBA
ESL	053	002	70382	ESL Reading, Writing & Comm II	CLASS	MTWR	1000	1120	4158	6	24	TBA
ESL	053	OAC	70383	ESL Reading, Writing & Comm II	CLASS	MW	1840	2120	2101A	6	24	TBA
ESL	062	001	70390	Active Listening and Speaking	CLASS	MW	1300	1420	2110	3	24	TBA
ESL	063	OAC	70387	ESL Rdg., Writing & Comm. III	CLASS	MW	1840	2120	2118	6	24	TBA
ESL	063	OAC		Immersion Culture & Speaking	CLASS	MW	1840	2120	2118	6	24	TBA
ESL	063	HY1	70384	ESL Rdg., Writing & Comm. III	HYBRD	MW	1000	1120	(blank)	6	24	TBA
ESL	063	HY1				TR	1000	1120	2107	6	24	TBA
ESL	063	HY1		Immersion Culture & Speaking	HYBRD	MW	1000	1120	(blank)	6	24	TBA
ESL	063	HY1				TR	1000	1120	2107	6	24	TBA
FIN	101	001	71170	Introduction to Finance	CLASS	TR	1000	1120	4157	3	30	TBA

FIN	101	OAV	39933	Introduction to Finance	VILC	TR	1715	1835	(blank)	3	30	TBA
FIN	201	001	71388	Money and Banking	CLASS	MW	1130	1250	4154	3	30	TBA
FIN	201	IS1	70145	Money and Banking	CLASS		(blank)	(blank)	(blank)	3	5	TBA
FIN	207	OAC	39578	Principles of Investments	CLASS	MW	1840	2000	3160	3	30	TBA
FIN	209	01V	71461	International Finance	VILC	R	1000	1240	(blank)	3	30	TBA
FIN	209	IS1	39934	International Finance	CLASS		(blank)	(blank)	(blank)	3	5	TBA
FIN	211	001	39939	Fin.Sem./Exp.& Directed Study	CLASS	TR	1300	1420	4157	3	30	TBA
FIN	211	HR1	70727	Fin.Sem./Exp.& Directed Study	CLASS		(blank)	(blank)	(blank)	3	2	TBA
FRN	101	001	35513	Elementary French	CLASS	MW	1000	1120	2115	3	30	TBA
FRN	101	001		Elementary French I	CLASS	MW	1000	1120	2115	3	30	TBA
FRN	101	OL1	71358	Elementary French	ONLNE		(blank)	(blank)	(blank)	3	30	TBA
FRN	101	OL1		Elementary French I	ONLNE		(blank)	(blank)	(blank)	3	30	TBA
FRN	102	OL1	71359	Elementary French II	ONLNE		(blank)	(blank)	(blank)	3	30	TBA
FYE	097	002	71081	First Year Experience	CLASS	F	1000	1150	4156	2	24	TBA
FYE	097	003	71714	First Year Experience	CLASS	MW	1000	1055	4156	2	24	TBA
FYE	097	004	71084	First Year Experience	CLASS	F	1300	1450	4156	2	24	TBA
FYE	097	006	71086	First Year Experience	CLASS	MW	1430	1525	4156	2	24	TBA
FYE	097	010	71092	First Year Experience	CLASS	TR	1000	1055	4156	2	24	TBA
FYE	097	012	71095	First Year Experience	CLASS	TR	1130	1225	4156	2	24	TBA
FYE	097	018	71104	First Year Experience	CLASS	F	1130	1325	3161	2	24	TBA
FYE	097	03V	71082	First Year Experience	VILC	F	1130	1320	(blank)	2	24	TBA
FYE	097	05V	71085	First Year Experience	VILC	F	1300	1420	(blank)	2	24	TBA
FYE	097	08V	71093	First Year Experience	VILC	TR	1000	1055	(blank)	2	24	TBA
FYE	097	09V	71091	First Year Experience	VILC	W	0830	0925	(blank)	2	24	TBA
FYE	097	10V	71106	First Year Experience	VILC	M	1840	2030	(blank)	2	24	TBA
FYE	097	15V	71100	First Year Experience	VILC	TR	1715	1810	(blank)	2	24	TBA
FYE	097	17V	71102	First Year Experience	VILC	W	1925	2115	(blank)	2	24	TBA
FYE	097	K1V	71108	First Year Experience	VILC	S	1300	1450	(blank)	2	24	TBA

FYE	097	OL1	71712	First Year Experience	ONLNE		(blank)	(blank)	(blank)	2	24	TBA
FYE	097	OL2	71713	First Year Experience	ONLNE		(blank)	(blank)	(blank)	2	24	TBA
GEO	102	001	70160	Geology II	CLASS	TR	0830	1120	3442	4	26	TBA
GEO	102	001		Surface Proc.&Natural Disaster	CLASS	TR	0830	1120	3442	4	26	TBA
GEO	102	002	70967	Geology II	CLASS	MW	1130	1420	3442	4	26	TBA
GEO	102	002		Surface Proc.&Natural Disaster	CLASS	MW	1130	1420	3442	4	26	TBA
HLT	101	ISV	30774	Healthful Living	VILC		(blank)	(blank)	(blank)	3	7	TBA
HMM	103	IS1	71472	Intro to Hotel/Motel Mgmt	CLASS		(blank)	(blank)	(blank)	3	5	TBA
HMM	103	IS1		Intro. to Hospitality Mgmt.	CLASS		(blank)	(blank)	(blank)	3	5	TBA
HMM	226	S1V	70467	Supervisory Development	VILC		(blank)	(blank)	(blank)	3	4	TBA
HMM	261	IS1	70194	Hotel-Motel Housing Management	CLASS		(blank)	(blank)	(blank)	3	1	TBA
HMM	261	IS1		Hotel/Motel Housing Management	CLASS		(blank)	(blank)	(blank)	3	1	TBA
HMM	263	IS1	70391	Front Office Procedures	CLASS		(blank)	(blank)	(blank)	3	2	TBA
HSC	101	001	71318	Introduction to Nutrition	CLASS	R	0830	0950	(blank)	3	24	TBA
HSC	101	001				T	0830	0950	(blank)	3	24	TBA
HSC	102	002	70673	Nutrition Thru. the Life Cycle	CLASS	R	1000	1120	3440	3	24	TBA
HSC	102	002				T	1000	1120	3430	3	24	TBA
HSC	109	001	33946	Medical Terminology	CLASS	W	0830	0950	3454	3	24	TBA
HSC	109	001				M	0830	0950	3454	3	24	TBA
HSC	109	OAC	34604	Medical Terminology	CLASS	R	1715	1835	3454	3	24	TBA
HSC	109	OAC				T	1715	1835	3454	3	24	TBA
HST	101	001	30791	World Civilization	CLASS	MW	0830	0950	2110	3	30	TBA
HST	101	001		World Civilization I	CLASS	MW	0830	0950	2110	3	30	TBA
HST	111	ACV	70824	United States History I	VILC	R	1840	2120	(blank)	3	30	TBA
HST	111	KN1	71617	United States History I	CLASS	S	0830	1120	2111	3	30	TBA
HST	112	001	71329	United States History II	CLASS	MW	1300	1420	2101B	3	30	TBA
HST	112	002	71331	United States History II	CLASS	TR	1000	1120	2101B	3	30	TBA
HST	112	OL1	39428	United States History II	ONLNE		(blank)	(blank)	(blank)	3	24	TBA
HST	122	001	39980	African American History II	CLASS	MW	1000	1120	2109	3	30	TBA
HST	122	001		Afro-American History II	CLASS	MW	1000	1120	2109	3	30	TBA
HST	122	OL1	37341	African American History II	ONLNE		(blank)	(blank)	(blank)	3	30	TBA
HST	122	OL1		Afro-American History II	ONLNE		(blank)	(blank)	(blank)	3	30	TBA

HST	135	01V	71615	Survey of African History II	VILC	TR	1550	1710	(blank)	3	30	TBA
HST	135	OL1	71654	Survey of African History II	ONLNE		(blank)	(blank)	(blank)	3	30	TBA
HST	204	001	71611	Women in American History	CLASS	MW	1425	1545	2113	3	30	TBA
HST	204	002	71613	Women in American History	CLASS	TR	1130	1250	2101A	3	30	TBA
HST	204	OL1	71655	Women in American History	ONLNE		(blank)	(blank)	(blank)	3	30	TBA
HST	205	001	71610	Islam & The Black Experience	CLASS	MW	1130	1250	2109	3	30	TBA
HST	205	001		Islam&Global Black Experience	CLASS	MW	1130	1250	2109	3	30	TBA
HST	206	001	71614	Hist. of American Immigration	CLASS	TR	1300	1420	2113	3	30	TBA
HST	206	01V	71612	Hist. of American Immigration	VILC	MW	1715	1835	(blank)	3	30	TBA
HST	208	001	71616	Genocide & The Holocaust	CLASS	F	1130	1420	2113	3	30	TBA
LPN	101	001	71199	Fund. of Practical Nursing	CLASS	T	0830	1150	204	8	40	TBA
LPN	101	CL1	71200	Fund. of Practical Nursing	CLASS	W	0700	1900	AGENC	0	10	TBA
LPN	101	CL2	71201	Fund. of Practical Nursing	CLASS	F	0700	1900	AGENC	0	10	TBA
LPN	101	CL3	71202	Fund. of Practical Nursing	CLASS	R	0700	1900	AGENC	0	10	TBA
LPN	101	CL4	71390	Fund. of Practical Nursing	CLASS	S	0700	1900	AGENC	0	10	TBA
LPN	101	LB1	71203	Fund. of Practical Nursing	CLASS	T	1200	1520	(blank)	0	15	TBA
LPN	101	LB2	71204	Fund. of Practical Nursing	CLASS	T	1530	1850	(blank)	0	13	TBA
MET	210	OAC	71752	Kinematics	CLASS	MW	1925	2120	T114	3	15	TBA
MET	211	OAC	71753	Machines and Controls	CLASS	MW	1715	1915	T114	3	15	TBA
MTH	086	002	30848	Applied Introductory Algebra	CLASS	TRF	0700	0820	2102	4.5	24	TBA
MTH	086	002		Introductory Algebra	CLASS	TRF	0700	0820	2102	4.5	24	TBA
MTH	086T	002	30862	Tutorial	CLASS	R	0830	0950	3234B	1	24	TBA
				Register for all of the above sections								
MTH	086	005	30851	Applied Introductory Algebra	CLASS	TRF	0830	0950	2107	4.5	24	TBA
MTH	086	005		Introductory Algebra	CLASS	TRF	0830	0950	2107	4.5	24	TBA
MTH	086T	005	36486	Tutorial	CLASS	R	1000	1120	3234B	1	24	TBA
				Register for all of the above sections								
MTH	086	008	30890	Applied Introductory Algebra	CLASS	TRF	1000	1120	2105	4.5	24	TBA
MTH	086	008		Introductory Algebra	CLASS	TRF	1000	1120	2105	4.5	24	TBA
MTH	086T	008	30880	Tutorial	CLASS	T	1130	1250	3234B	1	24	TBA
				Register for all of the above sections								

MTH	086	010	30878	Applied Introductory Algebra	CLASS	TRF	1130	1250	2109	4.5	24	TBA
MTH	086	010		Introductory Algebra	CLASS	TRF	1130	1250	2109	4.5	24	TBA
MTH	086T	010	30889	Tutorial	CLASS	R	1300	1420	3234B	1	24	TBA
				Register for all of the above sections								
MTH	086	012	71690	Applied Introductory Algebra	CLASS	TRF	1300	1420	2101B	4.5	24	TBA
MTH	086	012		Introductory Algebra	CLASS	TRF	1300	1420	2101B	4.5	24	TBA
MTH	086T	012	71693	Tutorial	CLASS	R	1130	1250	3234B	1	24	TBA
				Register for all of the above sections								
MTH	086	014	70539	Applied Introductory Algebra	CLASS	MWF	1425	1545	2101A	4.5	24	TBA
MTH	086	014		Introductory Algebra	CLASS	MWF	1425	1545	2101A	4.5	24	TBA
MTH	086T	014	36528	Tutorial	CLASS	W	1550	1710	3234B	1	24	TBA
				Register for all of the above sections								
MTH	086	01V	30860	Applied Introductory Algebra	VILC	MWF	0700	0820	(blank)	4.5	24	TBA
MTH	086	01V		Introductory Algebra	VILC	MWF	0700	0820	(blank)	4.5	24	TBA
MTH	086T	01V	30850	Tutorial	VILC	M	0830	0950	(blank)	1	24	TBA
				Register for all of the above sections								
MTH	086	07V	35819	Applied Introductory Algebra	VILC	MWF	1000	1120	(blank)	4.5	24	TBA
MTH	086	07V		Introductory Algebra	VILC	MWF	1000	1120	(blank)	4.5	24	TBA
MTH	086T	07V	30877	Tutorial	VILC	W	0830	0950	(blank)	1	24	TBA
				Register for all of the above sections								
MTH	086	OAC	30917	Applied Introductory Algebra	CLASS	MW	1715	1920	2102	4.5	24	TBA
MTH	086	OAC		Introductory Algebra	CLASS	MW	1715	1920	2102	4.5	24	TBA
MTH	086T	OAC	36516	Tutorial	CLASS	W	1925	2045	3234B	1	24	TBA
				Register for all of the above sections								
MTH	086	OBC	71691	Applied Introductory Algebra	CLASS	TR	1715	1920	2102	4.5	24	TBA
MTH	086	OBC		Introductory Algebra	CLASS	TR	1715	1920	2102	4.5	24	TBA
MTH	086T	OBC	71694	Tutorial	CLASS	W	1925	2045	3234B	1	24	TBA
				Register for all of the above sections								
MTH	086	OEC	30938	Applied Introductory Algebra	CLASS	MW	1925	2130	2102	4.5	24	TBA
MTH	086	OEC		Introductory Algebra	CLASS	MW	1925	2130	2102	4.5	24	TBA
MTH	086T	OEC	33330	Tutorial	CLASS	F	1925	2045	3234B	1	24	TBA
				Register for all of the above sections								
MTH	086	K1V	71692	Applied Introductory Algebra	CLASS	S	0830	1230	(blank)	4.5	24	TBA
MTH	086	K1V		Introductory Algebra	CLASS	S	0830	1230	(blank)	4.5	24	TBA
MTH	086T	K1V	71695	Tutorial	CLASS	S	1300	1420	3234B	1	24	TBA
				Register for all of the above sections								
MTH	101	D01	71070	Statistics and Probability I	CLASS	MWF	1000	1120	2112	4	30	TBA
MTH	091S	D01	71072	Basic Skills-Statistics & Prob	CLASS	F	1130	1250	(blank)	1.5	30	TBA
				Register for all of the above sections								
MTH	101	D2V	71071	Statistics and Probability I	VILC	TRF	0830	0950	(blank)	4	30	TBA
MTH	091S	D2V	71073	Basic Skills-Statistics & Prob	VILC	F	1000	1120	(blank)	1.5	30	TBA
				Register for all of the above sections								

MTH	101	DDC	71074	Statistics and Probability I	CLASS	TR	1925	2110	2105	4	30	TBA
MTH	091S	DDC	71075	Basic Skills-Statistics & Prob	CLASS	T	1800	1920	2101A	1.5	30	TBA
				Register for all of the above sections								
MTH	092	001	33953	Applied Elementary Algebra	CLASS	MWF	0700	0820	2101B	4.5	24	TBA
MTH	092	001		Elementary Algebra	CLASS	MWF	0700	0820	2101B	4.5	24	TBA
MTH	092T	001	33955	Tutorial	CLASS	M	0830	0950	3234B	1	24	TBA
				Register for all of the above sections								
MTH	092	002	38086	Applied Elementary Algebra	CLASS	TRF	0700	0820	2101A	4.5	24	TBA
MTH	092	002		Elementary Algebra	CLASS	TRF	0700	0820	2101A	4.5	24	TBA
MTH	092T	002	38087	Tutorial	CLASS	T	0830	0950	3234B	1	24	TBA
				Register for all of the above sections								
MTH	092	003	30974	Applied Elementary Algebra	CLASS	MWF	1425	1545	2101B	4.5	24	TBA
MTH	092	003		Elementary Algebra	CLASS	MWF	1425	1545	2101B	4.5	24	TBA
MTH	092T	003	30976	Tutorial	CLASS	F	1300	1420	3234B	1	24	TBA
				Register for all of the above sections								
MTH	092	004	30977	Applied Elementary Algebra	CLASS	MWF	0830	0950	2101A	4.5	24	TBA
MTH	092	004		Elementary Algebra	CLASS	MWF	0830	0950	2101A	4.5	24	TBA
MTH	092T	004	30979	Tutorial	CLASS	W	1000	1120	3234B	1	24	TBA
				Register for all of the above sections								
MTH	092	005	30980	Applied Elementary Algebra	CLASS	TRF	0830	0950	4130	4.5	24	TBA
MTH	092	005		Elementary Algebra	CLASS	TRF	0830	0950	4130	4.5	24	TBA
MTH	092T	005	70211	Tutorial	CLASS	T	1000	1120	3234B	1	24	TBA
				Register for all of the above sections								
MTH	092	007	30986	Applied Elementary Algebra	CLASS	MWF	1000	1120	2101A	4.5	24	TBA
MTH	092	007		Elementary Algebra	CLASS	MWF	1000	1120	2101A	4.5	24	TBA
MTH	092T	007	36125	Tutorial	CLASS	M	1130	1250	3234B	1	24	TBA
				Register for all of the above sections								
MTH	092	008	30989	Applied Elementary Algebra	CLASS	TRF	1300	1420	2108	4.5	24	TBA
MTH	092	008		Elementary Algebra	CLASS	TRF	1300	1420	2108	4.5	24	TBA
MTH	092T	008	31003	Tutorial	CLASS	F	1425	1545	3234B	1	24	TBA
				Register for all of the above sections								
MTH	092	010	35533	Applied Elementary Algebra	CLASS	TRF	1000	1120	2109	4.5	24	TBA
MTH	092	010		Elementary Algebra	CLASS	TRF	1000	1120	2109	4.5	24	TBA
MTH	092T	010	31006	Tutorial	CLASS	T	1130	1250	3234B	1	24	TBA
				Register for all of the above sections								
MTH	092	012	31073	Applied Elementary Algebra	CLASS	MWF	1130	1250	2108	4.5	24	TBA
MTH	092	012		Elementary Algebra	CLASS	MWF	1130	1250	2108	4.5	24	TBA
MTH	092T	012	35534	Tutorial	CLASS	F	1300	1420	3234B	1	24	TBA
				Register for all of the above sections								
MTH	092	014	34348	Applied Elementary Algebra	CLASS	TRF	1130	1250	2111	4.5	24	TBA
MTH	092	014		Elementary Algebra	CLASS	TRF	1130	1250	2111	4.5	24	TBA
MTH	092T	014	31000	Tutorial	CLASS	T	1000	1120	3234B	1	24	TBA
				Register for all of the above sections								

MTH	092	015	35535	Applied Elementary Algebra	CLASS	MWF	1300	1420	2106	4.5	24	TBA
MTH	092	015		Elementary Algebra	CLASS	MWF	1300	1420	2106	4.5	24	TBA
MTH	092T	015	36123	Tutorial	CLASS	W	1130	1250	3234B	1	24	TBA
				Register for all of the above sections								
MTH	092	OAC	31028	Applied Elementary Algebra	CLASS	MW	1715	1920	2108	4.5	24	TBA
MTH	092	OAC		Elementary Algebra	CLASS	MW	1715	1920	2108	4.5	24	TBA
MTH	092T	OAC	31030	Tutorial	CLASS	W	1925	2045	3234B	1	24	TBA
				Register for all of the above sections								
MTH	092	OBC	31034	Applied Elementary Algebra	CLASS	TR	1715	1920	2101B	4.5	24	TBA
MTH	092	OBC		Elementary Algebra	CLASS	TR	1715	1920	2101B	4.5	24	TBA
MTH	092T	OBC	31045	Tutorial	CLASS	F	1715	1835	3234B	1	24	TBA
				Register for all of the above sections								
MTH	092	OCC	31043	Applied Elementary Algebra	CLASS	MW	1925	2130	2111	4.5	24	TBA
MTH	092	OCC		Elementary Algebra	CLASS	MW	1925	2130	2111	4.5	24	TBA
MTH	092T	OCC	31051	Tutorial	CLASS	T	1925	2045	3234B	1	24	TBA
				Register for all of the above sections								
MTH	092	ODC	31049	Applied Elementary Algebra	CLASS	TR	1925	2130	2108	4.5	24	TBA
MTH	092	ODC		Elementary Algebra	CLASS	TR	1925	2130	2108	4.5	24	TBA
MTH	092T	ODC	70212	Tutorial	CLASS	F	1925	2045	3234B	1	24	TBA
				Register for all of the above sections								
MTH	092	K1V	71696	Applied Elementary Algebra	VILC	S	0830	1230	(blank)	4.5	24	TBA
MTH	092	K1V		Elementary Algebra	VILC	S	0830	1230	(blank)	4.5	24	TBA
MTH	092T	K1V	71697	Tutorial	VILC	S	1300	1420	(blank)	1	24	TBA
				Register for all of the above sections								
MTH	093S	002	71700	Basic Skills for Modern Mathem	CLASS	T	1300	1420	2115	1.5	24	TBA
MTH	093S	DCV	71079	Basic Skills for Modern Mathem	VILC	M	1925	2045	(blank)	1.5	24	TBA
MTH	100	001	38149	Intro. to College Mathematics	CLASS	TRF	0700	0820	2111	4	30	TBA
MTH	100	002	37753	Intro. to College Mathematics	CLASS	MTR	0700	0820	2110	4	30	TBA
MTH	100	003	31088	Intro. to College Mathematics	CLASS	MWF	1550	1710	4135	4	30	TBA
MTH	100	004	38088	Intro. to College Mathematics	CLASS	TRF	0830	0950	2111	4	30	TBA
MTH	100	005	34837	Intro. to College Mathematics	CLASS	MTR	1000	1120	2102	4	30	TBA
MTH	100	006	35787	Intro. to College Mathematics	CLASS	MWF	1000	1120	2107	4	30	TBA
MTH	100	007	31097	Intro. to College Mathematics	CLASS	MTR	1300	1420	2111	4	30	TBA
MTH	100	008	31090	Intro. to College Mathematics	CLASS	TRF	1000	1120	2118	4	30	TBA
MTH	100	009	70577	Intro. to College Mathematics	CLASS	TRF	1300	1420	4131	4	30	TBA

MTH	100	010	37288	Intro. to College Mathematics	CLASS	MWF	1130	1250	4132		4	30	TBA
MTH	100	011	36788	Intro. to College Mathematics	CLASS	MTR	1130	1250	2113		4	30	TBA
MTH	100	012	31093	Intro. to College Mathematics	CLASS	TRF	1130	1250	2110		4	30	TBA
MTH	100	013	35186	Intro. to College Mathematics	CLASS	MWF	1300	1420	2109		4	30	TBA
MTH	100	014	71766	Intro. to College Mathematics	CLASS	TRF	1300	1420	4133		4	30	TBA
MTH	100	015	38487	Intro. to College Mathematics	CLASS	MWF	1425	1545	2105		4	30	TBA
MTH	100	017	37287	Intro. to College Mathematics	CLASS	MTR	1425	1545	2102		4	30	TBA
MTH	100	OAC	31101	Intro. to College Mathematics	CLASS	MW	1715	1905	2111		4	30	TBA
MTH	100	OBC	31103	Intro. to College Mathematics	CLASS	TR	1715	1905	2105		4	30	TBA
MTH	100	OCC	31105	Intro. to College Mathematics	CLASS	MW	1925	2115	2105		4	30	TBA
MTH	100	ODC	31106	Intro. to College Mathematics	CLASS	TR	1925	2115	2110		4	30	TBA
MTH	101	001	39540	Statistics and Probability I	CLASS	TRF	0830	0950	2105		4	30	TBA
MTH	101	003	36473	Statistics and Probability I	CLASS	MWF	1000	1120	4133		4	30	TBA
MTH	101	004	38930	Statistics and Probability I	CLASS	MWF	1300	1420	4135		4	30	TBA
MTH	101	OBC	36448	Statistics and Probability I	CLASS	TR	1715	1900	2112		4	30	TBA
MTH	101	OL1	38521	Statistics and Probability I	ONLNE		(blank)	(blank)	(blank)		4	30	TBA
MTH	101	OL2	70696	Statistics and Probability I	ONLNE		(blank)	(blank)	(blank)		4	30	TBA
MTH	103	001	71701	Fund Concepts Modern Math I	CLASS	TRF	0830	0950	2102		4	24	TBA
MTH	103	002	71702	Fund Concepts Modern Math I	CLASS	TRF	1130	1250	2106		4	24	TBA
MTH	103	DCV	71078	Fund Concepts Modern Math I	VILC	MW	1715	1920	(blank)		4	24	TBA
MTH	103	OL1	71418	Fund Concepts Modern Math I	ONLNE		(blank)	(blank)	(blank)		4	30	TBA
MTH	113	001	37285	College Algebra with Trig	CLASS	TRF	1000	1120	2108		4	30	TBA
MTH	113	002	31116	College Algebra with Trig	CLASS	TRF	1130	1250	2105		4	30	TBA
MTH	113	OAC	31119	College Algebra with Trig	CLASS	TR	1925	2110	2111		4	30	TBA
MTH	114	001	33962	Unified Calculus I	CLASS	TR	1300	1420	2105		3	30	TBA
MTH	118	001	39896	Precalculus	CLASS	MWF	0830	0950	4131		4	30	TBA
MTH	119	001	31126	Pre-Calculus I	CLASS	TRF	0830	0950	2101B		4	30	TBA

MTH	119	002	36776	Pre-Calculus I	CLASS	MWF	1000	1120	2110	4	30	TBA
MTH	119	003	31125	Pre-Calculus I	CLASS	MWF	1130	1250	4135	4	30	TBA
MTH	119	005	38150	Pre-Calculus I	CLASS	MWF	1300	1420	2101A	4	30	TBA
MTH	119	OAC	38932	Pre-Calculus I	CLASS	TR	1715	1900	2108	4	30	TBA
MTH	120	001	70701	Pre-Calculus II	CLASS	TRF	0830	0950	4135	4	30	TBA
MTH	120	004	70702	Pre-Calculus II	CLASS	MWF	1300	1420	2115	4	30	TBA
MTH	121	001	37754	Calc with Analytic Geom I	CLASS	TRF	0830	0950	4132	4	30	TBA
MTH	121	002	31132	Calc with Analytic Geom I	CLASS	MWF	1130	1250	2102	4	30	TBA
MTH	121	OAC	71698	Calc with Analytic Geom I	CLASS	TR	1715	1900	2111	4	30	TBA
MTH	122	001	38415	Calc with Analytic Geom II	CLASS	MWF	1425	1545	4133	4	30	TBA
MTH	122	OAC	31135	Calc with Analytic Geom II	CLASS	TR	1715	1905	2110	4	30	TBA
MTH	136	OAC	31136	Discrete Mathematics	CLASS	MW	1715	1835	2109	3	30	TBA
MTH	141	001	70443	Mathematical Statistics	CLASS	TR	1550	1710	4130	3	30	TBA
MTH	213	001	70704	Unified Calculus II	CLASS	MW	0830	0950	2102	3	30	TBA
MTH	221	OAC	36460	Calc with Analytic Geom III	CLASS	TRF	1550	1710	2108	4	30	TBA
MTH	222	OAC	39587	Differential Equations	CLASS	MW	1715	1900	2110	4	30	TBA
MTH	239	001	31142	Introduction to Linear Algebra	CLASS	TR	1300	1420	2102	3	30	TBA
MUS	100	003	39926	Music Appreciation	CLASS	MW	1000	1120	2118	3	30	TBA
MUS	100	01V	33966	Music Appreciation	VILC	TR	0830	0950	(blank)	3	30	TBA
MUS	106	001	71367	Musicianship II	CLASS	TR	1000	1120	2115	2	20	TBA
MUS	109	ACV	71619	Appreciation Jazz	VILC	W	1840	2120	(blank)	3	24	TBA
MUS	109	ACV		Appreciation of Jazz	VILC	W	1840	2120	(blank)	3	24	TBA
MUS	109	ACV		Jazz Appreciation	VILC	W	1840	2120	(blank)	3	24	TBA
MUS	109	OL1	34443	Appreciation Jazz	ONLNE		(blank)	(blank)	(blank)	3	30	TBA
MUS	109	OL1		Appreciation of Jazz	ONLNE		(blank)	(blank)	(blank)	3	30	TBA
MUS	109	OL1		Jazz Appreciation	ONLNE		(blank)	(blank)	(blank)	3	30	TBA
MUS	116	001	71368	Ear Trng & Sight Singing II	CLASS	TR	1130	1250	2115	2	20	TBA
MUS	117	001	71334	African American Music	CLASS	MW	1130	1250	2116	3	30	TBA
MUS	117	001		Black Contributions to Music	CLASS	MW	1130	1250	2116	3	30	TBA

MUS	122	001	71372	Voice Class II	CLASS	MW	1000	1120	2125	2	10	TBA
MUS	132	001	71369	Keyboard Class II	CLASS	MW	1000	1120	(blank)	2	10	TBA
MUS	142	001	71374	College Choir II	CLASS	MW	1300	1420	2125	1	10	TBA
MUS	154	IM1	71336	Instrumental Workshop II	CLASS		(blank)	(blank)	(blank)	1	10	TBA
MUS	170	001	71633	Intro. to Music Technology	CLASS	TR	1300	1420	2118	3	10	TBA
MUS	206	001	71632	Musicianship IV	CLASS	TR	1130	1250	2116	2	10	TBA
MUS	222	001	71630	Voice Class IV	CLASS	MW	1130	1250	(blank)	2	10	TBA
MUS	232	001	71371	Keyboard Class IV	CLASS	MW	1130	1250	2125	2	10	TBA
MUS	242	001	71631	College Choir IV	CLASS	MW	1425	1545	2125	1	10	TBA
MUS	254	IM1	70999	Instrumental Workshop IV	CLASS		(blank)	(blank)	(blank)	1	10	TBA
NMT	101	HY1	36910	Interactive Multimedia Design	HYBRD	W	0830	0950	(blank)	4	20	TBA
NMT	101	HY1				F	0830	1120	3130	4	20	TBA
NMT	202	HY1	71717	Game Design and Applications	HYBRD	R	0830	0950	(blank)	3	20	TBA
NMT	202	HY1				T	0830	1120	3130	3	20	TBA
NRS	106	001	71393	LPN MOBILITY I	CLASS	TR	0830	1010	203	2	25	TBA
NRS	114	001	38994	Common Health Alterations	CLASS	W	1130	1420	2132	8	40	TBA
NRS	114	CL1	38996	Common Health Alterations	CLASS	RF	1715	2245	AGENC	0	10	TBA
NRS	114	CL2	38998	Common Health Alterations	CLASS	RF	0830	1420	AGENC	0	10	TBA
NRS	114	CL3	39450	Common Health Alterations	CLASS	M	0700	1900	AGENC	0	10	TBA
NRS	114	CL4	70869	Common Health Alterations	CLASS	S	0700	1900	AGENC	0	10	TBA
NRS	114	LB1	71423	Common Health Alterations	CLASS	M	0830	1120	208	0	13	TBA
NRS	114	LB2	39452	Common Health Alterations	CLASS	W	0830	1120	206	0	13	TBA
NRS	114	LB3	70870	Common Health Alterations	CLASS	M	1130	1420	206	0	13	TBA
NRS	216	001	39566	Management of Care	CLASS	W	0830	1120	2132	8	45	TBA
NRS	216	CL1	39568	Management of Care	CLASS	M	0900	2100	AGENC	0	10	TBA
NRS	216	CL2	39569	Management of Care	CLASS	M	0700	1900	AGENC	0	10	TBA
NRS	216	CL3	70412	Management of Care	CLASS	F	0700	1900	AGENC	0	10	TBA

NRS	216	CL4	71165	Management of Care	CLASS	M	0700	1900	AGENC		0	10	TBA
NRS	216	LB1	70179	Management of Care	CLASS	W	1140	1420	208		0	15	TBA
NRS	216	LB2	39571	Management of Care	CLASS	F	0830	1120	208		0	15	TBA
NRS	216	LB3	39876	Management of Care	CLASS	F	1140	1430	208		0	15	TBA
NRS	217	001	39664	Prof.IssuesLeadershipSynthesis	CLASS	R	0830	0925	213		2	40	TBA
NRS	217	002	39666	Prof.IssuesLeadershipSynthesis	CLASS	R	0940	1035	213		2	22	TBA
NRS	217	LB1	39667	Prof.IssuesLeadershipSynthesis	CLASS	R	1040	1320	213		0	15	TBA
NRS	217	LB2	39668	Prof.IssuesLeadershipSynthesis	CLASS	R	1425	1705	213		0	15	TBA
NRS	217	LBA	70868	Prof.IssuesLeadershipSynthesis	CLASS	R	1715	1950	213		0	15	TBA
OPH	124	001	71146	Ophthalmic Laboratory II	CLASS	TR	1130	1420	3459		4	14	TBA
OPH	124	OAC	31217	Ophthalmic Laboratory II	CLASS	TR	1840	2120	3459		4	14	TBA
OPH	127	001	31219	Ophthalmic Materials II	CLASS	TR	1000	1120	3459		3	14	TBA
OPH	127	OAC	71145	Ophthalmic Materials II	CLASS	TR	1715	1835	3459		3	14	TBA
OPH	202	001	34176	Ophthalmic Dispensing II	CLASS	MW	1000	1320	3457		5	14	TBA
OPH	202	002	71452	Ophthalmic Dispensing II	CLASS	MW	1350	1710	3457		5	14	TBA
OPH	204	OAC	31225	Contact Lenses II	CLASS	MW	1715	1835	3405		3	24	TBA
OPH	210	OAC	32848	Principles of Refraction I	CLASS	W	1840	2120	3407		3	24	TBA
OPH	273	001	70911	Supervised Clin Instruction	CLASS	MW	1200	1320	3401		3	7	TBA
OPH	273	002	71148	Supervised Clin Instruction	CLASS	MW	1340	1500	3401		3	7	TBA
PHE	115	S1V	31252	First Aid and Safety	VILC	MW	1000	1100	(blank)		2	10	TBA
PHE	119	S1V	31253	Concepts in Physical Education	VILC	TR	0800	0930	(blank)		2	10	TBA
PHE	151	IS1	33982	Soccer/Speedball	CLASS		(blank)	(blank)	(blank)		1	5	TBA
PHE	251	IS1	31259	Badminton/Squash Racquets	VILC		(blank)	(blank)	(blank)		1	2	TBA
PHE	256	IS1	37647	Track and Field	CLASS		(blank)	(blank)	(blank)		1	5	TBA
PHE	257	IS1	39435	Weight Training for Fitness	CLASS		(blank)	(blank)	(blank)		1	5	TBA
PHE	257	IS1		Wieght Training for Fitness	CLASS		(blank)	(blank)	(blank)		1	5	TBA
PHE	262	01V	37648	Coach & Officiating Soccer	VILC	TR	1130	1225	(blank)		2	10	TBA

PHY	101	001	31271	College Physics I	CLASS	W	0830	1120	3420		4	24	TBA
PHY	101	001				M	0830	1120	3420		4	24	TBA
PHY	101	002	31272	College Physics I	CLASS	TR	0830	1120	3420		4	24	TBA
PHY	101	OAC	31274	College Physics I	CLASS	MW	1840	2120	3420		4	24	TBA
PHY	102	001	34832	College Physics II	CLASS	MW	0830	1120	3455		4	24	TBA
PHY	102	002	36792	College Physics II	CLASS	R	1130	1420	3410		4	24	TBA
PHY	102	002				T	1130	1420	3410		4	24	TBA
PHY	102	OAC	70872	College Physics II	CLASS	W	1840	2120	3455		4	24	TBA
PHY	102	OAC				M	1840	2120	3455		4	24	TBA
PHY	103	002	38412	General Physics I	CLASS	MW	1130	1420	3410		4	24	TBA
PHY	104	001	32502	General Physics II	CLASS	MW	0830	1120	3410		4	24	TBA
PHY	104	OAC	39584	General Physics II	CLASS	TR	1840	2120	3410		4	24	TBA
PHY	105	HY1	71319	Concepts in Physics	HYBRD	R	1130	1420	3420		4	24	TBA
PHY	105	HY1				T	1130	1420	(blank)		4	24	TBA
PHY	105	HY1		Physical Science	HYBRD	R	1130	1420	3420		4	24	TBA
PHY	105	HY1				T	1130	1420	(blank)		4	24	TBA
PHY	110	IS2	71320	Intro. Data Reduction Applica.	CLASS		(blank)	(blank)	(blank)		3	3	TBA
PHY	111	001	70861	Theory of Optics	CLASS	T	1000	1240	3405		3	18	TBA
PHY	111	001		Theory of Optics I	CLASS	T	1000	1240	3405		3	18	TBA
PHY	113	OL2	71460	Astronomy	CLASS		(blank)	(blank)	(blank)		4	24	TBA
PHY	114	01H	71492	Meteorology	HYBRD	W	0830	1120	(blank)		4	24	TBA
PHY	114	01H				M	0830	1120	(blank)		4	24	TBA
PHY	114	OL2	71550	Meteorology	ONLNE		(blank)	(blank)	(blank)		4	24	TBA
PLS	101	OAV	70710	Intro. to Law for Paralegals	VILC	M	1840	2120	(blank)		3	20	TBA
PLS	107	OAV	70495	Contracts	VILC	TR	1715	1835	(blank)		3	20	TBA
PLS	202	OAV	70496	Adv. Legal Research & Writing	VILC	F	1715	2000	(blank)		3	15	TBA
PLS	203	OAV	71661	Wills & Estate Administration	VILC	MW	1715	1835	(blank)		3	30	TBA
PLS	204	OAV	70497	Bus. Org. & Gov't Regulation	VILC	T	1840	2120	(blank)		3	15	TBA
PLS	205	OAV	36481	Administrative Law	VILC	W	1840	2120	(blank)		3	20	TBA
POL	104	002	39398	American Government	CLASS	MW	1300	1420	3162		3	30	TBA
POL	104	01V	37241	American Government	VILC	MW	0830	0950	(blank)		3	30	TBA

POL	104	03V	37634	American Government	VILC	TR	1300	1420	(blank)	3	30	TBA
POL	104	0BV	70229	American Government	VILC	MW	1715	1835	(blank)	3	30	TBA
POL	104	OL1	39050	American Government	ONLNE		(blank)	(blank)	(blank)	3	24	TBA
PSY	101	002	39073	General Psychology I	CLASS	TR	0700	0820	4132	3	30	TBA
PSY	101	004	31296	General Psychology I	CLASS	TR	0830	0950	4131	3	30	TBA
PSY	101	006	34435	General Psychology I	CLASS	F	0830	1120	3162	3	30	TBA
PSY	101	008	70096	General Psychology I	CLASS	MW	1000	1120	4130	3	30	TBA
PSY	101	010	70095	General Psychology I	CLASS	F	1300	1545	4132	3	30	TBA
PSY	101	012	31299	General Psychology I	CLASS	TR	1130	1250	4130	3	30	TBA
PSY	101	014	31313	General Psychology I	CLASS	MW	1300	1420	4130	3	34	TBA
PSY	101	016	35115	General Psychology I	CLASS	MW	1550	1710	4130	3	30	TBA
PSY	101	018	71489	General Psychology I	CLASS	TR	1300	1420	4130	3	30	TBA
PSY	101	019	71516	General Psychology I	CLASS	MW	0830	0950	4130	3	30	TBA
PSY	101	01V	31294	General Psychology I	VILC	MW	0700	0820	(blank)	3	30	TBA
PSY	101	03V	31295	General Psychology I	VILC	MW	0830	0950	(blank)	3	30	TBA
PSY	101	07V	31301	General Psychology I	VILC	MW	1000	1120	(blank)	3	30	TBA
PSY	101	09V	31297	General Psychology I	VILC	TR	1000	1120	(blank)	3	30	TBA
PSY	101	OAC	35947	General Psychology I	CLASS	TR	1715	1835	4130	3	30	TBA
PSY	101	0BV	31307	General Psychology I	VILC	T	1840	2120	(blank)	3	30	TBA
PSY	101	0DV	70469	General Psychology I	VILC	W	1840	2120	(blank)	3	30	TBA
PSY	101	11V	31298	General Psychology I	VILC	TR	1130	1250	(blank)	3	30	TBA
PSY	101	13V	38954	General Psychology I	VILC	F	1130	1420	(blank)	3	30	TBA
PSY	101	15V	31302	General Psychology I	VILC	TR	1300	1420	(blank)	3	30	TBA
PSY	101	17V	37438	General Psychology I	VILC	TR	1550	1710	(blank)	3	30	TBA
PSY	101	KN1	71662	General Psychology I	CLASS	S	1300	1540	3162	3	30	TBA
PSY	101	OL1	38522	General Psychology I	ONLNE		(blank)	(blank)	(blank)	3	24	TBA

PSY	102	002	31317	General Psychology II	CLASS	TR	1130	1250	4131		3	30	TBA
PSY	102	0AV	31316	General Psychology II	VILC	MW	1715	1835	(blank)		3	30	TBA
PSY	102	OL1	38572	General Psychology II	ONLNE		(blank)	(blank)	(blank)		3	24	TBA
PSY	205	OAC	33422	Theories of Personality	CLASS	T	1840	2120	4130		3	30	TBA
PSY	209	002	38479	Abnormal Psychology	CLASS	MW	1130	1250	4131		3	30	TBA
PSY	209	OAC	37649	Abnormal Psychology	CLASS	MW	1715	1835	4132		3	30	TBA
PSY	219	01V	31320	Child Psychology and Develop.	VILC	MW	1130	1250	(blank)		3	30	TBA
PSY	219	OAC	31321	Child Psychology and Develop.	CLASS	T	1840	2120	4132		3	30	TBA
PSY	219	OL1	39048	Child Psychology and Develop.	ONLNE		(blank)	(blank)	(blank)		3	24	TBA
PSY	225	OAC	71663	Child Develop. Psychopathology	CLASS	TR	1715	1835	4132		3	30	TBA
PSY	225	OAC		Child&Adolescent Abnormal Psy.	CLASS	TR	1715	1835	4132		3	30	TBA
PSY	230	01V	39885	Life-Span Developmental Psy.	VILC	MW	1300	1420	(blank)		3	30	TBA
PSY	230	OAC	39886	Life-Span Developmental Psy.	CLASS	MW	1715	1835	4130		3	30	TBA
PSY	232	OL1	39049	Human Sexuality	ONLNE		(blank)	(blank)	(blank)		3	24	TBA
PSY	250	01V	31323	Theor & Pr of Ment Hlth Occup.	VILC	R	1840	2120	(blank)		3	30	TBA
PSY	250	01V		Theory/Prac./Couns./Psychothe.	VILC	R	1840	2120	(blank)		3	30	TBA
PSY	251	01V	31325	Counsel & Treat of Addictions	VILC	TR	1300	1420	(blank)		3	30	TBA
PTA	102	001	31327	Principles of PTA	CLASS	MW	0930	1050	G05		5	30	TBA
PTA	102	CL1	32147	Principles of PTA	CLASS	F	0800	1600	AGENC		0	15	TBA
PTA	102	CL2	35595	Principles of PTA	CLASS	MW	1400	1800	AGENC		0	15	TBA
PTA	102	LB1	31328	Principles of PTA	CLASS	MW	1100	1220	G09		0	15	TBA
PTA	102	LB2	35594	Principles of PTA	CLASS	MW	1230	1350	G09		0	15	TBA
PTA	106	001	35276	Ther.Inter./Child Dev.&Geronto	CLASS	MW	0800	0920	G05		3	30	TBA
PTA	202	001	71217	Principles of PTA III	CLASS	TRF	0830	1045	2132		4	30	TBA
PTA	202	LB1	71218	Principles of PTA III	CLASS	TRF	1050	1305	G09		0	15	TBA
PTA	202	LB2	71219	Principles of PTA III	CLASS	TRF	1310	1525	G09		0	15	TBA
PTA	205	CL1	71220	PTA Practicum III	CLASS	MTWRF	0930	1430	(blank)		6	15	TBA
PTA	205	CL2	71221	PTA Practicum III	CLASS	MTWRF	1431	1931	(blank)		6	15	TBA

PTA	206	001	71222	Prof. Issues Phys.Thera.Assist	CLASS	MW	1100	1430	(blank)	1	24	TBA
RTC	104	001	71149	Radiation Protection	CLASS	M	1110	1250	(blank)	2	17	TBA
RTC	105	001	71150	Radiologic Technology II	CLASS	W	1200	1250	(blank)	2	17	TBA
RTC	105	LB1	71151	Radiologic Technology II	CLASS	M	0800	1050	(blank)	0	9	TBA
RTC	105	LB2	71152	Radiologic Technology II	CLASS	M	1300	1545	(blank)	0	8	TBA
RTC	106	001	71153	Radiologic Positioning Prin II	CLASS	W	0830	1120	(blank)	4	17	TBA
RTC	106	LB1	71154	Radiologic Positioning Prin II	CLASS	F	0830	1120	(blank)	0	9	TBA
RTC	106	LB2	71155	Radiologic Positioning Prin II	CLASS	F	1130	1420	(blank)	0	8	TBA
RTC	107	001	71156	Contrast Media	CLASS	W	1300	1450	(blank)	2	17	TBA
RTC	111	CL1	71157	Clinical Radiography II	CLASS	TR	0830	1500	(blank)	1	5	TBA
RTC	111	CL2	71158	Clinical Radiography II	CLASS	TR	0830	1500	(blank)	1	4	TBA
RTC	111	CL3	71159	Clinical Radiography II	CLASS	TR	0830	1500	(blank)	1	8	TBA
RTC	203	001	71160	Special Procedures	CLASS	T	0830	1020	(blank)	3	12	TBA
RTC	203	LB1	71161	Special Procedures	CLASS	R	0830	1120	(blank)	3	12	TBA
RTC	204	001	71162	Pediatric/Geriatric Rad	CLASS	T	1030	1120	(blank)	1	12	TBA
RTC	204	001		Pediatric/GeriatricRadiography	CLASS	T	1030	1120	(blank)	1	12	TBA
RTC	206	CL1	71163	Clinical Radiography VI	CLASS	MWF	0830	1500	(blank)	2	7	TBA
RTC	206	CL1		Clinical Radiogrphy VI	CLASS	MWF	0830	1500	(blank)	2	7	TBA
RTC	206	CL2	71164	Clinical Radiography VI	CLASS	MWF	0830	1500	(blank)	2	5	TBA
RTC	206	CL2		Clinical Radiogrphy VI	CLASS	MWF	0830	1500	(blank)	2	5	TBA
SCM	101	001	39350	Intro. to Operations and SCM	CLASS	MW	1000	1120	4157	3	30	TBA
SCM	101	001		Supply Chain Mngmt. Principles	CLASS	MW	1000	1120	4157	3	30	TBA
SCM	101	IS1	71473	Intro. to Operations and SCM	CLASS		(blank)	(blank)	(blank)	3	5	TBA
SCM	101	IS1		Supply Chain Mngmt. Principles	CLASS		(blank)	(blank)	(blank)	3	5	TBA
SCM	101	OL1	71804	Intro. to Operations and SCM	ONLNE		(blank)	(blank)	(blank)	3	24	TBA
SCM	101	OL1		Supply Chain Mngmt. Principles	ONLNE		(blank)	(blank)	(blank)	3	24	TBA
SCM	201	OL1	71528	Principles Supply Chain Mgmt.	ONLNE		(blank)	(blank)	(blank)	3	24	TBA
SCM	219	OAV	70147	Transportation & Warehousing	VILC	TR	1715	1835	(blank)	3	15	TBA
SCM	229	OAV	70148	Demand Planning & Fulfillment	VILC	TR	1840	2000	(blank)	3	15	TBA

SCM	239	OAV	70149	Procurement & Risk Management	VILC	W	1840	2120	(blank)	3	15	TBA
SOC	101	002	32862	Introduction to Sociology	CLASS	MW	0830	0950	4132	3	30	TBA
SOC	101	004	31567	Introduction to Sociology	CLASS	MW	1000	1120	4131	3	32	TBA
SOC	101	005	31572	Introduction to Sociology	CLASS	TR	1000	1120	4130	3	30	TBA
SOC	101	008	31569	Introduction to Sociology	CLASS	TR	1130	1250	3162	3	32	TBA
SOC	101	010	39833	Introduction to Sociology	CLASS	MW	1300	1420	4132	3	30	TBA
SOC	101	01V	31566	Introduction to Sociology	VILC	TR	1000	1120	(blank)	3	30	TBA
SOC	101	03V	31568	Introduction to Sociology	VILC	TR	0830	0950	(blank)	3	30	TBA
SOC	101	06V	71109	Introduction to Sociology	VILC	MW	0700	0820	(blank)	3	30	TBA
SOC	101	07V	31571	Introduction to Sociology	VILC	MW	1130	1250	(blank)	3	30	TBA
SOC	101	09V	34436	Introduction to Sociology	VILC	F	1000	1240	(blank)	3	30	TBA
SOC	101	OAC	33699	Introduction to Sociology	CLASS	TR	1715	1835	4131	3	30	TBA
SOC	101	0BV	31574	Introduction to Sociology	VILC	M	1840	2120	(blank)	3	30	TBA
SOC	101	OCC	33702	Introduction to Sociology	CLASS	W	1840	2120	4132	3	30	TBA
SOC	101	ODV	71112	Introduction to Sociology	VILC	S	1130	1410	(blank)	3	30	TBA
SOC	101	11V	31570	Introduction to Sociology	VILC	TR	1300	1420	(blank)	3	30	TBA
SOC	101	OL1	38523	Introduction to Sociology	ONLNE		(blank)	(blank)	(blank)	3	24	TBA
SOC	108	001	71666	Social Problems	CLASS	TR	1130	1250	4135	3	30	TBA
SOC	108	002	31579	Social Problems	CLASS	MW	1425	1545	3162	3	30	TBA
SOC	108	01V	31580	Social Problems	VILC	TR	1000	1120	(blank)	3	30	TBA
SOC	108	02V	71667	Social Problems	VILC	M	1840	2120	(blank)	3	30	TBA
SOC	108	OAC	71665	Social Problems	CLASS	MW	1715	1835	4133	3	30	TBA
SOC	108	OL1	39090	Social Problems	ONLNE		(blank)	(blank)	(blank)	3	24	TBA
SOC	111	001	31582	Helper Theory	CLASS	TR	1000	1120	4132	3	30	TBA
SOC	111	BCV	70973	Helper Theory	VILC	R	1840	2120	(blank)	3	30	TBA
SOC	111	OL1	71677	Helper Theory	ONLNE		(blank)	(blank)	(blank)	3	24	TBA
SOC	113	ACV	70971	Foundations of Community Healt	VILC	R	1840	2120	(blank)	3	30	TBA

SOC	121	001	35026	Soc Svcs Policies & Procs I	CLASS	TR	1130	1250	4132		3	30	TBA
SOC	121	BCV	70972	Soc Svcs Policies & Procs I	VILC	M	1840	2120	(blank)		3	30	TBA
SOC	121	OL1	71678	Soc Svcs Policies & Procs I	ONLNE		(blank)	(blank)	(blank)		3	24	TBA
SOC	153	OAC	38085	Alc. & Subs. Abuse Prev.& Edu.	CLASS	MW	1715	1835	4131		3	30	TBA
SOC	201	S1V	70718	Social Gerontology	VILC	MW	1000	1120	(blank)		3	10	TBA
SOC	203	001	71664	Racial and Cultural Minorities	CLASS	TR	1300	1420	4132		3	30	TBA
SOC	206	01V	70721	Social Stratification	VILC	TR	1130	1250	(blank)		3	15	TBA
SOC	207	ACV	70974	Understanding Death & Dying	VILC	MW	1130	1250	(blank)		3	30	TBA
SOC	207	BCV	71441	Understanding Death & Dying	VILC	M	1840	2120	(blank)		3	30	TBA
SOC	230	001	31592	Hum & Soc Svcs Fieldwork II	CLASS		(blank)	(blank)	(blank)		3	15	TBA
SOC	230	002	71140	Hum & Soc Svcs Fieldwork II	CLASS		(blank)	(blank)	(blank)		3	15	TBA
SOC	230	003	71679	Hum & Soc Svcs Fieldwork II	CLASS		(blank)	(blank)	(blank)		3	15	TBA
SOC	231	001	38477	Hum & Soc Svcs Internship II	CLASS	MW	1300	1420	4131		3	15	TBA
SOC	231	ACV	71680	Hum & Soc Svcs Internship II	VILC	T	1840	2120	(blank)		3	15	TBA
SOC	231	BCV	71141	Hum & Soc Svcs Internship II	VILC	W	1840	2120	(blank)		3	15	TBA
SOC	250	OAC	70975	Alc & Drug Abuse in Amer. Soc.	CLASS	T	1840	2120	4131		3	27	TBA
SOC	252	OAV	71400	Case Mngmt of the Addictions	VILC	M	1840	2120	(blank)		3	24	TBA
SPN	101	001	71361	Elementary Spanish I	CLASS	TR	0830	0950	2110		3	30	TBA
SPN	101	002	71618	Elementary Spanish I	CLASS	TR	1130	1250	2108		3	30	TBA
SPN	101	ACV	71360	Elementary Spanish I	VILC	MW	1715	1835	(blank)		3	30	TBA
SPN	101	OL1	71363	Elementary Spanish I	ONLNE		(blank)	(blank)	(blank)		3	24	TBA
SPN	102	OL1	71364	Elementary Spanish II	ONLNE		(blank)	(blank)	(blank)		3	30	TBA





2024 SPRING I SCHEDULE

WEST ESSEX CAMPUS

ESSEX COUNTY COLLEGE
730 BLOOMFIELD AVENUE
WEST CALDWELL, NJ
(973) 877-3175

SPRING SESSION I 2024 (202403) - WEST ESSEX CAMPUS
JANUARY 10, 2024 - APRIL 27, 2024

SUBJ	CRSE	SEC	CRN	CRSE_TITLE	INSM	DAYS	BEGIN	END	ROOM	CREDIT_HRS	LIMIT	STAFF
ACC	101	CW1	71704	Prin of Accounting I Financial	CLASS	MWF	1000	1115	108	4	30	TBA
ACC	101	CWH	71707	Prin of Accounting I Financial	HYBRD	W	1715	1900	(blank)	4	30	TBA
ACC	101	CWH				M	1715	1900	202	4	30	TBA
ACC	102	CW1	71705	Prin Accounting II Managerial	CLASS	MWF	1130	1245	104	4	30	TBA
ACC	102	CWH	71708	Prin Accounting II Managerial	HYBRD	W	1715	1900	202	4	30	TBA
ACC	102	CWH				M	1715	1900	(blank)	4	30	TBA
ART	101	CW1	71651	Art History I	CLASS	MW	1130	1250	106	3	30	TBA
ART	102	CW1	71652	Art History II	CLASS	TR	1130	1250	206	3	30	TBA
BIO	101	CW1	70961	College Biology I	CLASS	W	0830	1120	126	4	24	TBA
BIO	101	CW1				M	0830	1120	104	4	24	TBA
BIO	101	CWH	37666	College Biology I	HYBRD	R	1840	2120	(blank)	4	24	TBA
BIO	101	CWH				T	1840	2120	128	4	24	TBA
BIO	121	CW1	34519	Anatomy & Physiology I	HYBRD	W	0830	1120	203	4	24	TBA
BIO	121	CW1				M	0830	1120	126	4	24	TBA
BIO	122	CW1	32895	Anatomy and Physiology II	CLASS	W	1130	1420	105	4	24	TBA
BIO	122	CW1				M	1130	1420	126	4	24	TBA
BIO	122	CWC	31638	Anatomy and Physiology II	CLASS	W	1820	2100	126	4	24	TBA
BIO	122	CWC				M	1820	2100	104	4	24	TBA
BUS	101	CW1	71721	Business Organization & Mgmt	CLASS	MW	0830	0950	105	3	27	TBA
BUS	101	CW2	71754	Business Organization & Mgmt	CLASS	TR	0830	0950	104	3	27	TBA
BUS	101	CWC	71722	Business Organization & Mgmt	CLASS	T	1840	2120	203	3	27	TBA
BUS	201	CW1	71723	Principles of Management	CLASS	MW	1300	1420	108	3	27	TBA
BUS	201	CWC	71724	Principles of Management	CLASS	R	1840	2120	106	3	27	TBA
BUS	203	CWC	71794	Intro. to Entrepreneurship	CLASS	TR	1715	1835	218	3	24	TBA
BUS	204	CW1	71755	Intro to Org Behavior in Bus	CLASS	MW	1425	1545	106	3	27	TBA

BUS	211	CW1	71726	Principles of Marketing	CLASS	TR	1300	1420	108	3	27	TBA
BUS	231	CWC	71727	Global Business I	CLASS	M	1840	2120	106	3	27	TBA
BUS	251	CWC	71725	Business Law I	CLASS	W	1840	2120	203	3	27	TBA
CHM	101	CW1	71761	College Chemistry I	CLASS	W	1000	1250	128	4	24	TBA
CHM	101	CW1				M	1000	1250	220	4	24	TBA
CJI	121	CWV	36398	Introduction to Corrections	VILC	TR	1130	1250	(blank)	3	30	TBA
CJI	136	CWV	36399	Criminology	VILC	TR	0830	0950	(blank)	3	30	TBA
CSC	104	CWC	71805	Microcomputer Fundamentals	CLASS	TR	1715	1835	131	3	27	TBA
CSC	104	CWC		Network Fundamentals	CLASS	TR	1715	1835	131	3	27	TBA
ECO	101	CW1	71728	Principles of Economics I	CLASS	MW	1130	1250	108	3	27	TBA
ECO	101	CWC	71807	Principles of Economics I	CLASS	R	1840	2120	104	3	24	TBA
ECO	102	CW1	71729	Principles of Economics II	CLASS	TR	1130	1250	106	3	27	TBA
EDU	205	CWV	70726	Early Childhood Education	VILC	TR	1000	1120	(blank)	3	24	TBA
ENG	101	CW1	71647	College Composition I	CLASS	MW	1425	1545	204	3	30	TBA
ENG	099	DW1	71645	Composition Skills Support	CLASS	M	1000	1120	107	1.5	30	TBA
				Register for all of the above sections								
ENG	101	DW1	71646	College Composition I	CLASS	TR	1000	1120	107	3	30	TBA
ENG	102	CW1	71648	College Composition II	CLASS	MW	1300	1420	204	3	30	TBA
ENG	102	CW2	71649	College Composition II	CLASS	TR	1300	1420	204	3	30	TBA
ENG	102	CWC	34669	College Composition II	CLASS	W	1840	2120	105	3	30	TBA
ENG	208	CWC	71650	Shakespeare	CLASS	R	1840	2120	204	3	30	TBA
ENG	208	CWC		Survey of Shakespearean Lit.	CLASS	R	1840	2120	204	3	30	TBA
FIN	101	CW1	71718	Introduction to Finance	CLASS	TR	1000	1120	105	3	27	TBA
FIN	101	CWB	71730	Introduction to Finance	CLASS	M	1840	2120	107	3	27	TBA
FIN	101	CWC	71719	Introduction to Finance	CLASS	MW	1715	1835	105	3	27	TBA
FYE	097	CW1	71709	First Year Experience	CLASS	MW	0830	0925	224	2	24	TBA
FYE	097	CW2	71710	First Year Experience	CLASS	TR	1000	1055	224	2	24	TBA
FYE	097	CW3	71711	First Year Experience	CLASS	MW	1000	1055	224	2	24	TBA
FYE	097	CW4	71756	First Year Experience	CLASS	MW	1130	1225	131	2	24	TBA

FYE	097	CW5	71757	First Year Experience	CLASS	TR	1130	1225	132	2	24	TBA
FYE	097	CW6	71758	First Year Experience	CLASS	MW	1330	1425	131	2	24	TBA
FYE	097	CW7	71759	First Year Experience	CLASS	TR	1330	1425	132	2	24	TBA
FYE	097	CW8	71760	First Year Experience	CLASS	S	1000	1150	131	2	24	TBA
FYE	097	CWA	71715	First Year Experience	CLASS	TR	1840	1935	224	2	24	TBA
FYE	097	CWB	71716	First Year Experience	CLASS	MW	1715	1810	224	2	24	TBA
HSC	109	CWV	38018	Medical Terminology	VILC	R	1930	2210	(blank)	3	24	TBA
HST	101	CWC	71644	World Civilization	CLASS	T	1840	2120	(blank)	3	30	TBA
HST	101	CWC		World Civilization I	CLASS	T	1840	2120	(blank)	3	30	TBA
HST	111	CW1	71642	United States History I	CLASS	MW	0830	0950	107	3	30	TBA
HST	112	CW1	71643	United States History II	CLASS	TR	0830	0950	205	3	30	TBA
MTH	086	CW1	71732	Applied Introductory Algebra	CLASS	MWF	1130	1250	204	4.5	27	TBA
MTH	086	CW1		Introductory Algebra	CLASS	MWF	1130	1250	204	4.5	27	TBA
MTH	086T	CW1	71735	Tutorial	CLASS	F	1300	1420	225	1	27	TBA
				Register for all of the above sections								
MTH	086	CW2	71734	Applied Introductory Algebra	CLASS	TRF	0830	0950	202	4.5	27	TBA
MTH	086	CW2		Introductory Algebra	CLASS	TRF	0830	0950	202	4.5	27	TBA
MTH	086T	CW2	71736	Tutorial	CLASS	F	1000	1120	225	1	27	TBA
				Register for all of the above sections								
MTH	086	CWC	71733	Applied Introductory Algebra	CLASS	MW	1925	2130	218	4.5	27	TBA
MTH	086	CWC		Introductory Algebra	CLASS	MW	1925	2130	218	4.5	27	TBA
MTH	086T	CWC	71737	Tutorial	CLASS	F	1715	1835	225	1	27	TBA
				Register for all of the above sections								
MTH	092	CW1	71738	Applied Elementary Algebra	CLASS	MWF	0830	0950	218	4.5	27	TBA
MTH	092	CW1		Elementary Algebra	CLASS	MWF	0830	0950	218	4.5	27	TBA
MTH	092T	CW1	71739	Tutorial	CLASS	F	1000	1120	224	1	27	TBA
				Register for all of the above sections								
MTH	092	CW2	71740	Applied Elementary Algebra	CLASS	TRF	1000	1120	205	4.5	27	TBA
MTH	092	CW2		Elementary Algebra	CLASS	TRF	1000	1120	205	4.5	27	TBA
MTH	092T	CW2	71741	Tutorial	CLASS	F	1130	1250	225	1	27	TBA
				Register for all of the above sections								
MTH	092	CWC	71742	Applied Elementary Algebra	CLASS	MW	1715	1920	206	4.5	27	TBA
MTH	092	CWC		Elementary Algebra	CLASS	MW	1715	1920	206	4.5	27	TBA
MTH	092T	CWC	71743	Tutorial	CLASS	F	1715	1835	224	1	27	TBA
				Register for all of the above sections								

MTH	100	CW1	71744	Intro. to College Mathematics	CLASS	MWF	0830	0950	106	4	27	TBA
MTH	100	CWC	71401	Intro. to College Mathematics	CLASS	TR	1715	1900	107	4	27	TBA
MTH	101	CW1	71745	Statistics and Probability I	CLASS	TRF	0830	0950	204	4	27	TBA
MTH	101	CWC	71746	Statistics and Probability I	CLASS	MW	1715	1900	205	4	27	TBA
MTH	103	CW1	71747	Fund Concepts Modern Math I	CLASS	MWF	1000	1120	106	4	27	TBA
MTH	103	CWC	71748	Fund Concepts Modern Math I	CLASS	TR	1715	1900	205	4	27	TBA
PLS	101	CWV	71660	Intro. to Law for Paralegals	VILC	T	1000	1250	(blank)	3	20	TBA
PSY	101	CW1	31808	General Psychology I	CLASS	MW	1130	1250	205	3	30	TBA
PSY	101	CWC	70230	General Psychology I	CLASS	T	1820	2120	106	3	30	TBA
PSY	102	W1V	70231	General Psychology II	VILC	TR	1000	1120	(blank)	3	30	TBA
PSY	209	CW1	31813	Abnormal Psychology	CLASS	M	1000	1240	218	3	30	TBA
PSY	219	W1V	70127	Child Psychology and Develop.	VILC	TR	1300	1420	(blank)	3	30	TBA
PSY	230	CWC	39918	Life-Span Developmental Psy.	CLASS	R	1840	2120	108	3	24	TBA
PSY	232	CW1	38505	Human Sexuality	CLASS	MW	1425	1545	(blank)	3	30	TBA
SCM	101	CWC	71731	Intro. to Operations and SCM	CLASS	M	1840	2120	108	3	27	TBA
SCM	101	CWC		Supply Chain Mngmt. Principles	CLASS	M	1840	2120	108	3	27	TBA
SOC	101	CW1	31831	Introduction to Sociology	CLASS	TR	1300	1420	206	3	30	TBA
SOC	108	CW1	71187	Social Problems	CLASS	MW	1000	1120	205	3	30	TBA
SOC	111	003	71676	Helper Theory	CLASS	MW	1600	1720	(blank)	3	24	TBA
UCC	110	CWV	71762	Construction Official	VILC	T	1800	2100	(blank)	3	27	TBA
UCC	121	CWV	71402	Building Inspector ICS	VILC	W	1730	2045	(blank)	6	24	TBA
UCC	121	CWV				M	1730	2030	(blank)	6	24	TBA
UCC	130	CWV	71763	Electrical Inspector ICS	VILC	W	1730	2115	(blank)	4	24	TBA
UCC	141	CWV	71764	Fire Protection Inspector II	VILC	W	1730	2115	(blank)	4	24	TBA
UCC	170	CWV	71403	Technical Assistant	VILC	M	1730	2100	(blank)	3	24	TBA
SOC	101	L1V	34125	Introduction to Sociology	VILC	FS	1300	1500	(blank)	3	30	TBA





2024 SPRING II SCHEDULE

MAIN CAMPUS

ESSEX COUNTY COLLEGE
303 UNIVERSITY AVENUE
NEWARK, NJ 07102
(973) 877-3100

SPRING SESSION II 2024 (202403) - MAIN CAMPUS
FEBRUARY 12, 2024 - APRIL 24, 2024

SUBJ	CRSE	SEC	CRN	CRSE_TITLE	INSM	DAYS	BEGIN	END	ROOM	CREDIT_HRS	LIMIT	STAFF
ART	100	LV1	39241	Art Appreciation	VILC	TR	1040	1240	(blank)	3	30	TBA
ART	101	LV1	71641	Art History I	VILC	TR	1300	1500	(blank)	3	30	TBA
ART	102	LS1	30037	Art History II	CLASS	MW	1300	1500	4142	3	30	TBA
BIO	101	LS1	38304	College Biology I	CLASS	W	0830	1240	3426	4	24	TBA
BIO	101	LS1				M	0830	1240	3413	4	24	TBA
BIO	101	LS2	70936	College Biology I	CLASS	R	0830	1240	3425	4	24	TBA
BIO	101	LS2				T	0830	1240	3426	4	24	TBA
BIO	121	LS1	71559	Anatomy & Physiology I	CLASS	R	1715	2125	3432	4	24	TBA
BIO	121	LS1				T	1715	2125	3429	4	24	TBA
BIO	121	LS2	71568	Anatomy & Physiology I	CLASS	W	0830	1240	3429	4	24	TBA
BIO	121	LS2				M	0830	1240	3456	4	24	TBA
BIO	121	LS3	71570	Anatomy & Physiology I	CLASS	W	1715	2125	3456	4	24	TBA
BIO	121	LS3				M	1715	2125	3433	4	24	TBA
BIO	220	IS1	71312	Intro to Environmental Science	CLASS		(blank)	(blank)	(blank)	4	5	TBA
BUS	101	LS1	71556	Business Organization & Mgmt	CLASS	MW	1040	1240	4142	3	27	TBA
BUS	101	LSA	34116	Business Organization & Mgmt	CLASS	TR	1720	1920	4142	3	30	TBA
BUS	101	OM1	71542	Business Organization & Mgmt	ONLNE		(blank)	(blank)	(blank)	3	30	TBA
BUS	101	S1V	36337	Business Organization & Mgmt	VILC	MW	0830	1030	(blank)	3	30	TBA
BUS	201	OM3	71267	Principles of Management	ONLNE		(blank)	(blank)	(blank)	3	30	TBA
BUS	207	OM1	70166	Leadership & Supervision	ONLNE		(blank)	(blank)	(blank)	3	30	TBA
BUS	251	LS1	71543	Business Law I	CLASS	TR	1040	1240	4140	3	27	TBA
CHM	101	LS1	71289	College Chemistry I	CLASS	R	0830	1240	3433	4	24	TBA
CHM	101	LS1				T	0830	1240	3428	4	24	TBA
CIN	101	OM1	71530	Intro to the Art of Film II	ONLNE		(blank)	(blank)	(blank)	3	30	TBA
CIN	101	OM1		Intro. to the Art of Film	ONLNE		(blank)	(blank)	(blank)	3	30	TBA

CIS	131	OM1	71404	Micro Computers in Business	ONLNE		(blank)	(blank)	(blank)	3	30	TBA
CIS	131	OM2	71540	Micro Computers in Business	ONLNE		(blank)	(blank)	(blank)	3	30	TBA
CJI	101	LS1	71538	Intro to Criminal Justice	CLASS	S	0830	1230	4140	3	27	TBA
ECO	101	L1V	34284	Principles of Economics I	VILC	MW	1300	1500	(blank)	3	30	TBA
ECO	101	OM1	71561	Principles of Economics I	ONLNE		(blank)	(blank)	(blank)	3	30	TBA
ECO	102	LSA	70393	Principles of Economics II	CLASS	MW	1930	2130	4142	3	30	TBA
ENG	101	1VD	71533	College Composition I	VILC	MW	1720	1920	(blank)	3	30	TBA
ENG	099	1VD	71532	Composition Skills Support	VILC	F	1720	1920	(blank)	1.5	30	TBA
				Register for all of the above sections								
ENG	101	2VD	71535	College Composition I	VILC	TR	1720	1920	(blank)	3	30	TBA
ENG	099	2VD	71534	Composition Skills Support	VILC	M	1720	1920	(blank)	1.5	30	TBA
				Register for all of the above sections								
ENG	101	DL1	71121	College Composition I	CLASS	MW	1040	1240	4139	3	30	TBA
ENG	099	DL1	71120	Composition Skills Support	CLASS	F	1040	1240	4142	1.5	30	TBA
				Register for all of the above sections								
ENG	101	DL3	71129	College Composition I	CLASS	TR	1040	1240	4142	3	30	TBA
ENG	099	DL3	71128	Composition Skills Support	CLASS	M	1040	1240	(blank)	1.5	30	TBA
				Register for all of the above sections								
ENG	101	OM1	71123	College Composition I	ONLNE		(blank)	(blank)	(blank)	3	30	TBA
ENG	101	OM2	71127	College Composition I	ONLNE		(blank)	(blank)	(blank)	3	30	TBA
ENG	102	OM1	39706	College Composition II	ONLNE		(blank)	(blank)	(blank)	3	30	TBA
ENG	102	OM2	71270	College Composition II	ONLNE		(blank)	(blank)	(blank)	3	30	TBA
ENG	102	OM3	71541	College Composition II	ONLNE		(blank)	(blank)	(blank)	3	30	TBA
ENG	109	OM1	71424	Effective Speech	ONLNE		(blank)	(blank)	(blank)	3	30	TBA
ENG	208	OM1	71322	Shakespeare	ONLNE		(blank)	(blank)	(blank)	3	30	TBA
ENG	208	OM1		Survey of Shakespearean Lit.	ONLNE		(blank)	(blank)	(blank)	3	30	TBA
ENG	215	OM1	71344	Modern Literary Masterpieces	ONLNE		(blank)	(blank)	(blank)	3	30	TBA
ENG	215	OM1		World Literature II	ONLNE		(blank)	(blank)	(blank)	3	30	TBA
ENG	221	OM1	71271	American Literature I	ONLNE		(blank)	(blank)	(blank)	3	30	TBA
FYE	097	LS1	71552	First Year Experience	CLASS	TR	1040	1200	(blank)	2	24	TBA
FYE	097	LS2	71555	First Year Experience	CLASS	TR	0830	0950	4156	2	24	TBA

FYE	097	LSA	71134	First Year Experience	CLASS	MW	1715	1825	4156	2	24	TBA
FYE	097	LSV	71554	First Year Experience	VILC	TR	1930	2050	(blank)	2	24	TBA
FYE	097	LV1	71551	First Year Experience	VILC	MW	0830	0950	(blank)	2	24	TBA
FYE	097	LV2	71553	First Year Experience	VILC	MW	1300	1420	(blank)	2	24	TBA
FYE	097	LV3	71566	First Year Experience	VILC	MW	1040	1200	(blank)	2	24	TBA
HSC	109	LS1	71548	Medical Terminology	CLASS	R	1130	1330	3436	3	24	TBA
HSC	109	LS1				T	1130	1330	(blank)	3	24	TBA
HST	102	OM2	71321	World Civilization II	ONLNE		(blank)	(blank)	(blank)	3	30	TBA
HST	122	LV1	71639	African American History II	VILC	TR	1720	1920	(blank)	3	30	TBA
HST	122	LV1		Afro-American History II	VILC	TR	1720	1920	(blank)	3	30	TBA
HST	132	OM1	71345	Latin American History II	ONLNE		(blank)	(blank)	(blank)	3	30	TBA
HST	162	OM1	71640	Modern European History II	ONLNE		(blank)	(blank)	(blank)	3	30	TBA
HST	206	LS1	71638	Hist. of American Immigration	CLASS	TR	1300	1500	4141	3	30	TBA
MTH	086	LS1	37877	Applied Introductory Algebra	CLASS	MWF	0830	1030	4142	4.5	24	TBA
MTH	086	LS1		Introductory Algebra	CLASS	MWF	0830	1030	4142	4.5	24	TBA
MTH	086T	LS1	37878	Tutorial	CLASS	M	1040	1240	3234B	1	24	TBA
				Register for all of the above sections								
MTH	086	LS2	38797	Applied Introductory Algebra	CLASS	MTR	0830	1030	4141	4.5	24	TBA
MTH	086	LS2		Introductory Algebra	CLASS	MTR	0830	1030	4141	4.5	24	TBA
MTH	086T	LS2	38344	Tutorial	CLASS	T	1040	1240	3234B	1	24	TBA
				Register for all of the above sections								
MTH	086	LSA	35223	Applied Introductory Algebra	CLASS	TR	1720	2020	4141	4.5	24	TBA
MTH	086	LSA		Introductory Algebra	CLASS	TR	1720	2020	4141	4.5	24	TBA
MTH	086T	LSA	35224	Tutorial	CLASS	M	1720	1920	3234B	1	24	TBA
				Register for all of the above sections								
MTH	092	LS1	70056	Applied Elementary Algebra	CLASS	MWF	1040	1240	4141	4.5	24	TBA
MTH	092	LS1		Elementary Algebra	CLASS	MWF	1040	1240	4141	4.5	24	TBA
MTH	092T	LS1	37111	Tutorial	CLASS	W	1300	1500	3234B	1	24	TBA
				Register for all of the above sections								
MTH	092	LS2	37110	Applied Elementary Algebra	CLASS	MWF	1310	1510	4140	4.5	24	TBA
MTH	092	LS2		Elementary Algebra	CLASS	MWF	1310	1510	4140	4.5	24	TBA
MTH	092T	LS2	37914	Tutorial	CLASS	W	1515	1715	3234B	1	24	TBA
				Register for all of the above sections								
MTH	092	LSA	36519	Applied Elementary Algebra	CLASS	MW	1720	2020	4141	4.5	24	TBA
MTH	092	LSA		Elementary Algebra	CLASS	MW	1720	2020	4141	4.5	24	TBA
MTH	092T	LSA	36520	Tutorial	CLASS	T	1720	1920	3234B	1	24	TBA

				Register for all of the above sections									
MTH	100	LS1	38808	Intro. to College Mathematics	CLASS	MWF	0830	1020	4140		4	30	TBA
MTH	100	LS2	38342	Intro. to College Mathematics	CLASS	TRF	1040	1230	4139		4	30	TBA
MTH	100	LS3	71305	Intro. to College Mathematics	CLASS	MWF	1040	1240	4140		4	30	TBA
MTH	100	LS4	70769	Intro. to College Mathematics	CLASS	MWF	1510	1700	4141		4	30	TBA
MTH	100	LSA	70770	Intro. to College Mathematics	CLASS	TR	1720	2000	4140		4	30	TBA
MTH	101	LSA	36450	Statistics and Probability I	CLASS	TR	1720	2000	(blank)		4	30	TBA
MTH	101	OM1	70771	Statistics and Probability I	ONLNE		(blank)	(blank)	(blank)		4	30	TBA
MTH	103	OM1	70772	Fund Concepts Modern Math I	ONLNE		(blank)	(blank)	(blank)		4	24	TBA
MUS	109	OM1	71637	Appreciation Jazz	ONLNE		(blank)	(blank)	(blank)		3	30	TBA
MUS	109	OM1		Appreciation of Jazz	ONLNE		(blank)	(blank)	(blank)		3	30	TBA
MUS	109	OM1		Jazz Appreciation	ONLNE		(blank)	(blank)	(blank)		3	30	TBA
PLS	203	IS1	71567	Wills & Estate Administration	CLASS		(blank)	(blank)	(blank)		3	1	TBA
PSY	101	L1V	34124	General Psychology I	VILC	FS	1510	1710	(blank)		3	32	TBA
PSY	101	LS2	34619	General Psychology I	CLASS	S	0830	1230	4141		3	30	TBA
PSY	101	OM1	39248	General Psychology I	ONLNE		(blank)	(blank)	(blank)		3	24	TBA
PSY	101	OM2	70543	General Psychology I	ONLNE		(blank)	(blank)	(blank)		3	24	TBA
PSY	219	L1V	34621	Child Psychology and Develop.	VILC	F	0830	1230	(blank)		3	30	TBA
SCM	201	IS1	71463	Principles Supply Chain Mgmt.	CLASS		(blank)	(blank)	(blank)		3	3	TBA
SOC	101	L2V	34118	Introduction to Sociology	VILC	S	1300	1700	(blank)		3	30	TBA
SOC	101	LS2	37138	Introduction to Sociology	CLASS	S	0830	1230	4142		3	30	TBA
SOC	101	OM1	70541	Introduction to Sociology	ONLNE		(blank)	(blank)	(blank)		3	24	TBA
UCC	130	CWC	71547	Electrical Inspector ICS	VILC	W	1730	2130	(blank)		4	24	TBA
UCC	130	CWC				M	1730	2115	(blank)		4	24	TBA
ACC	102	HSW	71778	Prin Accounting II Managerial	CLASS	TF	1530	1730	4134		4	15	TBA
BIO	102	HS4	71808	College Biology II	CLASS	MW	1345	1545	(blank)		4	25	TBA
BIO	102	HS6	71786	College Biology II	CLASS	TR	1345	1545	4138		4	25	TBA
BIO	102	HS9	71775	College Biology II	CLASS	TR	1345	1505	4162		4	25	TBA

BIO	102	HSO	71751	College Biology II	CLASS	TR	1300	1500	4139	4	15	TBA
BUS	201	HSW	71780	Principles of Management	CLASS	TR	1400	1520	(blank)	3	27	TBA
BUS	211	HSW	71776	Principles of Marketing	CLASS	MR	1400	1520	4134	3	15	TBA
BUS	251	HSO	71767	Business Law I	CLASS	MTW	1100	1250	(blank)	3	20	TBA
BUS	251	HS1	71768	Business Law I	CLASS	MTW	0800	0930	(blank)	3	20	TBA
BUS	251	HS2	71769	Business Law I	CLASS	MTW	0935	1100	(blank)	3	20	TBA
CIN	101	HS8	71814	Intro to the Art of Film II	CLASS	MW	1500	1620	(blank)	3	25	TBA
CIN	101	HS8		Intro. to the Art of Film	CLASS	MW	1500	1620	(blank)	3	25	TBA
CIS	131	HSW	71749	Micro Computers in Business	CLASS	MR	1530	1650	4134	3	20	TBA
CIS	139	HSP	71818	Introduction to Multimedia	CLASS	MTWR	1000	1120	(blank)	3	20	TBA
CIS	139	HSP		MicroComp. Integrated Software	CLASS	MTWR	1000	1120	(blank)	3	20	TBA
CIS	153	HSO	71820	Adv. Internet Concepts/Applic.	CLASS	MTWR	1330	1450	(blank)	3	20	TBA
CIS	153	HSP	71819	Adv. Internet Concepts/Applic.	CLASS	MTWR	1200	1320	(blank)	3	20	TBA
CMS	110	HSO	71771	Fundamentals of TV Production	CLASS	MTWR	0800	0905	(blank)	3	15	TBA
CMS	110	HS1	71772	Fundamentals of TV Production	CLASS	MTWR	0915	1020	(blank)	3	15	TBA
ECO	101	HSW	71781	Principles of Economics I	CLASS	MF	1400	1520	(blank)	3	27	TBA
ECO	102	HSW	71777	Principles of Economics II	CLASS	TF	1400	1520	4134	3	15	TBA
ENG	101	HS2	71817	College Composition I	CLASS	MW	1157	1218	(blank)	3	25	TBA
ENG	102	HS7	71789	College Composition II	CLASS	TR	1320	1440	(blank)	3	25	TBA
ENG	102	HS8	71790	College Composition II	CLASS	TR	1157	1318	(blank)	3	25	TBA
ENG	102	HSW	71779	College Composition II	CLASS	TR	1235	1400	(blank)	3	27	TBA
ENG	205	HS5	71784	Western Literary Tradition	CLASS	MW	1345	1505	4158	3	25	TBA
ENG	205	HS5		World Literature I	CLASS	MW	1345	1505	4158	3	25	TBA
ENG	205	HSU	71798	Western Literary Tradition	CLASS	MW	0815	0945	(blank)	3	25	TBA
ENG	205	HSU		World Literature I	CLASS	MW	0815	0945	(blank)	3	25	TBA
ENG	215	HS4	71787	Modern Literary Masterpieces	CLASS	MW	1220	1340	4159	3	25	TBA
ENG	215	HS4		World Literature II	CLASS	MW	1220	1340	4159	3	25	TBA
ENG	215	HS6	71785	Modern Literary Masterpieces	CLASS	MW	1220	1340	4138	3	25	TBA
ENG	215	HS6		World Literature II	CLASS	MW	1220	1340	4138	3	25	TBA

ENG	215	HS9	71788	Modern Literary Masterpieces	CLASS	MW	1345	1505	4162	3	25	TBA
ENG	215	HS9		World Literature II	CLASS	MW	1345	1505	4162	3	25	TBA
HST	102	HS2	71815	World Civilization II	CLASS	MW	1500	1620	(blank)	3	25	TBA
HST	102	HS7	71812	World Civilization II	CLASS	MW	1320	1440	(blank)	3	25	TBA
HST	102	HS8	71813	World Civilization II	CLASS	MW	1157	1318	(blank)	3	25	TBA
HST	102	HSU	71801	World Civilization II	VILC	MW	1445	1605	(blank)	3	20	TBA
MTH	100	HS7	71811	Intro. to College Mathematics	CLASS	MW	1500	1700	(blank)	4	25	TBA
MTH	100	HSO	71750	Intro. to College Mathematics	CLASS	MW	1300	1500	4139	4	20	TBA
POL	104	HS0	71770	American Government	CLASS	MW	0930	1100	(blank)	3	7	TBA
POL	104	HSU	71799	American Government	CLASS	TR	0815	0945	(blank)	3	25	TBA
PSY	101	HS5	71773	General Psychology I	CLASS	MW	1220	1340	4158	3	25	TBA
PSY	101	HS6	71774	General Psychology I	CLASS	MW	1345	1505	4138	3	25	TBA
SOC	101	HS7	71791	Introduction to Sociology	CLASS	TR	1157	1318	(blank)	3	25	TBA
SOC	101	HS8	71792	Introduction to Sociology	CLASS	TR	1320	1440	(blank)	3	25	TBA
SOC	108	HSO	71821	Social Problems	CLASS	TR	1320	1440	(blank)	3	20	TBA
SOC	108	HST	71803	Social Problems	CLASS	MW	1320	1440	(blank)	3	20	TBA
SOC	108	HSU	71802	Social Problems	CLASS	TR	1400	1605	(blank)	3	20	TBA
SPN	101	HS4	71809	Elementary Spanish I	CLASS	TR	1345	1505	(blank)	3	25	TBA
SPN	101	HS5	71782	Elementary Spanish I	CLASS	TR	1345	1505	4158	3	25	TBA
SPN	101	HS6	71783	Elementary Spanish I	CLASS	TR	1220	1340	4138	3	25	TBA
SPN	101	HS9	71810	Elementary Spanish I	CLASS	TR	1220	1340	(blank)	3	25	TBA
SPN	102	HS2	71816	Elementary Spanish II	CLASS	TR	1500	1620	(blank)	3	25	TBA
SPN	102	HSU	71800	Elementary Spanish II	VILC	MW	1400	1530	(blank)	3	5	TBA
LPN	102	001	71425	Adult Health I	CLASS	T	0830	1150	(blank)	8	40	TBA
LPN	102	CL1	71426	Adult Health I	CLASS	W	0700	2000	AGENC	0	10	TBA
LPN	102	CL2	71427	Adult Health I	CLASS	W	0700	2000	AGENC	0	10	TBA

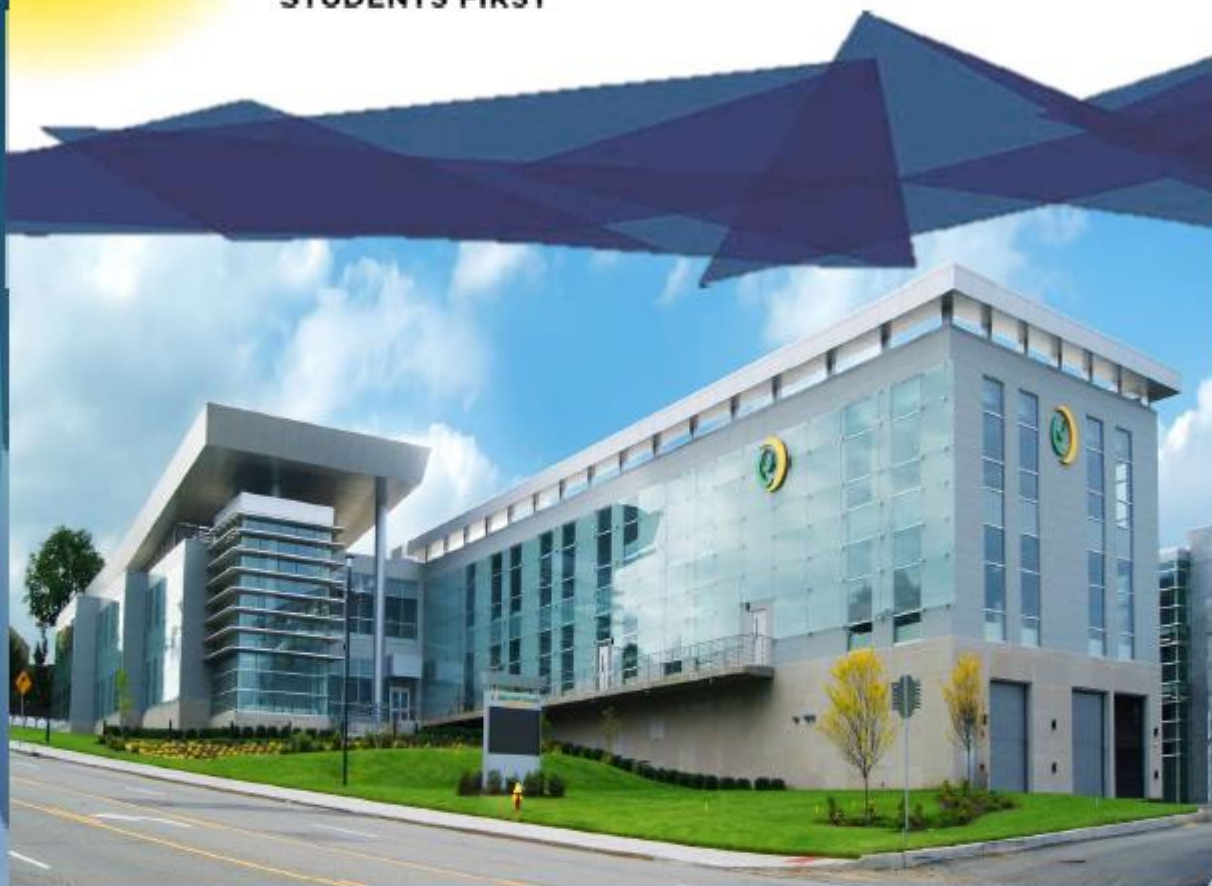

2024 SPRING II SCHEDULE

WEST ESSEX CAMPUS

ESSEX COUNTY COLLEGE
730 BLOOMFIELD AVENUE
WEST CALDWELL, NJ
(973) 877-3175

SPRING SESSION II 2024 (202403) - WEST ESSEX CAMPUS
FEBRUARY 12, 2024 - APRIL 24, 2024

SUBJ	CRSE	SEC	CRN	CRSE_TITLE	INSM	DAYS	BEGIN	END	ROOM	CREDIT_HRS	LIMIT	STAFF
SOC	101	L1V	34125	Introduction to Sociolog	VILC	FS	1300	1500	(blank)	3	30	TBA

Page 1





2024 SPRING WEEKEND COLLEGE SCHEDULE MAIN CAMPUS

SPRING SESSION I WEEKEND COLLEGE 2024 (202403) - MAIN CAMPUS
JANUARY 10, 2024 - APRIL 27, 2024

Page 1

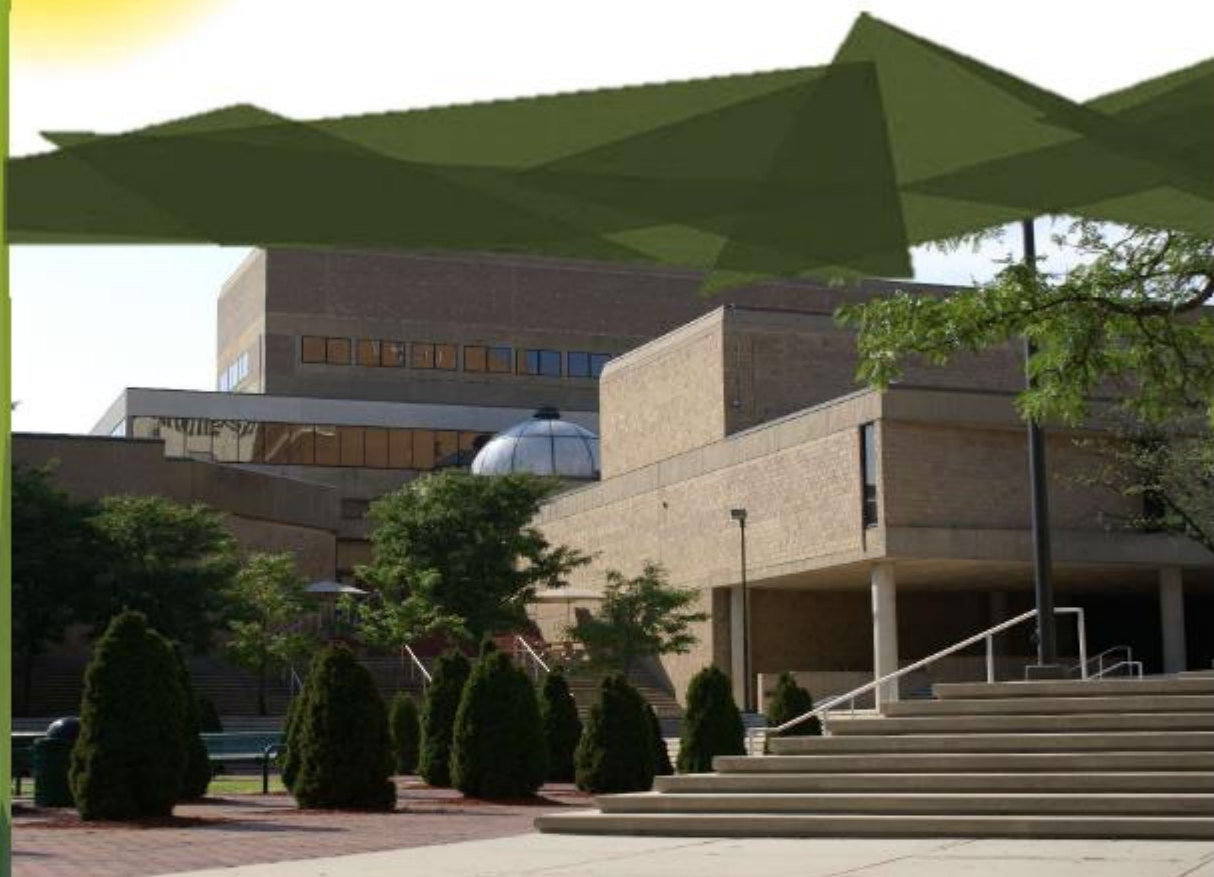

2024 SPRING F.O.C.U.S. SCHEDULE

MAIN CAMPUS

SPRING SESSION F.O.C.U.S. 2024 (202403) - MAIN CAMPUS
JANUARY 31, 2024 - APRIL 24, 2024

Comp/Speak	CLASS	MW	1800
g. & Writing	CLASS	TR	1800

